

**SECTION 18, TOWNSHIP 7N, RANGE 21E
WAUWATOSA, MILWAUKEE COUNTY, WI**

Kimley»Horn
2023 KIMLEY-HORN AND ASSOCIATES, INC.
767 EUSTIS STREET, SUITE 100, ST. PAUL, MN 55114
PHONE 651-645-4197
WWW.KIMLEY-HORN.COM

[illegible]

GENERAL CONSTRUCTION NOTES

1. THE CONTRACTOR AND SUBCONTRACTORS SHALL OBTAIN A COPY OF THE LATEST EDITION OF THE STANDARD SPECIFICATIONS OF THE LOCAL JURISDICTION AND STATE DEPARTMENT OF TRANSPORTATION AND BECOME FAMILIAR WITH THE CONTENTS PRIOR TO COMMENCING WORK. UNLESS OTHERWISE NOTED, ALL WORK SHALL CONFORM AS APPLICABLE TO THESE STANDARDS AND SPECIFICATIONS.
3. PERFORM ALL WORK IN COMPLIANCE WITH APPLICABLE CITY REGULATIONS, STATE CODES, AND O.S.H.A. STANDARDS. THE CONTRACTOR IS RESPONSIBLE FOR FURNISHING THE NECESSARY MATERIALS & LABOR TO CONSTRUCT THE FACILITY AS SHOWN AND DESCRIBED IN THE CONSTRUCTION DOCUMENTS, AND IN ACCORDANCE WITH THE SPECIFICATIONS AND REQUIREMENTS OF THE APPROPRIATE APPROVING AUTHORITIES.
4. CONTRACTOR SHALL CLEAR AND GRUB ALL AREAS UNLESS OTHERWISE INDICATED, REMOVING TREES, STUMPS, ROOTS, MUCK, EXISTING PAVEMENT AND ALL OTHER DELETERIOUS MATERIAL.
5. THE EXISTING SUBSURFACE UTILITY INFORMATION IN THIS PLAN IS QUALITY LEVEL "D" UNLESS OTHERWISE NOTED. THIS QUALITY LEVEL WAS DETERMINED ACCORDING TO THE GUIDELINES OF CIACSE 38/02, ENTITLED STANDARD GUIDELINES FOR THE COLLECTION AND DEPICTION OF SUBSURFACE QUALITY DATA BY THE FHA. EXISTING UTILITIES SHOWN ARE LOCATED ACCORDING TO THE INFORMATION AVAILABLE TO THE ENGINEER AT THE TIME OF THE TOPOGRAPHIC SURVEY AND HAVE NOT BEEN INDEPENDENTLY VERIFIED BY THE OWNER OR THE ENGINEER. GUARANTEE IS NOT MADE THAT ALL EXISTING UNDERGROUND UTILITIES ARE SHOWN OR THAT THE LOCATION OF THOSE SHOWN ARE ENTIRELY ACCURATE. FINDING THE ACTUAL LOCATION OF ANY EXISTING UTILITIES IS THE CONTRACTOR'S RESPONSIBILITY AND SHALL BE DONE BEFORE COMMENCING ANY WORK IN THE VICINITY. FURTHERMORE, THE CONTRACTOR SHALL BE FULLY RESPONSIBLE FOR ANY AND ALL DAMAGES DUE TO THE CONTRACTOR'S FAILURE TO EXACTLY LOCATE AND PRESERVE ANY AND ALL UNDERGROUND UTILITIES. THE OWNER OR ENGINEER WILL ASSUME NO LIABILITY FOR ANY DAMAGES SUSTAINED OR COST INCURRED BECAUSE OF THE OPERATIONS IN THE VICINITY OF EXISTING UTILITIES OR STRUCTURES, NOR FOR TEMPORARY BRACING AND SHORING OF SAME. IF IT IS NECESSARY TO SHORE, BRACE, SWING OR RELOCATE A UTILITY, THE UTILITY COMPANY OR DEPARTMENT AFFECTED SHALL BE CONTACTED AND THEIR PERMISSION OBTAINED REGARDING THE METHOD TO USE FOR SUCH WORK.
6. IT IS THE CONTRACTOR'S RESPONSIBILITY TO CONTACT THE VARIOUS UTILITY COMPANIES WHICH MAY HAVE BURIED OR AERIAL UTILITIES WITHIN OR NEAR THE CONSTRUCTION AREA BEFORE COMMENCING WORK. THE CONTRACTOR SHALL PROVIDE 48 HOURS MINIMUM NOTICE TO ALL UTILITY COMPANIES PRIOR TO BEGINNING CONSTRUCTION.
7. THE CONTRACTOR SHALL BE RESPONSIBLE FOR OBTAINING ALL REQUIRED CONSTRUCTION PERMITS AND BONDS IF REQUIRED PRIOR TO CONSTRUCTION.
8. THE CONTRACTOR SHALL HAVE AVAILABLE AT THE JOB SITE AT ALL TIMES ONE COPY OF THE CONSTRUCTION DOCUMENTS INCLUDING PLANS, SPECIFICATIONS, GEOTECHNICAL REPORT AND SPECIAL CONDITIONS AND COPIES OF ANY REQUIRED CONSTRUCTION PERMITS.
9. ANY DISCREPANCIES ON THE DRAWINGS SHALL BE IMMEDIATELY BROUGHT TO THE ATTENTION OF THE OWNER AND ENGINEER BEFORE COMMENCING WORK. NO FIELD CHANGES OR DEVIATIONS FROM DESIGN ARE TO BE MADE WITHOUT PRIOR APPROVAL OF THE OWNER AND NOTIFICATION TO THE ENGINEER.
10. ALL COPIES OF COMPACTION, CONCRETE AND OTHER REQUIRED TEST RESULTS ARE TO BE SENT TO THE OWNER DIRECTLY FROM THE TESTING AGENCY.
11. THE CONTRACTOR SHALL BE RESPONSIBLE FOR DOCUMENTING AND MAINTAINING AS-BUILT INFORMATION. THE CONTRACTOR SHALL BE REGARDED AS CONSTRUCTION PROGRESSES OR AT THE COMPLETION OF APPROPRIATE CONSTRUCTION INTERVALS AND SHALL BE RESPONSIBLE FOR PROVIDING AS-BUILT DRAWINGS TO THE OWNER FOR THE PURPOSE OF CERTIFICATION TO JURISDICTIONAL AGENCIES AS REQUIRED. ALL AS-BUILT DATA SHALL BE COLLECTED BY A STATE PROFESSIONAL LAND SURVEYOR WHOSE SERVICES ARE ENGAGED BY THE CONTRACTOR.
12. ANY WELLS DISCOVERED ON SITE THAT WILL HAVE NO USE MUST BE PLUGGED BY A LICENSED WELL DRILLING CONTRACTOR IN A MANNER APPROVED BY ALL JURISDICTIONAL AGENCIES. CONTRACTOR SHALL BE RESPONSIBLE FOR OBTAINING ANY WELL ABANDONMENT PERMITS REQUIRED.
13. ANY WELL DISCOVERED DURING EARTH MOVING OR EXCAVATION SHALL BE REPORTED TO THE APPROPRIATE JURISDICTIONAL AGENCIES WITHIN 24 HOURS AFTER DISCOVERY IS MADE.
14. THE CONTRACTOR SHALL BE RESPONSIBLE FOR VERIFYING THAT THE PROPOSED IMPROVEMENTS SHOWN ON THE PLANS DO NOT CONFLICT WITH ANY KNOWN EXISTING OR OTHER PROPOSED IMPROVEMENTS. IF ANY CONFLICTS ARE DISCOVERED, THE CONTRACTOR SHALL NOTIFY THE OWNER PRIOR TO INSTALLATION OF ANY PORTION OF THE SITE WORK THAT WOULD BE AFFECTED. FAILURE TO NOTIFY OWNER OF ANY IDENTIFIABLE CONFLICT PRIOR TO PROCEEDING WITH INSTALLATION RELIEVES OWNER OF ANY OBLIGATION TO PAY FOR A RELATED CHANGE ORDER.
15. SHOULD CONTRACTOR ENCOUNTER ANY DEBRIS LADEN SOIL, STRUCTURES NOT IDENTIFIED IN THE DOCUMENTS, OR OTHER SOURCE OF POTENTIAL CONTAMINATION, THEY SHALL IMMEDIATELY CONTACT THE ENGINEER AND OWNER.
16. CONTRACTOR SHALL NOTIFY OWNER AND/OR ENGINEER 48 HOURS IN ADVANCE OF THE FOLLOWING ACTIVITIES: PRE-CONSTRUCTION MEETING, SUBGRADE PREPARATION, BASE INSTALLATION, ASPHALT INSTALLATION, UNDERGROUND PIPING AND UTILITIES INSTALLATION, INSTALLATION OF STRUCTURES, CHECK VALVES, HYDRANTS, METERS, ETC., SIDEWALK INSTALLATION, CONNECTIONS TO WATER AND SEWER MAINS, TESTS OF UTILITIES.

THIRD PARTY SUPPLEMENTAL INFORMATION

KIMLEY-HORN ASSUMES NO LIABILITY FOR ANY ERRORS, INACCURACIES, OR OMISSIONS CONTAINED WITHIN SUPPLEMENTAL INFORMATION PROVIDED BY THIRD PARTY CONSULTANTS.

1. **BOUNDARY & TOPOGRAPHIC SURVEY**
PERFORMED BY: <CONSULTANT NAME>
ADDRESS: <ADDRESS>
PHONE: XXX-XXX-XXXX
DATED: MM/DD/YYYY

2. **GEOTECHNICAL EVALUATION REPORT**
PERFORMED BY: <CONSULTANT NAME>
ADDRESS: <ADDRESS>
PHONE: XXX-XXX-XXXX
DATED: MM/DD/YYYY

3. **CONSTRUCTION TESTING**
TEST REPORTS REQUIRED FOR CLOSE OUT INCLUDE, BUT ARE NOT LIMITED TO:
 - DENSITY TEST REPORTS
 - BACTERIOLOGICAL TESTS OF WATER SYSTEM
 - PRESSURE TEST OF WATER/SEWER
 - LEAK TESTS ON SEWER SYSTEM AND GREASE TRAPS
 - ANY OTHER TESTING REQUIRED BY THE AGENCY/MUNICIPALITY

EROSION CONTROL NOTES

1. THE STORM WATER POLLUTION PREVENTION PLAN ("SWPPP") IS COMPRISED OF THE EROSION CONTROL PLAN, THE STANDARD DETAILS, THE PLAN NARRATIVE, ATTACHMENTS INCLUDED IN THE SPECIFICATIONS OF THE SWPPP, PLUS THE PERMIT AND ALL SUBSEQUENT REPORTS AND RELATED DOCUMENTS.
2. ALL CONTRACTORS AND SUBCONTRACTORS INVOLVED WITH STORM WATER POLLUTION PREVENTION SHALL OBTAIN A COPY OF THE STORM WATER POLLUTION PREVENTION PLAN AND THE STATE NATIONAL POLLUTANT DISCHARGE ELIMINATION SYSTEM GENERAL PERMIT (NPDES PERMIT) AND BECOME FAMILIAR WITH THEIR CONTENTS.
3. BEST MANAGEMENT PRACTICES (BMP'S) AND CONTROLS SHALL CONFORM TO FEDERAL, STATE, OR LOCAL REQUIREMENTS OR MANUAL OF PRACTICE, AS APPLICABLE. THE CONTRACTOR SHALL IMPLEMENT ADDITIONAL CONTROLS AS DIRECTED BY THE PERMITTING AGENCY OR OWNER.
4. THE CONTRACTOR IS SOLELY RESPONSIBLE FOR COMPLYING WITH THE REQUIREMENTS OF THE AUTHORITIES HAVING JURISDICTION, AND SHALL MAINTAIN COMPLIANCE WITH APPLICABLE LAWS AND REGULATIONS FOR THE DURATION OF CONSTRUCTION.
5. THE CONTRACTOR SHALL FIELD ADJUST AND/OR PROVIDE ADDITIONAL EROSION CONTROL, BMP'S AS NEEDED TO PREVENT EROSION AND TO MINIMIZE SEDIMENT DISCHARGE FROM THE CONSTRUCTION SITE. LOG AND RECORD ANY ADJUSTMENTS AND DEVIATIONS FROM THE APPROVED EROSION CONTROL PLANS WITHIN THE SWPPP DOCUMENTS STORED IN THE JOB SITE TRAILER.
6. BMP'S SHOWN ON THE EROSION AND SEDIMENT CONTROL PLAN, AND IN THE STORM WATER POLLUTION PREVENTION PLAN, SHALL BE MAINTAINED IN FULLY FUNCTIONAL CONDITION AS REQUIRED BY ALL JURISDICTIONS UNTIL NO LONGER REQUIRED FOR A COMPLETED PHASE OF WORK OR FINAL STABILIZATION. EROSION AND SEDIMENTATION CONTROL MEASURES SHALL BE CHECKED BY A CERTIFIED PERSON AT LEAST ONCE EVERY 7 CALENDAR DAYS AND WITHIN 24 HOURS OF THE END OF A 0.5-INCH OR GREATER RAINFALL EVENT.
7. EROSION & SEDIMENT CONTROL BMP'S SHALL BE MAINTAINED IN ACCORDANCE WITH THE FOLLOWING:
 - 7.1. INLET PROTECTION DEVICES AND BARRIERS SHALL BE REPAIRED OR REPLACED IF THEY SHOW SIGNS OF UNDERMINING OR DETERIORATION.
 - 7.2. ALL SEEDED AREAS SHALL BE CHECKED REGULARLY TO VERIFY THAT A HEALTHY STAND OF VEGETATION IS MAINTAINED. SEEDED AREAS SHOULD BE FERTILIZED, WATERED AND RE-SEEDED AS NEEDED. REFER TO THE LANDSCAPE PLAN AND PROJECT SPECIFICATIONS.
 - 7.3. SILT FENCES SHALL BE REPAIRED TO THEIR ORIGINAL CONDITIONS IF DAMAGED. SEDIMENT SHALL BE REMOVED FROM THE SILT FENCES WHEN IT REACHES ONE-THIRD THE HEIGHT OF THE SILT FENCE.
 - 7.4. THE ROCK CONSTRUCTION ENTRANCE(S) SHALL BE MAINTAINED IN A CONDITION WHICH WILL PREVENT TRACKING OR FLOW OF MUD ONTO PUBLIC RIGHTS-OF-WAY. THIS MAY REQUIRE PERIODIC ADDITIONS OF ROCK TOP DRESSING AS CONDITIONS DEMAND.
 - 7.5. THE TEMPORARY PARKING AND STORAGE AREA SHALL BE KEPT IN GOOD CONDITION (SUITABLE FOR PARKING AND STORAGE). THIS MAY REQUIRE PERIODIC ADDITIONS OF TOP DRESSING IF THE TEMPORARY PARKING CONDITIONS DEMAND.
 - 7.6. PERFORM ALL MAINTENANCE OPERATIONS IN A TIMELY MANNER BUT IN NO CASE LATER THAN 2 CALENDAR DAYS FOLLOWING THE INSPECTION.

PAVING AND STRIPING NOTES

1. ALL PAVING, CONSTRUCTION, MATERIALS, AND WORKMANSHIP WITHIN JURISDICTION'S RIGHT-OF-WAY SHALL BE IN ACCORDANCE WITH THE LATEST EDITION OF THE LOCAL CITY OR COUNTY SPECIFICATIONS AND STANDARDS, OR THE STATE DOT SPECIFICATIONS AND STANDARDS IF NOT COVERED BY LOCAL CITY OR COUNTY REGULATIONS.
2. ALL SIGNS, PAVEMENT MARKINGS, AND OTHER TRAFFIC CONTROL DEVICES SHALL CONFORM TO MANUAL ON UNIFORM TRAFFIC CONTROL DEVICES (M.U.T.C.D.) AND CITY STANDARDS.
3. CONTRACTOR SHALL FURNISH ALL PAVEMENT MARKINGS FOR FIRE LANES, ROADWAY LANES, PARKING STALLS, ACCESSIBLE PARKING SYMBOLS, ACCESS AISLES, STOP BARS AND SIGNS, AND MISCELLANEOUS STRIPING WITHIN THE PARKING LOT AS SHOWN ON THE PLANS.
4. ALL EXPANSION JOINTS SHALL EXTEND THROUGH THE CURB.
5. THE MINIMUM LENGTH OF OFFSET JOINTS AT RADIUS POINTS SHALL BE 2 FEET.
6. ALL JOINTS, INCLUDING EXPANSION JOINTS WITH REMOVABLE TACK STRIPS, SHALL BE SEALED WITH JOINT SEALANT.
7. THE MATERIALS AND PROPERTIES OF ALL CONCRETE SHALL MEET THE APPLICABLE REQUIREMENTS IN THE A.C.I. (AMERICAN CONCRETE INSTITUTE) MANUAL OF CONCRETE PRACTICE.
8. CONTRACTOR SHALL APPLY A SECOND COATING OVER ALL PAVEMENT MARKINGS PRIOR TO ACCEPTANCE BY OWNER FOLLOWED BY A COAT OF GLASS BEADS AS APPLICABLE PER THE PROJECT DOCUMENTS.
9. ANY EXISTING PAVEMENT, CURBS AND/OR SIDEWALKS DAMAGED OR REMOVED WILL BE REPAIRED BY THE CONTRACTOR AT HIS EXPENSE TO THE SATISFACTION OF THE ENGINEER AND OWNER.
10. BEFORE PLACING PAVEMENT, CONTRACTOR SHALL VERIFY SUITABLE ACCESSIBLE ROUTES (PER A.D.A.) GRADING FOR ALL SIDEWALKS AND ACCESSIBLE ROUTES INCLUDING CROSSING DRIVEWAYS SHALL CONFORM TO CURRENT ADA STATE/NATIONAL STANDARDS. IN NO CASE SHALL ACCESSIBLE RAMP SLOPES EXCEED 1 VERTICAL TO 12 HORIZONTAL. IN NO CASE SHALL SIDEWALK CROSS SLOPES EXCEED 2%. IN NO CASE SHALL LONGITUDINAL SIDEWALK SLOPES EXCEED 5%. IN NO CASE SHALL ACCESSIBLE PARKING STALLS OR AISLES EXCEED 2% (1.5% TARGET) IN ALL DIRECTIONS. SIDEWALK ACCESS TO EXTERNAL BUILDING DOORS AND GATES SHALL BE ADA COMPLIANT. CONTRACTOR SHALL NOTIFY ENGINEER IMMEDIATELY IF ADA CRITERIA CANNOT BE MET IN COMPLIANCE PRIOR TO PAVING. NO CONTRACTOR CHANGE ORDERS WILL BE ACCEPTED FOR A.D.A COMPLIANCE ISSUES.
11. MAXIMUM JOINT SPACING IS TWICE THE DEPTH OF THE CONCRETE PAVEMENT IN FEET.

GRADING AND DRAINAGE NOTES

1. GENERAL CONTRACTOR AND ALL SUBCONTRACTORS SHALL VERIFY THE SUITABILITY OF ALL EXISTING AND PROPOSED SITE CONDITIONS INCLUDING GRADING AND DIMENSIONS BEFORE START OF CONSTRUCTION. THE ENGINEER SHALL BE NOTIFIED IMMEDIATELY OF ANY DISCREPANCIES.
2. THE CONTRACTOR SHALL GRADE THE SITE TO THE ELEVATIONS INDICATED AND SHALL ADJUST BMP'S AS NECESSARY AND REGRADE WASHOUTS WHERE THEY OCCUR AFTER EVERY RAINFALL UNTIL A GRASS STAND IS WELL ESTABLISHED OR ADEQUATE STABILIZATION OCCURS.
3. CONTRACTOR SHALL ENSURE THERE IS POSITIVE DRAINAGE FROM THE PROPOSED BUILDINGS SO THAT SURFACE RUNOFF WILL DRAIN BY GRAVITY TO NEW OR EXISTING DRAINAGE OUTLETS. CONTRACTOR SHALL ENSURE NO PONDING OCCURS IN PAVED AREAS AND SHALL NOTIFY ENGINEER IF ANY GRADING DISCREPANCIES ARE FOUND IN THE EXISTING AND PROPOSED GRADES PRIOR TO PLACEMENT OF PAVEMENT OR UTILITIES.
4. CONTRACTOR SHALL PROTECT ALL MANHOLE COVERS, VALVE COVERS, VAULT LIDS, FIRE HYDRANTS, POWER POLES, GUY WIRES, AND TELEPHONE BOXES THAT ARE TO REMAIN IN PLACE AND UNDISTURBED DURING CONSTRUCTION. EXISTING CASTINGS AND STRUCTURES TO REMAIN SHALL BE ADJUSTED TO MATCH THE PROPOSED FINISHED GRADES.
5. BACKFILL FOR UTILITY LINES SHALL BE PLACED PER DETAILS, STANDARDS, AND SPECIFICATIONS SO THAT THE UTILITY WILL BE STABLE. WHERE UTILITY LINES CROSS THE PARKING LOT, THE TOP 6 INCHES SHALL BE COMPACTED SIMILARLY TO THE REMAINDER OF THE LOT. UTILITY DITCHES SHALL BE VISUALLY INSPECTED DURING THE EXCAVATION PROCESS TO ENSURE THAT UNDESIRABLE FILL IS NOT USED.
6. CONTRACTOR IS RESPONSIBLE FOR THE REMOVAL AND REPLACEMENT OF 4" OF TOPSOIL AT COMPLETION OF WORK. ALL UNPAVED AREAS IN EXISTING RIGHTS-OF-WAY DISTURBED BY CONSTRUCTION SHALL BE REGRADED AND SODDED.
7. AFTER PLACEMENT OF SUBGRADE AND PRIOR TO PLACEMENT OF PAVEMENT, CONTRACTOR SHALL TEST AND OBSERVE PAVEMENT AREAS FOR EVIDENCE OF PONDING. ALL AREAS SHALL ADEQUATELY DRAIN TOWARDS THE INTENDED STRUCTURE TO CONVEY STORM RUNOFF. CONTRACTOR SHALL IMMEDIATELY NOTIFY OWNER AND ENGINEER IF ANY DISCREPANCIES ARE DISCOVERED.
8. WHERE EXISTING PAVEMENT IS INDICATED TO BE REMOVED AND REPLACED, THE CONTRACTOR SHALL SAW CUT FULL DEPTH FOR A SMOOTH AND STRAIGHT JOINT AND REPLACE THE PAVEMENT WITH THE SAME TYPE AND DEPTH OF MATERIAL AS EXISTING OR AS INDICATED.
9. THE CONTRACTOR SHALL INSTALL PROTECTION OVER ALL DRAINAGE STRUCTURES FOR THE DURATION OF CONSTRUCTION AND UNTIL ACCEPTANCE OF THE PROJECT BY THE OWNER. ALL DRAINAGE STRUCTURES SHALL BE CLEARED OF DEBRIS AS REQUIRED DURING AND AT THE END OF CONSTRUCTION TO PROVIDE POSITIVE DRAINAGE FLOWS.
10. IF DEWATERING IS REQUIRED, THE CONTRACTOR SHALL OBTAIN ANY APPLICABLE REQUIRED PERMITS. THE CONTRACTOR IS TO COORDINATE WITH THE OWNER AND THE DESIGN ENGINEER PRIOR TO ANY EXCAVATION.
11. FIELD DENSITY TESTS SHALL BE TAKEN AT INTERVALS IN ACCORDANCE WITH THE LOCAL JURISDICTIONAL AGENCY OR TO STATE DOT STANDARDS. IN THE EVENT THAT THE CONTRACT DOCUMENTS AND THE JURISDICTIONAL AGENCY REQUIREMENTS ARE NOT IN AGREEMENT, THE MOST STRINGENT SHALL GOVERN.
12. ALL SLOPES AND AREAS DISTURBED BY CONSTRUCTION SHALL BE GRAZED AS PER PLANS. THE AREAS SHALL THEN BE SODDED OR SEEDED AS SPECIFIED IN THE PLANS, FERTILIZED, MULCHED, WATERED AND MAINTAINED UNTIL GROWTH IS ESTABLISHED TO MINIMUM COVERAGE OF 70% IN ALL AREAS. ANY AREAS DISTURBED FOR ANY REASON PRIOR TO FINAL ACCEPTANCE OF THE JOB SHALL BE CORRECTED BY THE CONTRACTOR AT NO ADDITIONAL COST TO THE OWNER. ALL EARTHEN AREAS WILL BE SODDED OR SEEDED AND MULCHED AS SHOWN ON THE LANDSCAPING PLAN.
13. THE CONTRACTOR SHALL BE RESPONSIBLE FOR THE CONTROL OF DUST AND DIRT RISING AND SCATTERING IN THE AIR DURING CONSTRUCTION AND SHALL PROVIDE WATER SPRINKLING OR OTHER SUITABLE METHODS OF CONTROL. THE CONTRACTOR SHALL COMPLY WITH ALL GOVERNING REGULATIONS PERTAINING TO ENVIRONMENTAL PROTECTION.
14. SOD, WHERE CALLED FOR, MUST BE INSTALLED AND MAINTAINED ON EXPOSED SLOPES WITHIN 48 HOURS OF COMPLETING FINAL GRADING, AND AT ANY OTHER TIME AS NECESSARY, TO PREVENT EROSION, SEDIMENTATION OR TURBID DISCHARGES.
15. THE CONTRACTOR SHALL ENSURE THAT LANDSCAPE ISLAND PLANTING AREAS AND OTHER PLANTING AREAS ARE NOT COMPACTED AND DO NOT CONTAIN ROAD BASE MATERIALS. THE CONTRACTOR SHALL ALSO EXCAVATE AND REMOVE ALL UNDESIRABLE MATERIAL FROM ALL AREAS ON THE SITE TO BE PLANTED AND PROPERLY DISPOSED OF IN A LEGAL MANNER.
16. THE CONTRACTOR SHALL INSTALL ALL UNDERGROUND STORM WATER PIPING PER MANUFACTURER'S RECOMMENDATIONS AND STATE DOT SPECIFICATIONS.
17. PAVEMENTS SHALL BE INSTALLED IN ACCORDANCE WITH THE RECOMMENDATION OF THE SITE SPECIFIC GEOTECHNICAL EVALUATION REPORT AND CITY & STATE DOT SPECIFICATIONS.
18. SPOT ELEVATIONS REPRESENT THE FINISHED SURFACE GRADE OR FLOWLINE OF CURB UNLESS OTHERWISE NOTED.
19. LIMITS OF CONSTRUCTION ARE TO THE PROPERTY LINE UNLESS OTHERWISE SPECIFIED ON THE PLAN.
20. IMMEDIATELY REPORT TO THE OWNER ANY DISCREPANCIES FOUND BETWEEN ACTUAL FIELD CONDITIONS AND CONSTRUCTION DOCUMENTS.
21. THE CONTRACTOR IS RESPONSIBLE FOR LOCATING AND PROTECTING EXISTING UTILITIES, AND SHALL REPAIR ALL DAMAGE TO EXISTING UTILITIES THAT OCCUR DURING CONSTRUCTION WITHOUT COMPENSATION.
22. BLEND NEW EARTHWORK SMOOTHLY TO TRANSITION BACK TO EXISTING GRADE.
23. ALL PROPOSED GRADES ONSITE SHALL BE 3:1 OR FLATTER UNLESS OTHERWISE INDICATED ON THE PLANS. ANY SLOPES STEEPER THAN 4:1 REQUIRE EROSION AND SEDIMENT CONTROL BLANKET.
24. ADHERE TO ALL TERMS AND CONDITIONS AS NECESSARY IN THE GENERAL N.P.D.E.S. PERMIT AND STORMWATER POLLUTION PREVENTION PLAN (SWPPP) FOR STORMWATER DISCHARGE ASSOCIATED WITH CONSTRUCTION ACTIVITIES.
25. ADJUST AND/OR CUT EXISTING PAVEMENT AS NECESSARY TO ASSURE A SMOOTH FIT AND CONTINUOUS GRADE.

WATER STORM SEWER & SANITARY SEWER NOTES

1. THE CONTRACTOR SHALL CONSTRUCT GRAVITY SEWER LATERALS, MANHOLES, GRAVITY SEWER LINES AND DOMESTIC WATER AND FIRE PROTECTION SYSTEM AS SHOWN ON THESE PLANS. THE CONTRACTOR SHALL FURNISH ALL NECESSARY MATERIALS, EQUIPMENT, MACHINERY, TOOLS, MEANS OF TRANSPORTATION AND LABOR NECESSARY TO COMPLETE THE WORK IN FULL AND COMPLETE ACCORDANCE WITH THE SHOWN, DESCRIBED AND REASONABLY INTENDED REQUIREMENTS OF THE CONTRACT DOCUMENTS AND JURISDICTIONAL AGENCY REQUIREMENTS. IN THE EVENT THAT THE CONTRACT DOCUMENTS AND THE JURISDICTIONAL AGENCY REQUIREMENTS ARE NOT IN AGREEMENT, THE MOST STRINGENT SHALL GOVERN.
2. ALL EXISTING UNDERGROUND UTILITY LOCATIONS SHOWN ARE APPROXIMATE. THE CONTRACTOR SHALL COMPLY WITH ALL REQUIREMENTS FOR UTILITY LOCATION AND COORDINATION IN ACCORDANCE WITH THE NOTES CONTAINED IN THE GENERAL CONSTRUCTION SECTION OF THIS SHEET.
3. THE CONTRACTOR SHALL RESTORE ALL DISTURBED VEGETATION IN KIND, UNLESS SHOWN OTHERWISE.
4. DEFLECTION OF PIPE JOINTS AND CURVATURE OF PIPE SHALL NOT EXCEED THE MANUFACTURER'S SPECIFICATIONS. SECURELY CLOSE ALL OPEN ENDS OF PIPE AND FITTINGS WITH A WATERTIGHT PLUG WHEN WORK IS NOT IN PROGRESS. THE INTERIOR OF ALL PIPES SHALL BE CLEAN AND JOINT SURFACES WIPED CLEAN AND DRY AFTER THE PIPE HAS BEEN LOWERED INTO THE TRENCH. VALVES SHALL BE PLUMB AND LOCATED ACCORDING TO THE PLANS.
5. ALL PIPE AND FITTINGS SHALL BE CAREFULLY STORED FOLLOWING MANUFACTURER'S RECOMMENDATIONS. CARE SHALL BE TAKEN TO AVOID DAMAGE TO THE COATING OR LINING IN ANY D.I. PIPE FITTINGS. ANY PIPE OR FITTING WHICH IS DAMAGED OR WHICH HAS FLAWS OR IMPERFECTIONS WHICH, IN THE OPINION OF THE ENGINEER OR OWNER, RENDERS IT UNFIT FOR USE, SHALL NOT BE USED. ANY PIPE NOT SATISFACTORY FOR USE SHALL BE CLEARLY MARKED AND IMMEDIATELY REMOVED FROM THE JOB SITE, AND SHALL BE REPLACED AT THE CONTRACTOR'S EXPENSE.
6. WATER FOR FIRE FIGHTING SHALL BE MADE AVAILABLE FOR USE BY THE CONTRACTOR PRIOR TO COMBUSTIBLES BEING BROUGHT ON SITE.
7. ALL UTILITY AND STORM DRAIN TRENCHES LOCATED UNDER AREAS TO RECEIVE PAVING SHALL BE COMPLETELY BACK FILLED IN ACCORDANCE WITH THE GOVERNING JURISDICTIONAL AGENCY'S SPECIFICATIONS. IN THE EVENT THAT THE CONTRACT DOCUMENTS AND THE JURISDICTIONAL AGENCY REQUIREMENTS ARE NOT IN AGREEMENT, THE MOST STRINGENT SHALL GOVERN.
8. UNDERGROUND UTILITY LINES SHALL BE SURVEYED BY A STATE LICENSED PROFESSIONAL LAND SURVEYOR PRIOR TO BACK FILLING.
9. CONTRACTOR SHALL PERFORM, AT THEIR OWN EXPENSE, ANY AND ALL TESTS REQUIRED BY THE SPECIFICATIONS AND/OR ANY AGENCY HAVING JURISDICTION. THESE TESTS MAY INCLUDE, BUT MAY NOT BE LIMITED TO, INFILTRATION, EXFILTRATION, TELEVISION INSPECTION AND A MANHOLE TEST ON GRAVITY SEWER. A COPY OF THE TEST RESULTS SHALL BE PROVIDED TO THE UTILITY PROVIDER, OWNER AND JURISDICTIONAL AGENCY AS REQUIRED.
10. BETWEEN WATER AND SEWER MANHOLES AND PIPES, CONTRACTOR SHALL PROVIDE FOR A MINIMUM HORIZONTAL CLEARANCE OF 10-FEET AND A MINIMUM VERTICAL SEPARATION OF 18-INCHES.
11. IF ANY EXISTING STRUCTURES TO REMAIN ARE DAMAGED DURING CONSTRUCTION IT SHALL BE THE CONTRACTOR'S RESPONSIBILITY TO REPAIR AND/OR REPLACE THE EXISTING STRUCTURE AS NECESSARY TO RETURN IT TO EXISTING CONDITIONS OR BETTER.
12. ALL STORM PIPE ENTERING STRUCTURES SHALL BE GASKETED AND/OR GROUTED TO ASSURE CONNECTION AT STRUCTURE IS WATERTIGHT UNLESS OTHERWISE STATED BY CITY AND STATE DESIGN STANDARDS AND SPECIFICATIONS.
13. UNLESS OTHERWISE STATED IN CITY AND STATE DESIGN STANDARDS AND SPECIFICATIONS, ALL STORM SEWER MANHOLES IN PAVED AREAS SHALL BE FLUSH WITH PAVEMENT, AND SHALL HAVE TRAFFIC BEARING RING & COVERS. MANHOLES IN UNPAVED AREAS SHALL BE 6" ABOVE FINISH GRADE. LIDS SHALL BE LABELED "STORM SEWER". EXISTING CASTINGS AND STRUCTURES WITHIN PROJECT LIMITS SHALL BE ADJUSTED TO MEET THESE CONDITIONS AND THE PROPOSED FINISHED GRADE.
14. TOPOGRAPHIC INFORMATION IS TAKEN FROM A TOPOGRAPHIC SURVEY BY LAND SURVEYORS. IF THE CONTRACTOR DOES NOT ACCEPT EXISTING TOPOGRAPHY AS SHOWN ON THE PLANS, WITHOUT EXCEPTION, THEN THE CONTRACTOR SHALL SUPPLY, AT THEIR EXPENSE, A TOPOGRAPHIC SURVEY BY A REGISTERED LAND SURVEYOR TO THE OWNER FOR REVIEW.
15. CONSTRUCTION SHALL COMPLY WITH ALL APPLICABLE GOVERNING CODES AND BE CONSTRUCTED TO SAME.
16. ALL STORM STRUCTURES SHALL HAVE A SMOOTH UNIFORM POURED MORTAR FROM INVERT IN TO INVERT OUT.
17. ROOF DRAINS SHALL BE CONNECTED TO STORM SEWER BY PREFABRICATED WYES OR AT STORM STRUCTURES. ROOF DRAINS AND TRUCK WELL DRAIN SHALL RUN AT A MINIMUM 2.0% SLOPE, UNLESS NOTED OTHERWISE, AND TIE IN AT THE CENTERLINE OF THE STORM MAIN.
18. PROVIDE INSULATION OF UNDERGROUND ROOF DRAINS AND SANITARY SEWER SERVICES IF ADEQUATE FROST DEPTH CANNOT BE PROVIDED.
19. THE CONTRACTOR SHALL PROTECT EXISTING UNDERGROUND UTILITIES AND APPURTENANCES THAT ARE TO REMAIN FROM DAMAGE DURING CONSTRUCTION OPERATIONS.
20. THE LOCATION OF EXISTING UTILITIES, STORM DRAINAGE STRUCTURES AND OTHER ABOVE AND BELOW-GRADE IMPROVEMENTS ARE APPROXIMATE AS SHOWN. IT IS THE CONTRACTOR'S RESPONSIBILITY TO DETERMINE THE EXACT LOCATION, SIZE AND INVERT ELEVATIONS OF EACH PRIOR TO THE START OF CONSTRUCTION.
21. A MINIMUM SEPARATION OF 5-FEET IS REQUIRED BETWEEN UNDERGROUND UTILITIES AND TREES UNLESS A ROOT BARRIER IS UTILIZED.
22. GAS, PHONE AND ELECTRIC SERVICES SHOWN FOR INFORMATIONAL PURPOSES ONLY. DRY UTILITY COMPANIES MAY ALTER THE DESIGN LAYOUT DURING THEIR REVIEW. CONTRACTOR TO COORDINATE FINAL DESIGN AND INSTALLATION WITH UTILITY COMPANIES.
23. COORDINATE UTILITY INSTALLATION WITH IRRIGATION DESIGN AND INSTALLATION.
24. ALL DIMENSIONS ARE TO FLOW LINE OF CURB UNLESS OTHERWISE NOTED. PERIMETER WALL DIMENSIONS ARE TO INSIDE WALL FACE. REFERENCE ARCHITECTURAL PLANS FOR EXACT WALL WIDTH AND SPECIFICATIONS.
25. REFERENCE ARCHITECTURAL PLANS (BY OTHERS) FOR EXACT BUILDING DIMENSIONS, MATERIALS SPECIFICATIONS.
26. REFERENCE M.E.P. PLANS (BY OTHERS) FOR MECHANICAL EQUIPMENT DIMENSIONS AND SPECIFICATIONS.
27. CONTRACTOR SHALL REFERENCE STRUCTURAL PLANS (BY OTHERS) FOR FOOTING AND FOUNDATION PAD PREPARATION SPECIFICATIONS.
28. CONTRACTOR SHALL REFERENCE M.E.P. PLANS (BY OTHERS) FOR ROUTING OF PROPOSED ELECTRICAL & COMMUNICATIONS SERVICES AND SITE LIGHTING LAYOUT.

[illegible]



-

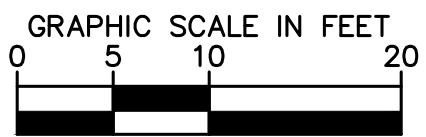

Know what's **below**.
Call before you dig.

1. ALL PERMETER SILT FENCE AND ROCK CONSTRUCTION EXCHANGES SHALL BE INSTALLED PRIOR TO CONSTRUCTION.
2. THE CONTRACTOR SHALL CONSTRUCT DRAINAGE BASINS PRIOR TO SITE GRADING.
3. THE CONTRACTOR SHALL INSTALL CATCH BASIN EROSION CONTROL MEASURES.
4. WITHIN TWO WEEKS [14 DAYS] OF SITE GRADING, ALL DISTURBED AREAS SHALL BE STABILIZED WITH SEED, SOG, OR ROCK BASS. REFERENCE TO LANDSCAPE PLANS FOR MATERIALS.
5. ALL EROSION CONTROL MEASURES SHALL BE INSTALLED AND MAINTAINED IN ACCORDANCE WITH CITY, STATE, AND WATERSHED DISTRICT PERMITS.
6. THE CONTRACTOR SHALL MAINTAIN ALL EROSION CONTROL MEASURES, INCLUDING THE REMOVAL OF SILT IN FRONT OF SILT FENCES DURING THE DURATION OF THE CONSTRUCTION.
7. ANY EXCESS SEDIMENT IN PROPOSED BASINS SHALL BE REMOVED BY THE CONTRACTOR.
8. REMOVAL OF EROSION CONTROL MEASURES AFTER VEGETATION IS ESTABLISHED.
9. THE CONTRACTOR SHALL REMOVE ALL SOIL AND SEDIMENT TRACKS FROM EXISTING STREETS AND PAVES AREAS AND SHALL SWEEP ADJACENT STREETS AS NECESSARY IN ACCORDANCE WITH CITY REQUIREMENTS.
10. IF FLOWING DOTS BECOMES A NUISANCE, THE CONTRACTOR SHALL APPLY WATER FROM A TRUCK TANK TO ALL CONSTRUCTION AREAS.

UPON IMPLEMENTATION AND INSTALLATION OF THE FOLLOWING AREAS: TRAILER, PARKING, LAYDOWN, PORTA-POTTY, WHEEL WASH, CONCRETE WASHOUT, FUEL AND MATERIAL STORAGE CONTAINERS, SOLID WASTE CONTAINERS, ETC., IMMEDIATELY DENOTE THEM ON THE SITE MAPS AND NOTE ANY CHANGES IN LOCATION AS THEY OCCUR THROUGHOUT THE CONSTRUCTION PROCESS.

1. INSTALL INLET PROTECTION AT EXISTING STORMWATER CULVERTS.
2. CONSTRUCT STABILIZED CONSTRUCTION ENTRANCE (1). CONCRETE WASHOUT PIT (1) AND INSTALL SILT FENCE.
3. PREPARE TEMPORARY PARKING AND STORAGE AREA.
4. CONSTRUCT AND STABILIZE DIVERSIONS AND TEMPORARY SEDIMENT TRAPS.
5. PERFORM LEAKING AND GRUBBING OF THE SITE. PERFORM MASS GRADING, ROUGH GRADE TO ESTABLISH PROPOSED DRAINAGE PATTERNS.
6. START CONSTRUCTION OF THE BUILDING PAD AND STRUCTURES.
7. TEMPORILY SEED WITH PURE LIME SEED, THROUGHOUT CONSTRUCTION, DISTURBED AREAS THAT WILL BE INACTIVE FOR 14 DAYS OR MORE OR AS REQUIRED BY NPDES AND/OR CITY OF MURFREESBORO GRADING PERMIT.

PRELIMINARY - NOT FOR CONSTRUCTION										KHA PROJECT 160094046.1										Kimley»»Horn																																																	
CHASE BANK- WAUWATOSA PREPARED FOR THE ARCHITECTS PARTNERSHIP WAUWATOSA										SHEET NUMBER C200										2023 KIMLEY-HORN AND ASSOCIATES, INC. 767 EUSTIS STREET, SUITE 100, ST. PAUL, MN 55114 PHONE 651-645-4197 WWW.KIMLEY-HORN.COM										No.										REVISIONS										DATE										BY									
										DATE XX/XX/XXXX																																																											
										SCALE AS SHOWN																																																											
										DESIGNED BY MTL																																																											
										DRAWN BY BSK																																																											
										CHECKED BY TJS																																																											

PRELIMINARY - NOT FOR CONSTRUCTION

CHASE BANK-

WAUWATOS

PREPARED FOR

THE ARCHITECT

PA

DEMO & EROSION CONTROL PLAN

Kimley»»Horn

2023 KIMLEY-HORN AND ASSOCIATES, INC.

767 EUSTIS STREET, SUITE 100, ST. PAUL, MN 55114
PHONE: 651-645-4197

WWW.KIMLEY-HORN.COM

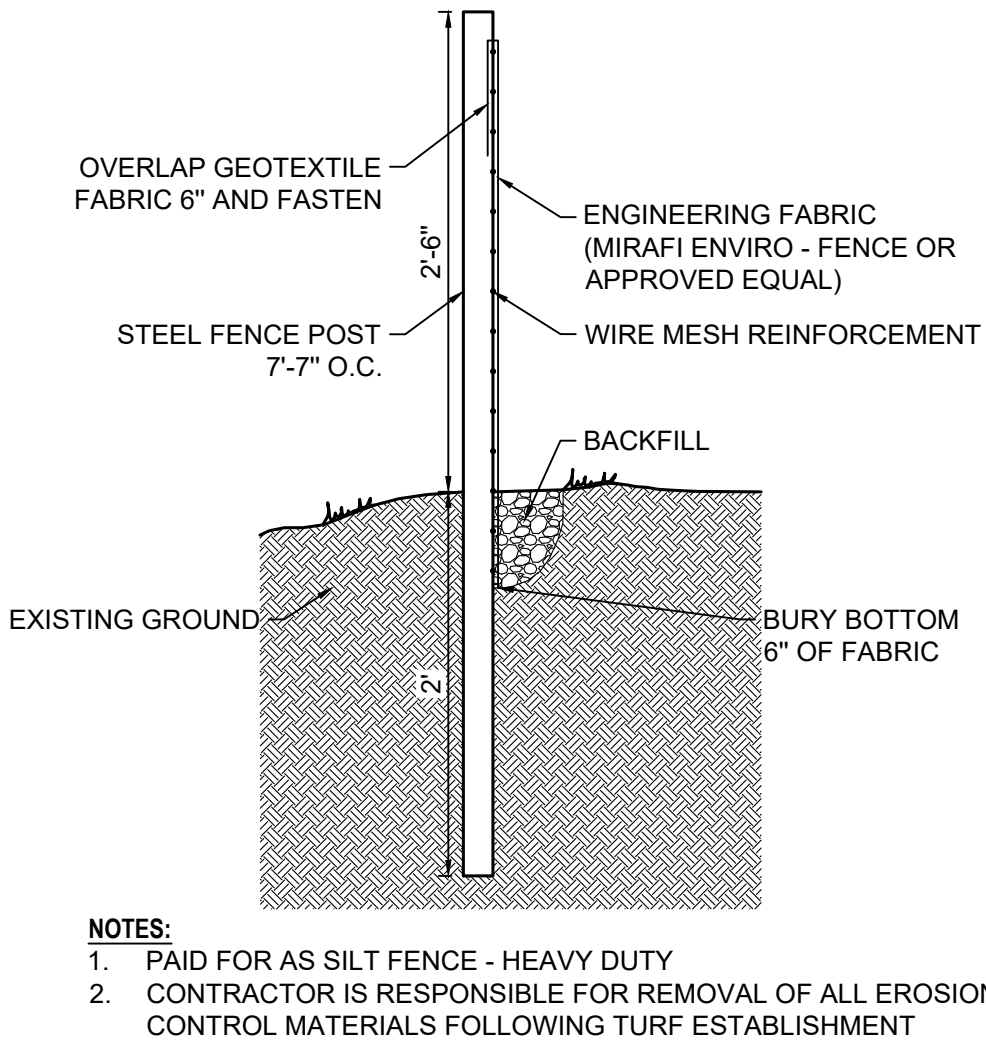

SILT FENCE
NO SCALE

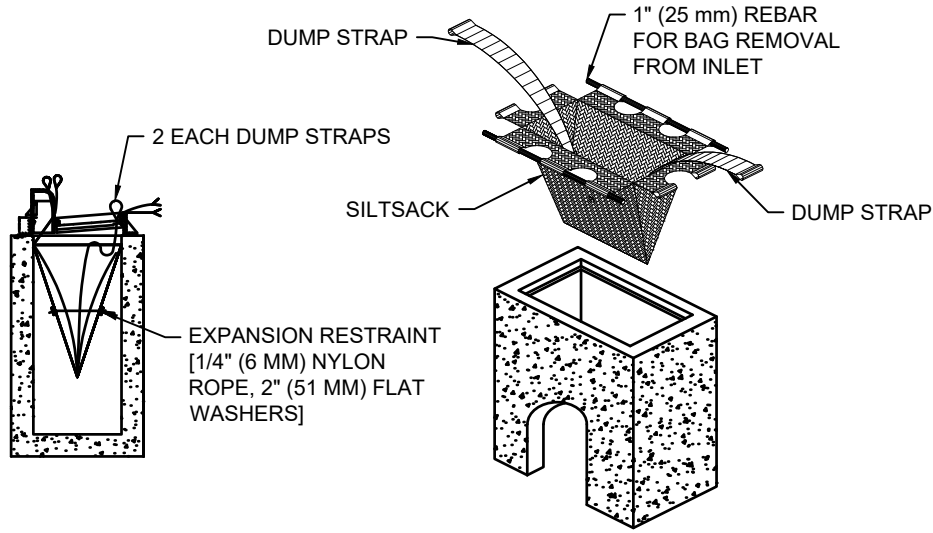

INLET PROTECTION - SEDIMENT FILTER SACK
NO SCALE

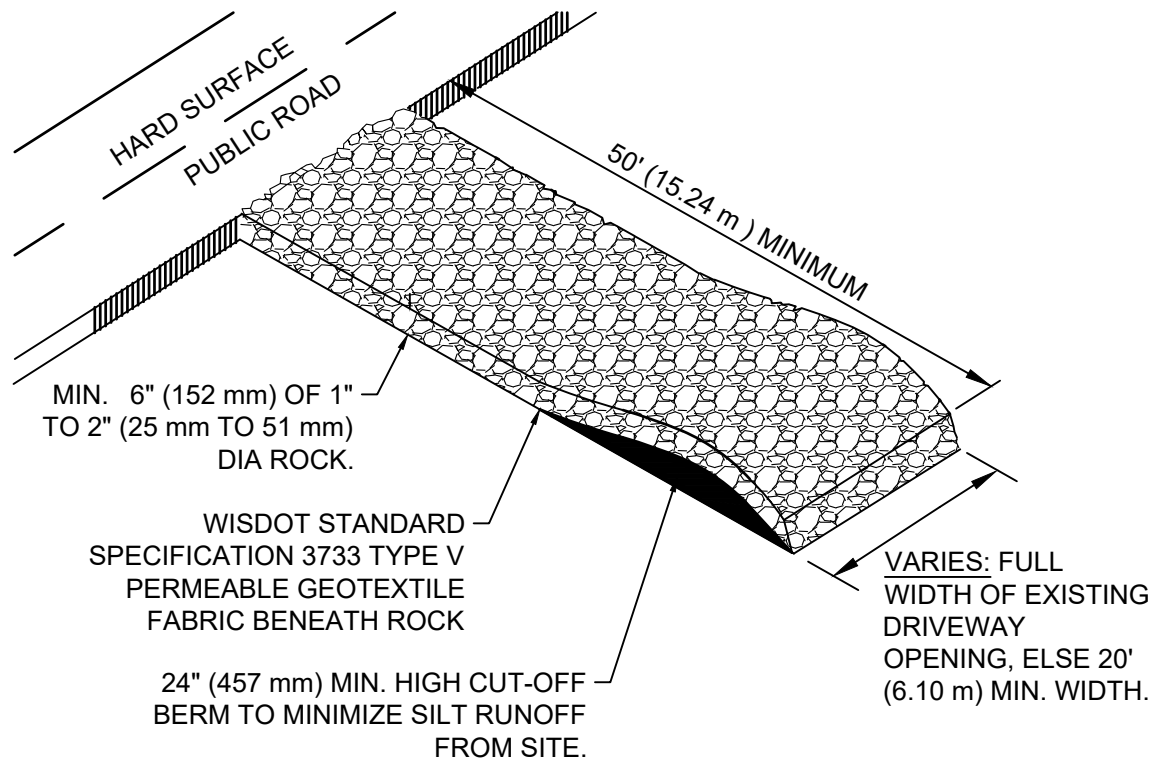
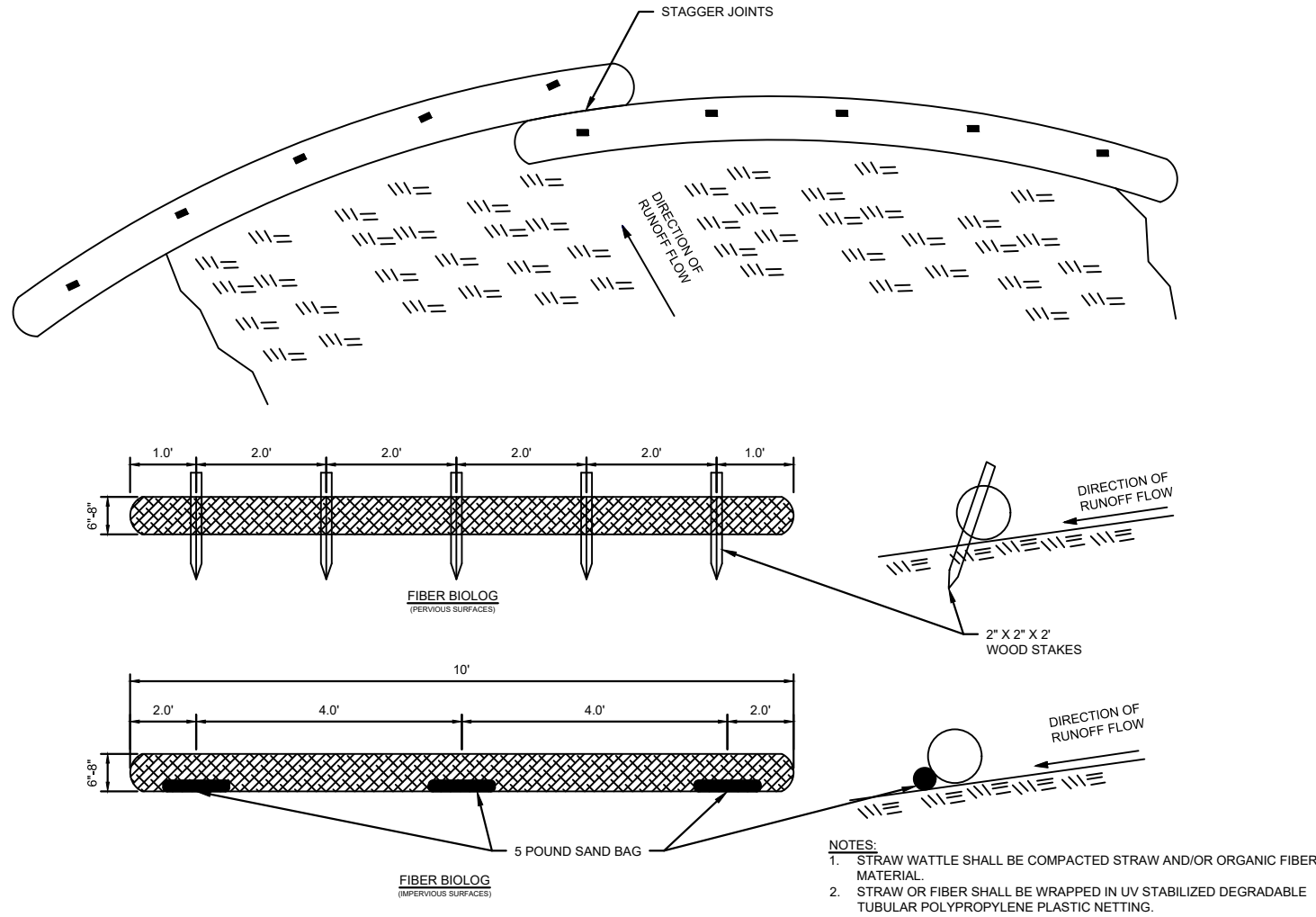

ROCK CONSTRUCTION ENTRANCE
NO SCALE

PRELIMINARY - NOT FOR CONSTRUCTION

CHASE BANK-
WAUWATOSA
PREPARED FOR
THE ARCHITECTS
PARTNERSHIP
WAUWATOSA

EROSION AND
SEDIMENT
CONTROL DETAILS

KHA PROJECT	160094046.1
DATE	XX/XX/XXXX
SCALE	AS SHOWN
DESIGNED BY	MTL
DRAWN BY	BSK
CHECKED BY	TJS

2023 KIMLEY-HORN AND ASSOCIATES, INC.
767 EUSTIS STREET, SUITE 100, ST. PAUL, MN 55114
PHONE 651-445-4197
WWW.KIMLEY-HORN.COM

No.	REVISIONS	DATE	BY

This document, together with the concepts and designs presented herein, as an instrument of service, is intended only for the specific purpose and client for which it was prepared. Reuse of and improper reliance on this document without written authorization and adaptation by Kimley-Horn and Associates, Inc. shall be without liability to Kimley-Horn and Associates, Inc.

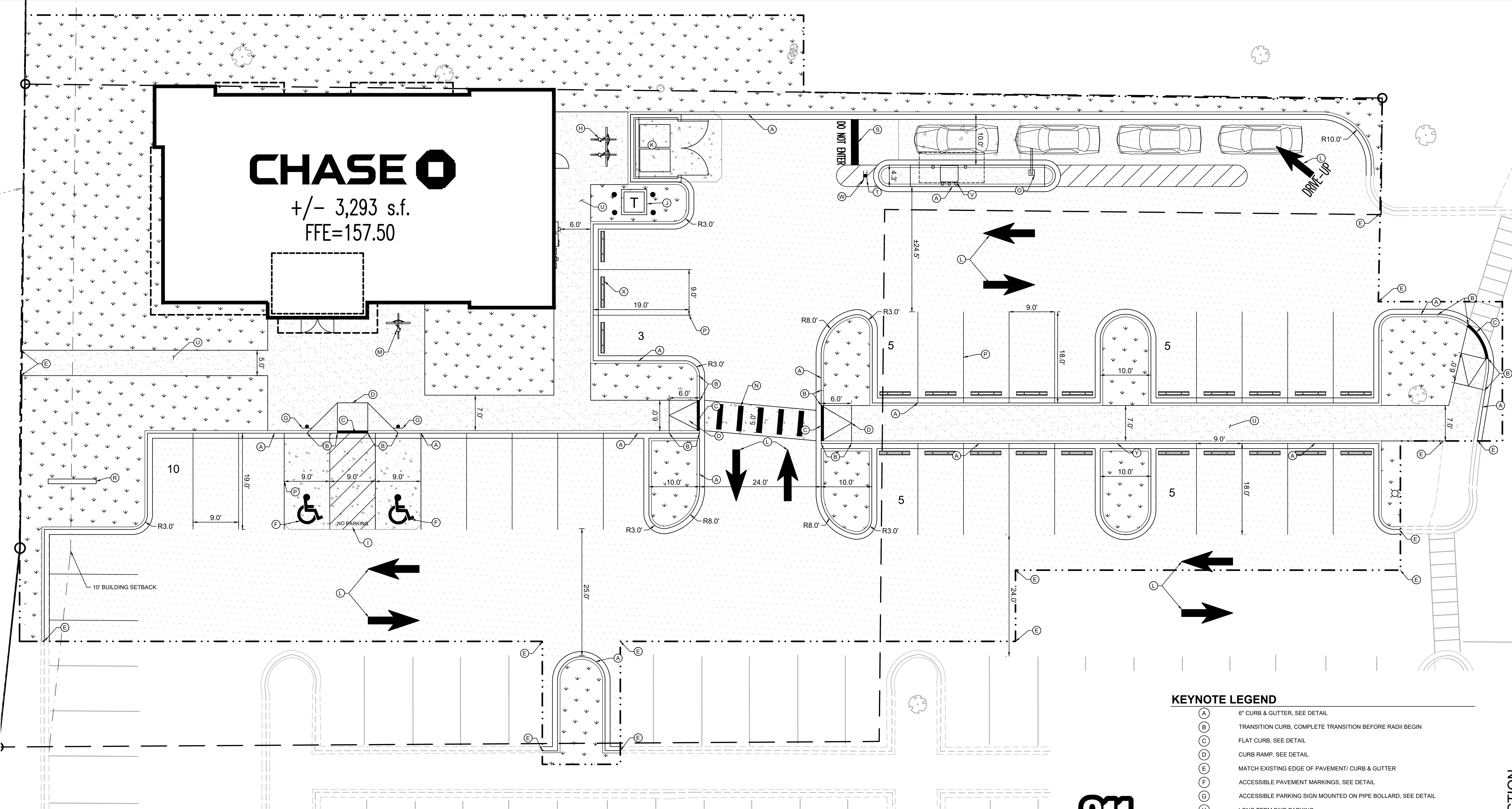

BUILDING DATA	
TOTAL BUILDING AREA	3,293 SF
PERCENT OF TOTAL PROPERTY AREA	13.53%
MAXIMUM BUILDING HEIGHT	NO MAX
PARKING SUMMARY	
REQUIRED PARKING	13 SPACES @ 4/1,000 SF
TOTAL PROPOSED PARKING	13 BANK SPACES LOSS OF 41 SPACES TOTAL
REQUIRED ACCESSIBLE PARKING	1 STANDARD SPACES 1 VAN ACCESSIBLE
PROPOSED ACCESSIBLE PARKING	2 VAN ACCESSIBLE SPACES

PROPERTY SUMMARY	
TOTAL PROPERTY AREA	0.56 AC / 24,330 SF
DISTURBED AREA	0.72 AC / 31,461 SF
EXISTING IMPERVIOUS AREA	0.494 AC / 21,852 SF / 89.94%
EXISTING PERVIOUS AREA	0.056 AC / 2,448 SF / 10.06%
PROPOSED IMPERVIOUS AREA	0.471 AC / 20,453 SF / 84.07%
PROPOSED PERVIOUS AREA	0.089 AC / 3,877 SF / 15.93%
NET DECREASE IN IMPERVIOUS AREA	0.032 AC / 1,399 SF
SITE DATA	
EXISTING ZONING	M1 (LIGHT INDUSTRIAL)
PROPOSED LAND USE	FINANCIAL SERVICES
PARKING SETBACKS	SIDE/REAR = 0' RIGHT OF WAY = 0'
BUILDING SETBACKS	FRONT = 10' SIDE = 10' REAR = 25'

SITE PLAN NOTES

- REFER TO THE ARCHITECTURAL PLANS FOR EXACT LOCATIONS AND DIMENSIONS OF STOOPS, TRUCK DOCKS, TRASH ENCLOSURES & PRECISE BUILDING DIMENSIONS. REFER TO THE SITE ELECTRICAL PLAN FOR LOCATIONS OF PROPOSED LIGHT POLES, CONDUITS, AND ELECTRICAL EQUIPMENT.
- REFER TO CERTIFIED SITE SURVEY OR PLAT FOR EXACT LOCATION OF EXISTING EASEMENTS, PROPERTY BOUNDARY DIMENSIONS, AND ADJACENT RIGHT-OF-WAY & PARCEL INFORMATION.
- DIMENSIONS AND RADII ARE DRAWN TO THE FACE OF CURB, UNLESS OTHERWISE NOTED. DIMENSIONS ARE ROUNDED TO THE NEAREST TENTH FOOT, AND AREAS ARE ROUNDED TO THE NEAREST SQUARE FOOT.
- UNLESS OTHERWISE NOTED, THE CONTRACTOR SHALL BE RESPONSIBLE FOR RELOCATING EXISTING SITE IMPROVEMENTS THAT CONFLICT WITH THE PROPOSED WORK, INCLUDING BUT NOT LIMITED TO TRAFFIC SIGNS, LIGHT POLES, ABOVEGROUND UTILITIES, ETC. PERFORM WORK IN ACCORDANCE WITH GOVERNING AUTHORITIES REQUIREMENTS AND PROJECT SITE WORK SPECIFICATIONS. COST SHALL BE INCLUDED IN BASE BID.
- TYPICAL PARKING STALL DIMENSIONS SHALL BE 9.0-FEET IN WIDTH AND 19-FEET IN LENGTH UNLESS OTHERWISE INDICATED.
- MONUMENT SIGN(S) ARE DETAILED ON THE ARCHITECTURAL PLANS AND ARE SHOWN FOR GRAPHICAL & INFORMATIONAL PURPOSES ONLY. CONTRACTOR TO VERIFY SIGN DIMENSIONS, LOCATION AND REQUIRED PERMITS WITH THE OWNER.
- LONG TERM BIKE PARKING DIMENSIONS SHALL BE 2.0-FEET IN WIDTH AND 7.0-FEET IN LENGTH.

LEGEND

	PROPERTY LINE
	SETBACK LINE
	DRAINAGE AND UTILITY EASEMENT
	PROPOSED LEASED PARCEL LINE
	PROPOSED FLUSH CURB
	PROPOSED CURB AND GUTTER
	PROPOSED STANDARD DUTY ASPHALT
	PROPOSED CONCRETE PAVEMENT
	PROPOSED CONCRETE SIDEWALK
	LIMITS OF DISTURBANCE

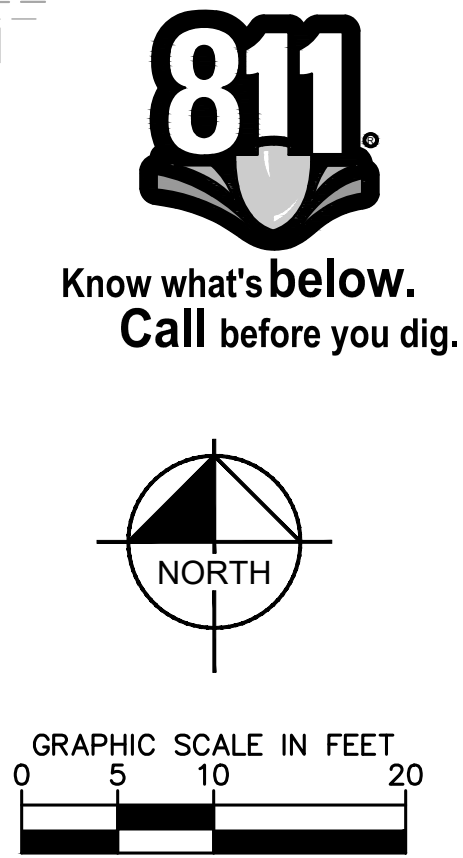

KEYNOTE LEGEND

(A)	6" CURB & GUTTER, SEE DETAIL
(B)	TRANSITION CURB, COMPLETE TRANSITION BEFORE RADII BEGIN
(C)	FLAT CURB, SEE DETAIL
(D)	CURB RAMP, SEE DETAIL
(E)	MATCH EXISTING EDGE OF PAVEMENT/ CURB & GUTTER
(F)	ACCESSIBLE PAVEMENT MARKINGS, SEE DETAIL
(G)	ACCESSIBLE PARKING SIGN MOUNTED ON PIPE BOLLARD, SEE DETAIL
(H)	LONG TERM BIKE PARKING
(I)	AREA STRIPED WITH 4" SYSL @ 45° 2' O.C.
(J)	TRANSFORMER PAD WITH BOLLARDS (FOR REFERENCE ONLY)
(K)	TRASH ENCLOSURE CONTAINER (SEE ARCH PLANS FOR DETAILS)
(L)	TRAFFIC FLOW PAVEMENT MARKINGS
(M)	PROPOSED BIKE RACKS (SEE ARCH PLANS FOR DETAILS)
(N)	ACCESSIBLE CROSSWALK (SEE DETAIL)
(O)	HEADACHE BAR (SEE ARCH PLANS FOR DETAILS)
(P)	4" WIDE PAINTED SOLID LINE (TYP)
(Q)	SITE DIRECTIONAL SIGN (SEE ARCH PLANS FOR DETAIL)
(R)	PROPOSED ILLUMINATED MONUMENT SIGN (SEE ARCH PLANS FOR DETAILS)
(S)	PAINTED "DO NOT ENTER" MARKING
(T)	STOP SIGN
(U)	CONCRETE SIDEWALK (TYP.) (SEE DETAIL)
(V)	PROPOSED DRIVE-UP ATM (SEE ARCH PLANS FOR DETAIL)
(W)	"DO NOT ENTER" SIGN
(X)	WHEEL STOP, SEE DETAIL
(Y)	1" STANDING CURB

PRELIMINARY - NOT FOR CONSTRUCTION

CHASE BANK-
WAUWATOSA
PREPARED FOR
THE ARCHITECTS
PARTNERSHIP
WAUWATOSA

SITE DIMENSION
PLAN

KHA PROJECT	160094046.1
DATE	XX/XX/XXXX
SCALE	AS SHOWN
DESIGNED BY	MTL
DRAWN BY	BSK
CHECKED BY	TJS

Kimley»Horn

© 2023 KIMLEY-HORN AND ASSOCIATES, INC.
787 EUSTIS STREET, SUITE 100, ST. PAUL, MN 55114
PHONE 651-945-4197
WWW.KIMLEY-HORN.COM

REVISIONS		BY
No.	DATE	

SHEET NUMBER
C400

k:\TWC_LDEV\THE ARCHITECTS PARTNERSHIP\Wauwatosa, WI- Chase Bank\3 Design\CAD\PlanSheets\C5-GRADING PLAN.dwg September 06, 2023 - 2:15pm

This document, together with the concepts and designs presented herein, as an instrument of service, is intended only for the specific purpose and client for which it was prepared. Reuse of and improper reliance on this document without written authorization and adaptation by Kimley-Horn and Associates, Inc. shall be without liability to Kimley-Horn and Associates, Inc.

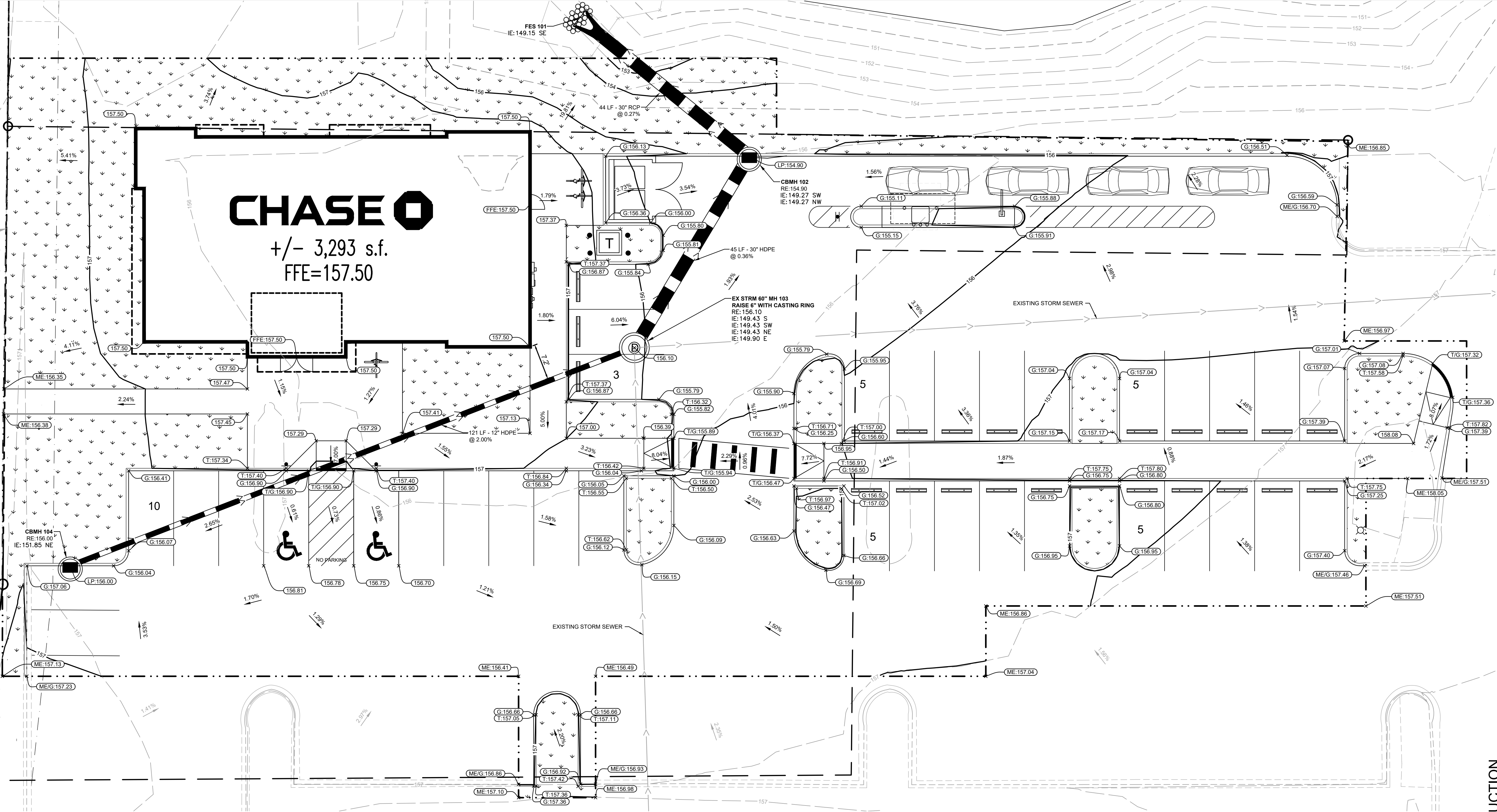

GRADING PLAN NOTES

- PERFORM GRADING WORK IN ACCORDANCE WITH APPLICABLE CITY SPECIFICATIONS AND BUILDING PERMIT REQUIREMENTS.
- CONTACT STATE 811 CALL-BEFORE-YOU-DIG LOCATING SERVICE AT LEAST TWO WORKING DAYS PRIOR TO EXCAVATION FOR UNDERGROUND UTILITY LOCATIONS.
- STORM SEWER PIPE SHALL BE AS FOLLOWS:
RCP PER ASTM C-76
HDPE: 0' - 10' PER AASHTO M-252
HDPE: 12" OR GREATER PER ASTM F-2306
PVC SCH. 40 PER ASTM D-1785
STORM SEWER FITTINGS SHALL BE AS FOLLOWS:
RCP PER ASTM C-76, JOINTS PER ASTM C-361, C-990, AND C-443
HDPE PER ASTM 3212
PVC PER ASTM D-3034, JOINTS PER ASTM D-3212
- CONTRACTOR TO FIELD VERIFY THE LOCATIONS AND ELEVATIONS OF EXISTING UTILITIES AND TOPOGRAPHIC FEATURES PRIOR TO THE START OF SITE GRADING. THE CONTRACTOR SHALL IMMEDIATELY NOTIFY THE PROJECT ENGINEER OF ANY DISCREPANCIES OR VARIATIONS.
- SUBGRADE EXCAVATION SHALL BE BACKFILLED IMMEDIATELY AFTER EXCAVATION TO HELP OFFSET ANY STABILITY PROBLEMS DUE TO WATER SEEPAGE OR STEEP SLOPES. WHEN PLACING NEW SURFACE MATERIAL ADJACENT TO EXISTING PAVEMENT, THE EXCAVATION SHALL BE BACKFILLED PROMPTLY TO AVOID UNDERMINING OF EXISTING PAVEMENT.
- CONTRACTOR SHALL BE RESPONSIBLE FOR ALL HORIZONTAL AND VERTICAL CONTROL.
- CONTRACTOR SHALL EXCAVATE DRAINAGE TRENCHES TO FOLLOW PROPOSED STORM SEWER ALIGNMENTS.
- GRADES SHOWN ARE FINISHED GRADES. CONTRACTOR SHALL ROUGH GRADE TO SUBGRADE ELEVATION AND

LEAVE STREET READY FOR SUBBASE.

- ALL EXCESS MATERIAL, BITUMINOUS SURFACING, CONCRETE ITEMS, ANY ABANDONED UTILITY ITEMS, AND OTHER UNSTABLE MATERIALS SHALL BECOME THE PROPERTY OF THE CONTRACTOR AND SHALL BE DISPOSED OF OFF THE CONSTRUCTION SITE.
- REFER TO THE UTILITY PLAN FOR SANITARY SEWER MAIN, WATER MAIN SERVICE LAYOUT AND ELEVATIONS AND CASTING / STRUCTURE NOTATION.
- CONTRACTOR IS RESPONSIBLE FOR CONSTRUCTION OF PAVEMENTS AND CURB AND GUTTER WITH SMOOTH UNIFORM SLOPES TO PROVIDE POSITIVE DRAINAGE.
- INSTALL A MINIMUM OF 4" CLASS 5 AGGREGATE BASE UNDER CURB AND GUTTER AND CONCRETE SIDEWALKS.
- UPON COMPLETION OF EXCAVATION AND FILLING, CONTRACTOR SHALL RESTORE ALL STREETS AND DISTURBED AREAS ON SITE. ALL DISTURBED AREAS SHALL BE RE-VEGETATED WITH A MINIMUM OF 4" OF TOPSOIL.
- ALL SPOT ELEVATIONS/CONTOURS ARE TO GUTTER / FLOW LINE UNLESS OTHERWISE NOTED.
- GRADING FOR ALL SIDEWALKS AND ACCESSIBLE ROUTES INCLUDING CROSSING DRIVEWAYS SHALL CONFORM TO CURRENT ADA STATE/NATIONAL STANDARDS. IN NO CASE SHALL ACCESSIBLE RAMP SLOPES EXCEED 1:12 VERTICAL TO 12 HORIZONTAL. IN NO CASE SHALL SIDEWALK CROSS SLOPES EXCEED 2%. IN NO CASE SHALL LONGITUDINAL SIDEWALK SLOPES EXCEED 5%. IN NO CASE SHALL ACCESSIBLE PARKING STALLS OR AISLES EXCEED 2% (1.5% TARGET) IN ALL DIRECTIONS. SIDEWALK ACCESS TO EXTERNAL BUILDING DOORS AND GATES SHALL BE ADA COMPLIANT. CONTRACTOR SHALL NOTIFY ENGINEER IMMEDIATELY IF ADA CRITERIA CANNOT BE MET IN ANY LOCATION PRIOR TO PAVING. NO CONTRACTOR CHANGE ORDERS WILL BE ACCEPTED FOR A.D.A. COMPLIANCE ISSUES.
- MAINTAIN A MINIMUM OF 0.5% GUTTER SLOPE TOWARDS LOW POINTS.

- CONTRACTOR TO PROVIDE 3" INSULATION BY 5' WIDE CENTERED ON STORM PIPE IF LESS THAN 4' OF COVER IN PAVEMENT AREAS AND LESS THAN 3' OF COVER IN LANDSCAPE AREAS.
- ROOF DRAIN INVERT CONNECTIONS AT THE BUILDING SHALL BE AT ELEVATION <XXX.XX> OR LOWER UNLESS NOTED OTHERWISE. REFERENCE MEP PLANS FOR ROOF DRAIN CONNECTION.
- ALL STORM SEWER CONNECTIONS SHALL BE GASKETED AND WATER TIGHT INCLUDING MANHOLE CONNECTIONS.
- ALL STORM SEWER PIPE SHALL BE AIR TESTED IN ACCORDANCE WITH THE CURRENT PLUMBING CODE.
- MAINTAIN A MINIMUM OF 1.25% SLOPE IN BITUMINOUS PAVEMENT AREAS, 0.5% SLOPE IN CONCRETE PAVEMENT AREAS.
- CONTRACTOR SHALL REVIEW PAVEMENT GRADIENT AND CONSTRUCT "INFALL CURB" WHERE PAVEMENT DRAINS TOWARD GUTTER, AND "OUTFALL" CURB WHERE PAVEMENT DRAINS AWAY FROM GUTTER.



Know what's below.
Call before you dig.

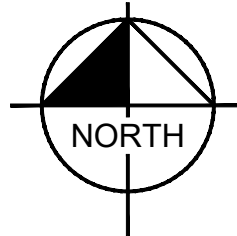

GRAPHIC SCALE IN FEET
0 5 10 20

LEGEND

---	PROPERTY LINE
---	EXISTING CONTOUR
---	PROPOSED CONTOUR
---	PROPOSED RIDGE LINE
---	PROPOSED SWALE
○	PROPOSED STORM MANHOLE (SOLID CASTING)
●	PROPOSED STORM MANHOLE (ROUND INLET CASTING)
○	PROPOSED STORM MANHOLE/ CATCH BASIN (CURB INLET CASTING)
○	PROPOSED STORM SEWER CLENOUT
○	PROPOSED FLARED END SECTION
○	PROPOSED RIPRAP
○	PROPOSED STORM SEWER
○	PROPOSED SPOT ELEVATION
○	PROPOSED HIGH POINT ELEVATION
○	PROPOSED LOW POINT ELEVATION
○	PROPOSED GUTTER ELEVATION
○	PROPOSED TOP OF CURB ELEVATION
○	PROPOSED FLUSH PAVEMENT ELEVATION
○	MATCH EXISTING ELEVATION
○	PROPOSED EMERGENCY OVERFLOW ELEVATION
○	PROPOSED TOP/BOTTOM OF WALL ELEVATION
○	PROPOSED DRAINAGE DIRECTION
○	PROPOSED ADA SLOPE

PRELIMINARY - NOT FOR CONSTRUCTION

CHASE BANK-
WAUWATOSA
PREPARED FOR
THE ARCHITECTS
PARTNERSHIP
WAUWATOSA

GRADING AND
DRAINAGE PLAN

KHA PROJECT
160094046.T
DATE
XX/XX/XXXX
SCALE
AS SHOWN
DESIGNED BY
MTL
DRAWN BY
BSK
CHECKED BY
TJS

Kimley»Horn

© 2023 KIMLEY-HORN AND ASSOCIATES, INC.
767 EUSTIS STREET, SUITE 100, ST. PAUL, MN 55114
PHONE 651-445-4197
WWW.KIMLEY-HORN.COM

No.	REVISIONS	DATE	BY

SHEET NUMBER
C500

- LEAVE STREET READY FOR SUBBASE.
9. ALL EXCESS MATERIAL, BITUMINOUS SURFACING, CONCRETE ITEMS, & OTHER UNSTABLE MATERIALS SHALL BECOME THE PROPERTY OF THE OFF THE CONSTRUCTION SITE.
10. REFER TO THE UTILITY PLAN FOR SANITARY SEWER MAIN, WATER MAIN CASTING / STRUCTURE NOTATION.
11. CONTRACTOR IS RESPONSIBLE FOR CONSTRUCTION OF PAVEMENTS UNIFORM SLOPES TO PROVIDE POSITIVE DRAINAGE.
12. INSTALL A MINIMUM OF 4" CLASS 5 AGGREGATE BASE UNDER CURB AND GUTTER.
13. UPON COMPLETION OF EXCAVATION AND FILLING, CONTRACTOR SHALL AREAS ON SITE. ALL DISTURBED AREAS SHALL BE RE-VEGETATED WITH GRASS.
14. ALL SPOT ELEVATIONS/CONTOURS ARE TO GUTTER / FLOW LINE UNLESS OTHERWISE NOTED.
15. GRADING FOR ALL SIDEWALKS AND ACCESSIBLE ROUTES INCLUDING TO CURRENT ADA STATE/NATIONAL STANDARDS. IN NO CASE SHALL A VERTICAL TO 12 HORIZONTAL, IN NO CASE SHALL SIDEWALK CROSS SLOPE EXCEED 1% (1.0% MAXIMUM). IN NO CASE SHALL SIDEWALK SLOPE EXCEED 2% (1.5% TARGET) IN ANY DIRECTIONS. SIDEWALK ACCESS TO CURB SHALL BE ADA COMPLIANT. CONTRACTOR SHALL NOTIFY ENGINEER IN WRITING OF ANY LOCATION PRIOR TO PAVING. NO CONTRACTOR CHANGE OF COMPLIANCE ISSUES.
16. MAINTAIN A MINIMUM OF 0.5% GUTTER SLOPE TOWARDS LOW POINTS.

9. ALL EXCESS MATERIAL, BITUMINOUS SURFACING, CONCRETE ITEMS, ANY ABANDONED UTILITY ITEMS, AND OTHER UNSTABLE MATERIALS SHALL BECOME THE PROPERTY OF THE CONTRACTOR AND SHALL BE DISPOSED OF OFF THE CONSTRUCTION SITE.
10. REFER TO THE UTILITY PLAN FOR SANITARY SEWER MAIN, WATER MAIN SERVICE LAYOUT AND ELEVATIONS AND CASTING / STRUCTURE NOTATION.
11. CONTRACTOR IS RESPONSIBLE FOR CONSTRUCTION OF PAVEMENTS AND CURB AND GUTTER WITH SMOOTH UNIFORM SLOPES TO PROVIDE POSITIVE DRAINAGE.
12. INSTALL A MINIMUM OF 4" CLASS 5 AGGREGATE BASE UNDER CURB AND GUTTER AND CONCRETE SIDEWALKS.
13. UPON COMPLETION OF EXCAVATION AND FILLING, CONTRACTOR SHALL RESTORE ALL STREETS AND DISTURBED AREAS ON SITE. ALL DISTURBED AREAS SHALL BE RE-VEGETATED WITH A MINIMUM OF 4" OF TOPSOIL.
14. ALL SPOT ELEVATIONS/CONTOURS ARE TO GUTTER / FLOW LINE UNLESS OTHERWISE NOTED.
15. GRADING FOR ALL SIDEWALKS AND ACCESSIBLE ROUTES INCLUDING CROSSING DRIVEWAYS SHALL CONFORM TO CURRENT ADA STATE/NATIONAL STANDARDS. IN NO CASE SHALL ACCESSIBLE RAMP SLOPES EXCEED 1 VERTICAL TO 12 HORIZONTAL. IN NO CASE SHALL SIDEWALK CROSS SLOPES EXCEED 2% . IN NO CASE SHALL LONGITUDINAL SIDEWALK SLOPES EXCEED 5% . IN NO CASE SHALL ACCESSIBLE PARKING STALLS OR AISLES EXCEED 1% (1.5% TARGET) IN ALL DIRECTIONS. SIDEWALK ACCESS TO EXTERNAL BUILDING DOORS AND GATES SHALL BE ADA COMPLIANT. CONTRACTOR SHALL NOTIFY ENGINEER IMMEDIATELY IF A ADA CRITERIA CANNOT BE MET IN ANY LOCATION PRIOR TO PAVING. NO CONTRACTOR CHANGE ORDERS WILL BE ACCEPTED FOR A.D.A COMPLIANCE ISSUES.
16. MAINTAIN A MINIMUM OF 0.5% GUTTER SLOPE TOWARDS LOW POINTS.

- 

A graphic scale in feet is shown below the map, with markings for 0, 2.5, 5, and 10 feet. Above the scale is a north arrow pointing upwards, with the word "NORTH" written inside the circle.

PRELIMINARY - NOT FOR CONSTRUCTION

**CHASE BANK-
WAUWATOSA
PREPARED FOR
THE ARCHITECTS
PARTNERSHIP
ATOSA**

SHEET NUMBER
C501

Kimley»»Horn

© 2023 KIMLEY-HORN AND ASSOCIATES, INC.
767 EUSTIS STREET, SUITE 100, ST. PAUL, MN 55114
PHONE: 651-645-4197
WWW.KIMLEY-HORN.COM

No.	REVISIONS	DATE	BY
-----	-----------	------	----

- LEAVE STREET READY FOR SUBBASE.
9. ALL EXCESS MATERIAL, BITUMINOUS SURFACING, CONCRETE ITEMS, & OTHER UNSTABLE MATERIALS SHALL BECOME THE PROPERTY OF THE OFF THE CONSTRUCTION SITE.
10. REFER TO THE UTILITY PLAN FOR SANITARY SEWER MAIN, WATER MAIN CASTING / STRUCTURE NOTATION.
11. CONTRACTOR IS RESPONSIBLE FOR CONSTRUCTION OF PAVEMENTS UNIFORM SLOPES TO PROVIDE POSITIVE DRAINAGE.
12. INSTALL A MINIMUM OF 4" CLASS 5 AGGREGATE BASE UNDER CURB AND GUTTER.
13. UPON COMPLETION OF EXCAVATION AND FILLING, CONTRACTOR SHALL AREAS ON SITE. ALL DISTURBED AREAS SHALL BE RE-VEGETATED WITH SEED.
14. ALL SPOT ELEVATIONS/CONTOURS ARE TO GUTTER / FLOW LINE UNLESS OTHERWISE NOTED.
15. GRADING FOR ALL SIDEWALKS AND ACCESSIBLE ROUTES INCLUDING TO CURRENT ADA STATE/NATIONAL STANDARDS. IN NO CASE SHALL A VERTICAL TO 12 HORIZONTAL, IN NO CASE SHALL SIDEWALK CROSS SLOPE EXCEED 1% (1:12), IN NO CASE SHALL SIDEWALK SLOPE EXCEED 2% (1:5) TARGET IN ANY DIRECTIONS. SIDEWALK ACCESS TO SIDEWALK SHALL BE ADA COMPLIANT. CONTRACTOR SHALL NOTIFY ENGINEER IN WRITING IN ANY LOCATION PRIOR TO PAVING. NO CONTRACTOR CHANGE OF COMPLIANCE ISSUES.
16. MAINTAIN A MINIMUM OF 0.5% GUTTER SLOPE TOWARDS LOW POINTS.

9. ALL EXCESS MATERIAL, BITUMINOUS SURFACING, CONCRETE ITEMS, ANY ABANDONED UTILITY ITEMS, AND OTHER UNSTABLE MATERIALS SHALL BECOME THE PROPERTY OF THE CONTRACTOR AND SHALL BE DISPOSED OF OFF THE CONSTRUCTION SITE.
10. REFER TO THE UTILITY PLAN FOR SANITARY SEWER MAIN, WATER MAIN SERVICE LAYOUT AND ELEVATIONS AND CASTING / STRUCTURE NOTATION.
11. CONTRACTOR IS RESPONSIBLE FOR CONSTRUCTION OF PAVEMENTS AND CURB AND GUTTER WITH SMOOTH UNIFORM SLOPES TO PROVIDE POSITIVE DRAINAGE.
12. INSTALL A MINIMUM OF 4" CLASS 5 AGGREGATE BASE UNDER CURB AND GUTTER AND CONCRETE SIDEWALKS.
13. UPON COMPLETION OF EXCAVATION AND FILLING, CONTRACTOR SHALL RESTORE ALL STREETS AND DISTURBED AREAS ON SITE. ALL DISTURBED AREAS SHALL BE RE-VEGETATED WITH A MINIMUM OF 4" OF TOPSOIL.
14. ALL SPOT ELEVATIONS/CONTOURS ARE TO GUTTER / FLOW LINE UNLESS OTHERWISE NOTED.
15. GRADING FOR ALL SIDEWALKS AND ACCESSIBLE ROUTES INCLUDING CROSSING DRIVEWAYS SHALL CONFORM TO CURRENT ADA STATE/NATIONAL STANDARDS. IN NO CASE SHALL ACCESSIBLE RAMP SLOPES EXCEED 1 VERTICAL TO 12 HORIZONTAL. IN NO CASE SHALL SIDEWALK CROSS SLOPES EXCEED 2% . IN NO CASE SHALL LONGITUDINAL SIDEWALK SLOPES EXCEED 5% . IN NO CASE SHALL ACCESSIBLE PARKING STALLS OR AISLES EXCEED 1% (1.5% TARGET) IN ALL DIRECTIONS. SIDEWALK ACCESS TO EXTERNAL BUILDING DOORS AND GATES SHALL BE ADA COMPLIANT. CONTRACTOR SHALL NOTIFY ENGINEER IMMEDIATELY IF A ADA CRITERIA CANNOT BE MET IN ANY LOCATION PRIOR TO PAVING. NO CONTRACTOR CHANGE ORDERS WILL BE ACCEPTED FOR A.D.A COMPLIANCE ISSUES.
16. MAINTAIN A MINIMUM OF 0.5% GUTTER SLOPE TOWARDS LOW POINTS.

- 

PRELIMINARY - NOT FOR CONSTRUCTION

**CHASE BANK-
WAUWATOSA
PREPARED FOR
THE ARCHITECTS
PARTNERSHIP
ATOSA**

SHEET NUMBER
C502

KHA PROJECT 160094046.1	DATE XX/XX/XXXX	SCALE AS SHOWN	DESIGNED BY MTL	DRAWN BY BSK	CHECKED BY TJS
----------------------------	--------------------	----------------	-----------------	--------------	----------------

© 2023 KIMLEY-HORN AND ASSOCIATES, INC.
767 EUSTIS STREET, SUITE 100, ST. PAUL, MN 55114
PHONE: 651-645-4197
WWW.KIMLEY-HORN.COM

No.	REVISIONS	DATE	BY
-----	-----------	------	----

- LEAVE STREET READY FOR SUBBASE.
9. ALL EXCESS MATERIAL, BITUMINOUS SURFACING, CONCRETE ITEMS, & OTHER UNSTABLE MATERIALS SHALL BECOME THE PROPERTY OF THE OFF THE CONSTRUCTION SITE.
10. REFER TO THE UTILITY PLAN FOR SANITARY SEWER MAIN, WATER MAIN CASTING / STRUCTURE NOTATION.
11. CONTRACTOR IS RESPONSIBLE FOR CONSTRUCTION OF PAVEMENTS UNIFORM SLOPES TO PROVIDE POSITIVE DRAINAGE.
12. INSTALL A MINIMUM OF 4" CLASS 5 AGGREGATE BASE UNDER CURB AND GUTTER.
13. UPON COMPLETION OF EXCAVATION AND FILLING, CONTRACTOR SHALL AREAS ON SITE. ALL DISTURBED AREAS SHALL BE RE-VEGETATED WITH GRASS.
14. ALL SPOT ELEVATIONS/CONTOURS ARE TO GUTTER / FLOW LINE UNLESS OTHERWISE NOTED.
15. GRADING FOR ALL SIDEWALKS AND ACCESSIBLE ROUTES INCLUDING TO CURRENT ADA STATE/NATIONAL STANDARDS. IN NO CASE SHALL A VERTICAL TO 12 HORIZONTAL, IN NO CASE SHALL SIDEWALK CROSS SLOPE EXCEED 1% (1:12), IN NO CASE SHALL SIDEWALK CROSS SLOPE EXCEED 2% (1:5) TARGET IN ALL DIRECTIONS. SIDEWALK ACCESS TO SIDEWALK SHALL BE ADA COMPLIANT. CONTRACTOR SHALL NOTIFY ENGINEER IN WRITING IN ANY LOCATION PRIOR TO PAVING. NO CONTRACTOR CHANGE OF COMPLIANCE ISSUES.
16. MAINTAIN A MINIMUM OF 0.5% GUTTER SLOPE TOWARDS LOW POINTS.

- | | | |
|--|---|--|
| LEAVE STREET READY FOR SUBBASE. | | 17. CONTRACTOR TO PROVIDE 3" INSULATION BY 5' WIDE CENTERED ON STORM PIPE IF LESS THAN 4' OF COVER IN PAVEMENT AREAS AND LESS THAN 3' OF COVER IN LANDSCAPE AREAS. |
| 9. ALL EXCESS MATERIAL, BITUMINOUS SURFACING, CONCRETE ITEMS, ANY ABANDONED UTILITY ITEMS, AND OTHER UNSTABLE MATERIALS SHALL BECOME THE PROPERTY OF THE CONTRACTOR AND SHALL BE DISPOSED OF OFF THE CONSTRUCTION SITE. | 18. ROOF DRAIN INVERT CONNECTIONS AT THE BUILDING SHALL BE AT ELEVATION <XXXX> OR LOWER UNLESS NOTED OTHERWISE. REFERENCE MEP PLANS FOR ROOF DRAIN CONNECTION. | |
| 10. REFER TO THE UTILITY PLAN FOR SANITARY SEWER MAIN, WATER MAIN SERVICE LAYOUT AND ELEVATIONS AND CASTING / STRUCTURE NOTATION. | 19. ALL STORM SEWER CONNECTIONS SHALL BE GASKETED AND WATER TIGHT INCLUDING MANHOLE CONNECTIONS | |
| 11. CONTRACTOR IS RESPONSIBLE FOR CONSTRUCTION OF PAVEMENTS AND CURB AND GUTTER WITH SMOOTH UNIFORM SLOPES TO PROVIDE POSITIVE DRAINAGE. | 20. ALL STORM SEWER PIPE SHALL BE AIR TESTED IN ACCORDANCE WITH THE CURRENT PLUMBING CODE. | |
| 12. INSTALL A MINIMUM OF 4" CLASS 5 AGGREGATE BASE UNDER CURB AND GUTTER AND CONCRETE SIDEWALKS. | 21. MAINTAIN A MINIMUM OF 1.25% SLOPE IN BITUMINOUS PAVEMENT AREAS, 0.5% SLOPE IN CONCRETE PAVEMENT AREAS | |
| 13. UPON COMPLETION OF EXCAVATION AND FILLING, CONTRACTOR SHALL RESTORE ALL STREETS AND DISTURBED AREAS ON SITE. ALL DISTURBED AREAS SHALL BE RE-VEGETATED WITH A MINIMUM OF 4" OF TOPSOIL. | 22. CONTRACTOR SHALL REVIEW PAVEMENT GRADIENT AND CONSTRUCT "INFALL CURB" WHERE PAVEMENT DRAINS TOWARD GUTTER, AND "OUTFALL" CURB WHERE PAVEMENT DRAINS AWAY FROM GUTTER. | |
| 14. ALL SPOT ELEVATIONS/CONTOURS ARE TO GUTTER / FLOW LINE UNLESS OTHERWISE NOTED. | | |
| 15. GRADING FOR ALL SIDEWALKS AND ACCESSIBLE ROUTES INCLUDING CROSSING DRIVEWAYS SHALL CONFORM TO CURRENT ADA STATE/NATIONAL STANDARDS. IN NO CASE SHALL ACCESSIBLE RAMP SLOPES EXCEED 1 VERTICAL TO 12 HORIZONTAL. IN NO CASE SHALL SIDEWALK GROSS SLOPES EXCEED 2% . IN NO CASE SHALL SIDEWALK SIDEWALK SLOPE EXCEED 5% . IN NO CASE SHALL ACCESSIBLE PARKING STALLS OR AISLES EXCEED 2% (1.5% TARGET) IN ALL DIRECTIONS. SIDEWALK ACCESS TO EXTERNAL BUILDING DOORS AND GATES SHALL BE ADA COMPLIANT. CONTRACTOR SHALL NOTIFY ENGINEER IMMEDIATELY IF ADA CRITERIA CANNOT BE MET IN ANY LOCATION PRIOR TO PAVING. NO CONTRACTOR CHANGE ORDERS WILL BE ACCEPTED FOR A.D.A COMPLIANCE ISSUES. | | |
| 16. MAINTAIN A MINIMUM OF 0.5% GUTTER SLOPE TOWARDS LOW POINTS. | | |
- 

Know what's below



GRAPHIC SCALE IN FEET

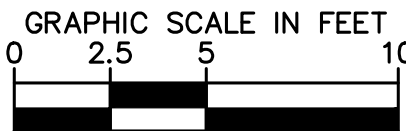

PROPERTY LINE

EXISTING CONTOUR

PROPOSED CONTOUR

PROPOSED RIDGE LINE

PROPOSED SWALE

PROPOSED STORM MANHOLE (SOLID CASTING)

PROPOSED STORM MANHOLE (ROUND INLET CASTING)

PROPOSED STORM MANHOLE/ CATCH BASIN (CURB INLET CASTING)

PROPOSED STORM SEWER CLEINOUT

PROPOSED FLARED END SECTION

PROPOSED RIPRAP

PROPOSED STORM SEWER

PROPOSED SPOT ELEVATION

PROPOSED HIGH POINT ELEVATION

PROPOSED LOW POINT ELEVATION

PROPOSED GUTTER ELEVATION

PROPOSED TOP OF CURB ELEVATION

PROPOSED FLUSH PAVEMENT ELEVATION

MATCH EXISTING ELEVATION

PROPOSED EMERGENCY OVERFLOW ELEVATION

PROPOSED TOP/BOTTOM OF WALL ELEVATION

PROPOSED DRAINAGE DIRECTION

PROPOSED ADA SLOPE

SHEET NUMBER
C503

KHA PROJECT 160094046.1	DATE XX/XX/XXXX	SCALE AS SHOWN	DESIGNED BY MTL	DRAWN BY BSK	CHECKED BY TJS
----------------------------	--------------------	----------------	-----------------	--------------	----------------

© 2023 KIMLEY-HORN AND ASSOCIATES, INC.
767 EUSTIS STREET, SUITE 100, ST. PAUL, MN 55114
PHONE: 651-645-4197
WWW.KIMLEY-HORN.COM

No.	REVISIONS	DATE	BY
-----	-----------	------	----

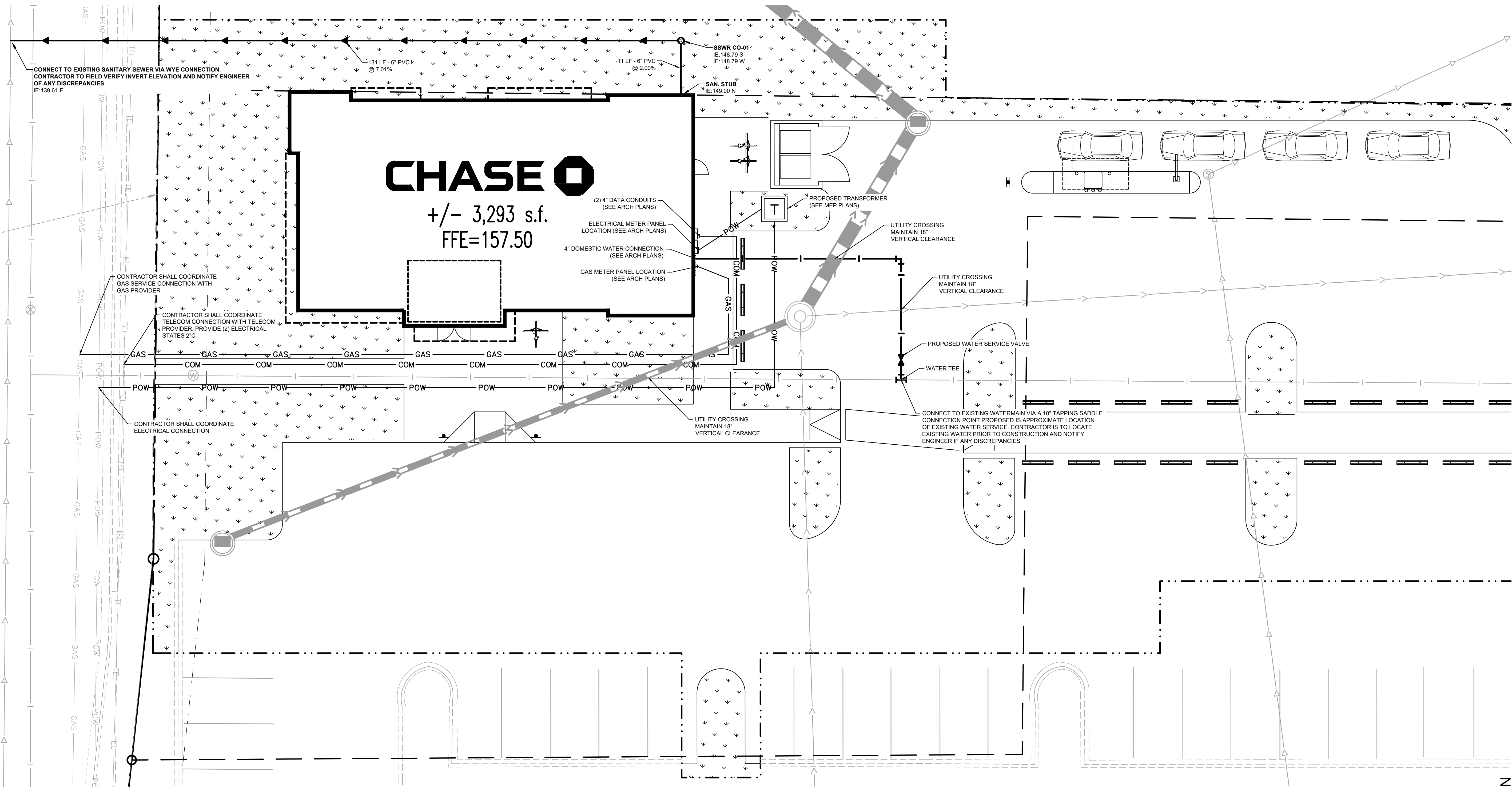

UTILITY PLAN NOTES

- INSTALL UTILITIES IN ACCORDANCE WITH APPLICABLE CITY SPECIFICATIONS, STATE PLUMBING CODE, AND BUILDING PERMIT REQUIREMENTS.
- CONTACT STATE 811 CALL-BEFORE-YOU-DIG LOCATING SERVICE AT LEAST TWO WORKING DAYS PRIOR TO EXCAVATION FOR UNDERGROUND UTILITY LOCATIONS.
- CONTRACTOR IS RESPONSIBLE FOR ALL HORIZONTAL AND VERTICAL CONTROL.
- SANITARY SEWER PIPE SHALL BE:
PVC: ASTM D-2729, D-3034
PVC SCH 40: ASTM D-1785, F-714, F-894
SANITARY SEWER FITTINGS SHALL BE:
PVC: ASTM D-2729, D-3034
PVC SCH40: ASTM D-2665, F-2794, F-1866
- WATER MAIN PIPE SHALL BE:
PVC: ASTM D-1785, D-2241, AWWA C-900
DUCTILE IRON: AWWA C115
WATER MAIN FITTINGS SHALL BE:
PVC: ASTM D-2665, D-2466, D-2467, F-1970, AWWA C-907
DUCTILE IRON: AWWA C-153, C-110, ASME 316.4
- STORM SEWER PIPE SHALL BE:
RCP: ASTM C-76
HDPE: ASTM F-714, F-894
PVC: ASTM D-2729
PVC SCH40: ASTM D-1785, D-2665, F-794
DRAIN TILE SHALL BE:
PE: ASTM F-6967
PVC: ASTM D-2729
STORM SEWER FITTINGS SHALL BE:
RCP: ASTM C-76, JOINTS PER ASTM C-361, C-990, AND C-443
HDPE: ASTM D-3212
PVC: ASTM D-2729, JOINTS PER ASTM D-3212
PVC SCH40: ASTM D-2665, F-794, F-1866
- WHEN CONNECTING TO AN EXISTING UTILITY LINE, FIELD VERIFY THE LOCATION, DEPTH, AND SIZE OF THE

- EXISTING PIPE(S) PRIOR TO INSTALLATION OF THE NEW LINES. NOTIFY THE PROJECT ENGINEER OF ANY DISCREPANCIES OR VARIATIONS IMPACTING THE PROPOSED DESIGN OF THE PROJECT.
- PLACE AND COMPACT ALL FILL MATERIAL PRIOR TO INSTALLATION OF PROPOSED UNDERGROUND UTILITIES. MINIMUM TRENCH WIDTH SHALL BE 2 FEET.
- MAINTAIN A MINIMUM OF 7'-6" COVER ON ALL WATER LINES.
- FOR WATER LINES AND STUB-OUTS UTILIZE MECHANICAL JOINTS WITH RESTRAINTS SUCH AS THRUST BLOCKING, WITH STAINLESS STEEL OR COBALT BLUE BOLTS, OR AS INDICATED IN THE CITY SPECIFICATIONS AND PROJECT DOCUMENTS.
- MAINTAIN 18-INCH MINIMUM VERTICAL SEPARATION WHERE SEWER PIPE CROSSES WATER LINES (OUTSIDE EDGE OF PIPE TO OUTSIDE EDGE OF PIPE OR STRUCTURE). PROVIDE 10-FOOT HORIZONTAL SEPARATION BETWEEN SEWER PIPE AND WATER LINES.
- IN THE EVENT OF A VERTICAL CONFLICT BETWEEN WATER LINES, SANITARY LINES, STORM LINES AND GAS LINES (OR ANY OBSTRUCTION EXISTING AND PROPOSED), THE SANITARY PIPE MATERIAL SHALL BE PVC SCHEDULE 40 OR PVC C900 AND HAVE MECHANICAL JOINTS AT LEAST 10 FEET ON EITHER SIDE OF THE CENTER LINE OF THE CROSSING. THE WATER LINE SHALL HAVE MECHANICAL JOINTS WITH APPROPRIATE FASTENERS AS REQUIRED TO PROVIDE A MINIMUM OF 18-INCH VERTICAL SEPARATION MEETING REQUIREMENTS OF ANSI A21.10 OR ANSI 21.11 (AWWA C-151) (CLASS 50).
- ALL PVC & HDPE SEWER AND WATER PIPE SHALL HAVE A TRACER WIRE INSTALLED IN THE TRENCH AND TERMINATED PER THE DETAILS.
- UNDERGROUND UTILITY LINES SHALL BE INSTALLED, INSPECTED AND APPROVED PRIOR TO PLACING BACKFILL.
- IN PAVEMENT AREAS, RAISE MANHOLE CASTINGS TO BE FLUSH WITH PROPOSED FINISHED SURFACE GRADE. IN GREEN AREAS, RAISE MANHOLE CASTINGS TO BE ONE FOOT ABOVE FINISHED GROUND ELEVATION & INSTALL A WATER-TIGHT LID.
- REFER TO PLUMBING PLANS FOR LOCATION, SIZE AND ELEVATION OF UTILITY SERVICE CONNECTIONS AND ROOF DRAINS TO THE INTERIOR BUILDING SYSTEMS. BACKFLOW DEVICES (BOCV AND PRZ ASSEMBLIES) & METERS ARE LOCATED INSIDE THE BUILDING.
- CONTRACTOR IS SPECIFICALLY CAUTIONED THAT THE LOCATION AND/OR ELEVATION OF EXISTING UTILITIES AS

- SHOWN ON THESE PLANS IS BASED ON RECORDS OF THE VARIOUS UTILITY COMPANIES, AND WHERE POSSIBLE, MEASUREMENTS TAKEN IN THE FIELD. THE INFORMATION IS NOT TO BE RELIED ON AS BEING EXACT OR COMPLETE. THE CONTRACTOR MUST CALL THE APPROPRIATE UTILITY COMPANIES AT LEAST 72 HOURS BEFORE ANY EXCAVATION TO REQUEST EXACT FIELD LOCATION OF UTILITIES. IT SHALL BE THE RESPONSIBILITY OF THE CONTRACTOR TO RELOCATE ALL EXISTING UTILITIES WHICH CONFLICT WITH THE PROPOSED IMPROVEMENTS SHOWN ON THE PLANS.
- CONTRACTOR IS RESPONSIBLE FOR ALL NECESSARY INSPECTIONS AND/OR CERTIFICATIONS REQUIRED BY CODES AND/OR UTILITY SERVICE COMPANIES. COORDINATE WITH ALL UTILITY COMPANIES FOR INSTALLATION REQUIREMENTS AND SPECIFICATIONS.
 - REFER TO THE SITE ELECTRICAL PLANS FOR SPECIFICATIONS OF THE PROPOSED SITE LIGHTING AND ELECTRICAL EQUIPMENT.
 - EXCAVATE DRAINAGE TRENCHES TO FOLLOW PROPOSED STORM SEWER ALIGNMENTS. REFER TO THE UTILITY PLANS FOR LAYOUT AND ELEVATIONS FOR PROPOSED SANITARY SEWER, WATER MAIN, AND OTHER BUILDING UTILITY SERVICE CONNECTIONS. REFER TO THE GRADING PLAN FOR DETAILED SURFACE ELEVATIONS.
 - EXCESS MATERIAL, ABANDONED UTILITY ITEMS, AND OTHER UNUSABLE MATERIALS SHALL BECOME THE PROPERTY OF THE CONTRACTOR AND SHALL BE DISPOSED OF OFF THE CONSTRUCTION SITE.
 - COORDINATE WITH THE PLUMBING PLANS FOR THE LOCATION, SIZE AND ELEVATION OF THE PROPOSED UNDERGROUND ROOF DRAIN CONNECTIONS.
 - WHERE STORM SEWER ROOF DRAINS HAVE LESS THAN 4-FEET OF COVER IN PAVED AREAS OR 3-FEET OF COVER IN LANDSCAPE AREAS, PROVIDE 3-INCH THICK INSULATION A MINIMUM OF 5-FEET IN WIDTH, CENTERED ON THE PIPE.
 - ALL STORM SEWER PIPE JOINTS SHALL BE WATER-TIGHT CONNECTIONS.
 - ALL STORM SEWER PIPE CONNECTIONS TO MANHOLES SHALL BE GASKETED AND WATER TIGHT. BOOTED COUPLERS AT THE STRUCTURE OR A WATER STOP WITH NON-SHRINK GROUT MAY BE USED IN ACCORDANCE WITH LOCAL CODES.
 - CONTRACTOR SHALL AIR TEST ALL STORM SEWER PIPE IN ACCORDANCE WITH LOCAL CODE REQUIREMENTS.

LEGEND

EXISTING	PROPOSED	
		GATE VALVE
		HYDRANT
		REDUCER
		TEE
		SANITARY SEWER MANHOLE
		SANITARY SEWER CLEANOUT
		WATERMAIN
		SANITARY SEWER
		STORM SEWER
		UNDERGROUND ELECTRIC
		TELEPHONE
		GAS MAIN

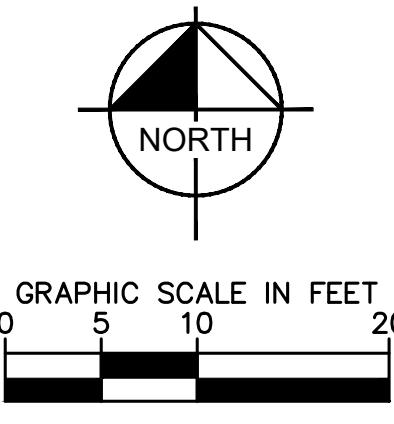

PRELIMINARY - NOT FOR CONSTRUCTION

KHA PROJECT 160094046.1	DATE XX/XX/XXXX	SCALE AS SHOWN	DESIGNED BY MTL	DRAWN BY BSK	CHECKED BY TJS	No.	REVISIONS	DATE	BY
Kimley»Horn									
2023 KIMLEY-HORN AND ASSOCIATES, INC. 767 EUSTIS STREET, SUITE 100, ST. PAUL, MN 55114 PHONE: 651-845-4197 WWW.KIMLEY-HORN.COM									
UTILITY PLAN									
CHASE BANK- WAUWATOSA PREPARED FOR THE ARCHITECTS PARTNERSHIP WAUWATOSA									
SHEET NUMBER C600									

1

TREE PLANTING DETAIL

SCALE: N.T.S.

L101

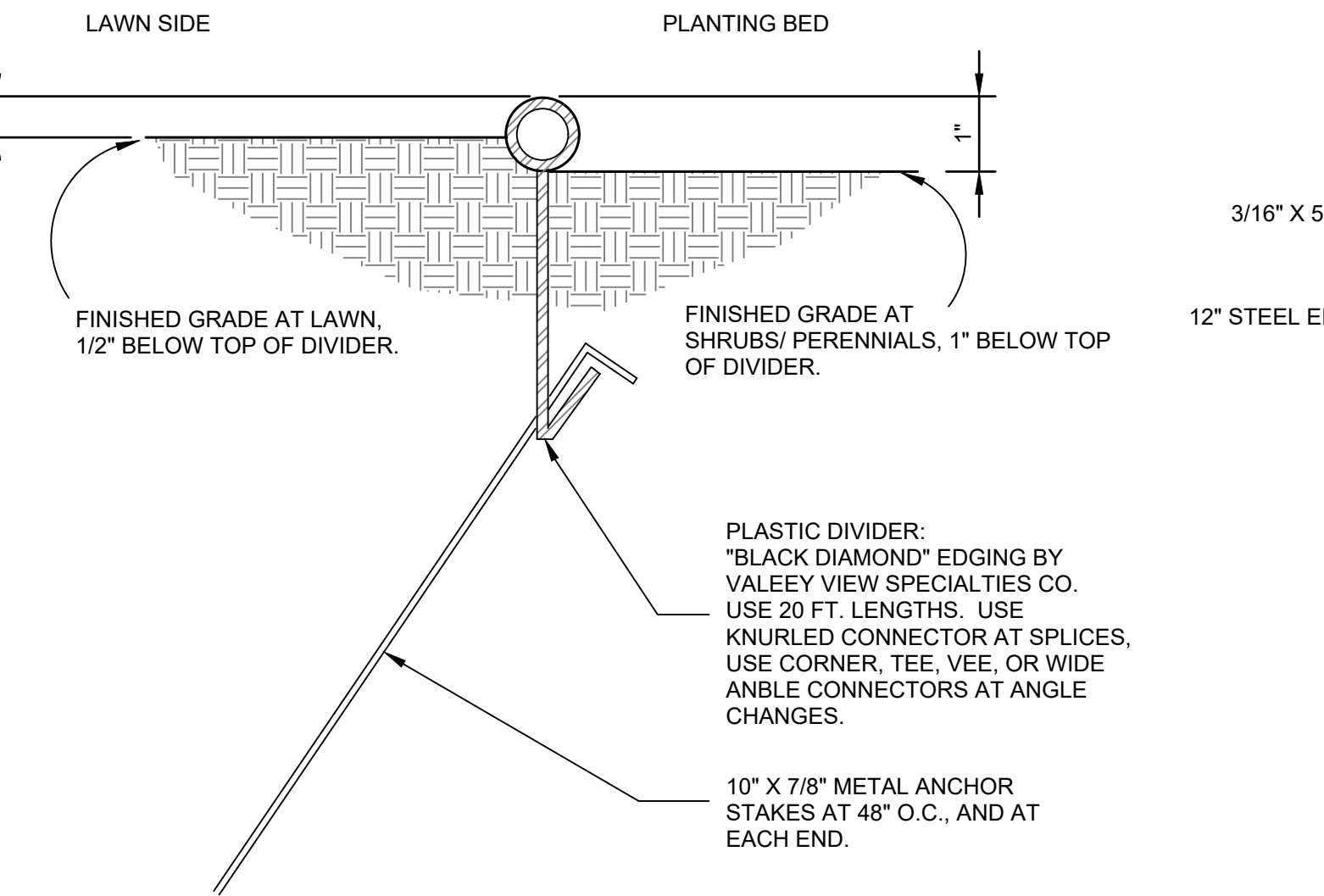

3

POLY EDGER DETAIL

SCALE: N.T.S.

L101

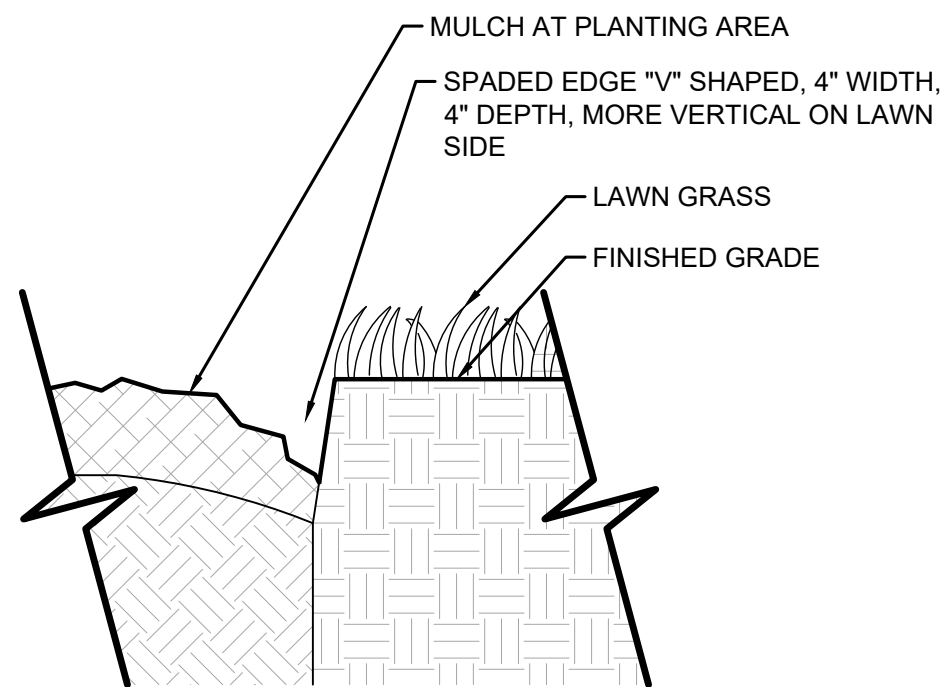

5

SPADED EDGE DETAIL

SCALE: 1-1/2"=1'

L101



2

SHRUB / PERENNIAL PLANTING DETAIL

SCALE: N.T.S.

L101

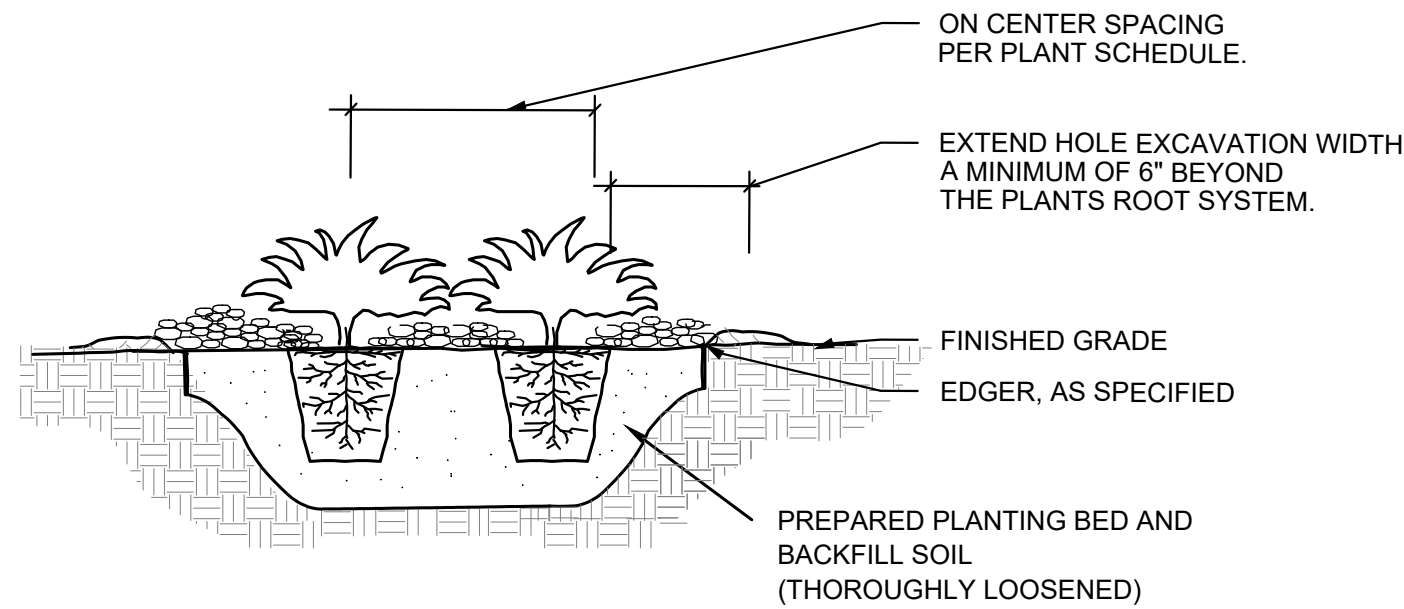

- NOTES:
1. SCARIFY SIDES AND BOTTOM OF HOLE.
 2. PROCEED WITH CORRECTIVE PRUNING OF TOP AND ROOT.
 3. REMOVE CONTAINER AND SCORE OUTSIDE OF SOIL MASS TO REDIRECT AND PREVENT CIRCLING FIBROUS ROOTS. REMOVE OR CORRECT STEM GIRDLING ROOTS.
 4. PLUMB AND BACKFILL WITH PLANTING SOIL.
 5. WATER THOROUGHLY WITHIN 2 HOURS TO SETTLE PLANTS AND FILL VOIDS.
 6. BACK FILL VOIDS AND WATER SECOND TIME.
 7. PLACE MULCH WITHIN 48 HOURS OF THE SECOND WATERING UNLESS SOIL MOISTURE IS EXCESSIVE.
 8. MIX IN 3-4" OF ORGANIC COMPOST.

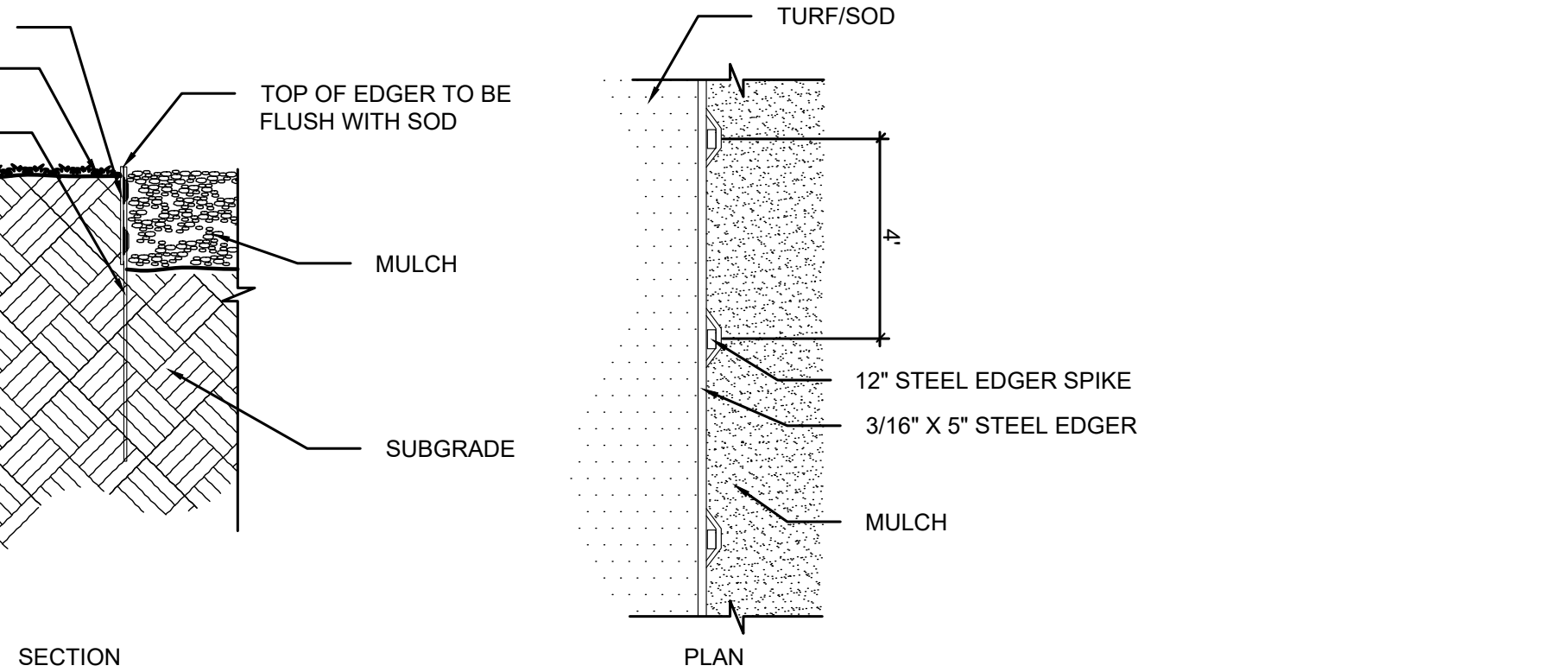

4

STEEL EDGER DETAIL

SCALE: N.T.S.

L101

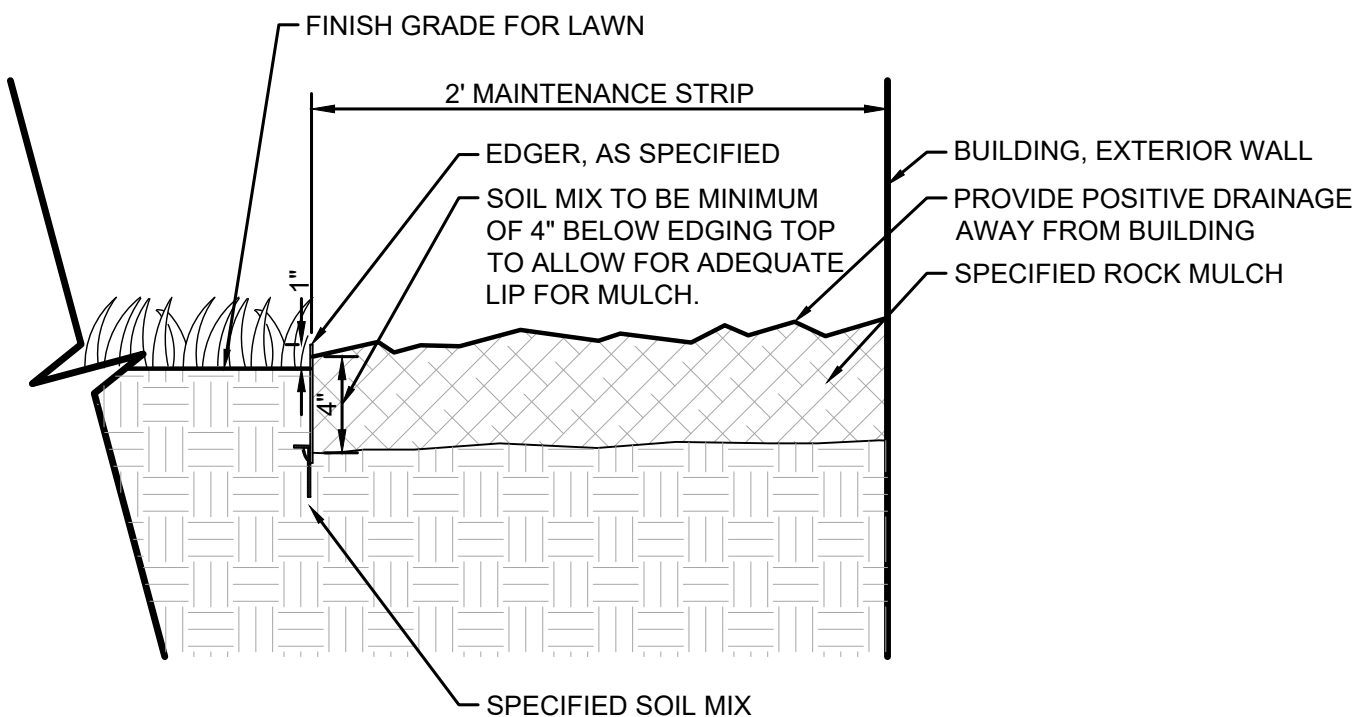

6

MAINTENANCE STRIP DETAIL

SCALE: 1-1/2"=1'

L101

LANDSCAPE NOTES

- PLANTING
1. CONTACT COMMON GROUND ALLIANCE AT 811 OR CALL811.COM TO VERIFY LOCATIONS OF ALL UNDERGROUND UTILITIES PRIOR TO INSTALLATION OF ANY PLANTS OR LANDSCAPE MATERIAL.
 2. ACTUAL LOCATION OF PLANT MATERIAL IS SUBJECT TO FIELD AND SITE CONDITIONS.
 3. NO PLANTING WILL BE INSTALLED UNTIL ALL GRADING AND CONSTRUCTION HAS BEEN COMPLETED IN THE IMMEDIATE AREA.
 4. ALL SUBSTITUTIONS MUST BE APPROVED BY THE LANDSCAPE ARCHITECT PRIOR TO SUBMISSION OF ANY BID AND/OR QUOTE BY THE LANDSCAPE CONTRACTOR.
 5. PROVIDE TWO YEAR GUARANTEE OF ALL PLANT MATERIALS. THE GUARANTEE BEGINS ON THE DATE OF THE LANDSCAPE ARCHITECT'S OR OWNER'S WRITTEN ACCEPTANCE OF THE INITIAL PLANTING. REPLACEMENT PLANT MATERIAL SHALL HAVE A ONE YEAR GUARANTEE COMMENCING UPON PLANTING.
 6. ALL PLANTS TO BE SPECIMEN GRADE, MINNESOTA-GROWN AND/OR HARDY. SPECIMEN GRADE SHALL ADHERE TO, BUT IS NOT LIMITED BY, THE FOLLOWING STANDARDS:
ALL PLANTS SHALL BE FREE FROM DISEASE, PESTS, WOUNDS, SCARS, ETC.
ALL PLANTS SHALL BE FREE FROM NOTICEABLE GAPS, HOLES, OR DEFORMITIES.
ALL PLANTS SHALL BE FREE FROM BROKEN OR DEAD BRANCHES.
ALL PLANTS SHALL HAVE HEAVY, HEALTHY BRANCHING AND LEAFING.
CONIFEROUS TREES SHALL HAVE AN ESTABLISHED MAIN LEADER AND A HEIGHT TO WIDTH RATIO OF NO LESS THAN 5:3.
 7. PLANTS TO MEET AMERICAN STANDARD FOR NURSERY STOCK (ANSI Z60.1-2014 OR MOST CURRENT VERSION) REQUIREMENTS FOR SIZE AND TYPE SPECIFIED.
 8. PLANTS TO BE INSTALLED AS PER MNL A & ANSI STANDARD PLANTING PRACTICES.
 9. INSTALL PLANTS BY PLANT INSTALLATION PERIOD INFORMATION IN THE LATEST STANDARD PLANTING DETAILS FROM MNDOT. PLANTINGS BEFORE OR AFTER THESE DATES ARE DONE AT RISK.
 10. PLANTS SHALL BE IMMEDIATELY PLANTED UPON ARRIVAL AT SITE. PROPERLY HEEL-IN MATERIALS IF NECESSARY; TEMPORARY ONLY.
 11. PRIOR TO PLANTING, FIELD VERIFY THAT THE ROOT COLLAR/ROOT FLARE IS LOCATED AT THE TOP OF THE BALLED & BURLAP TREE. IF THIS IS NOT THE CASE, SOIL SHALL BE REMOVED DOWN TO THE ROOT COLLAR/ROOT FLARE. WHEN THE BALLED & BURLAP TREE IS PLANTED, THE ROOT COLLAR/ROOT FLARE SHALL BE EVEN OR SLIGHTLY ABOVE FINISHED GRADE.
 12. OPEN TOP OF BURLAP ON BB MATERIALS; REMOVE POT ON POTTED PLANTS; SPLIT AND BREAK APART PEAT POTS.
 13. PRUNE PLANTS AS NECESSARY - PER STANDARD NURSERY PRACTICE AND TO CORRECT POOR BRANCHING OF EXISTING AND PROPOSED TREES.
 14. WRAP ALL SMOOTH-BARKED TREES - FASTEN TOP AND BOTTOM. REMOVE BY APRIL 1ST.
 15. STAKING OF TREES AS REQUIRED; REPOSITION, PLUMB AND STAKE IF NOT PLUMB AFTER ONE YEAR.

- SOIL
16. TOPSOIL SHALL BE LOCAL FERTILE AGRICULTURAL SOIL FREE OF SUBSOILS, ROCKS LARGER THAN ONE INCH, CLAYS, PLANTS, WEEDS, ROOTS AND OTHER IMPURITIES. PH VALUE TO BE BETWEEN 5.4 AND 7.0. REMOVE DEBRIS AND WEEDS FROM SUBSOIL. MINIMUM 4" DEPTH TOPSOIL FOR ALL LAWN GRASS AREAS AND 12" DEPTH TOPSOIL FOR TREES, SHRUBS AND PERENNIALS. LIGHTLY COMPACT TOPSOIL AFTER PLACEMENT AND PROHIBIT CONSTRUCTION TRAFFIC FROM AREAS WITH TOPSOIL.
 17. THE NEED FOR SOIL AMENDMENTS SHALL BE DETERMINED UPON SITE SOIL CONDITIONS PRIOR TO PLANTING. LANDSCAPE CONTRACTOR SHALL NOTIFY LANDSCAPE ARCHITECT FOR THE NEED OF ANY SOIL AMENDMENTS.
 18. BACKFILL SOIL AND TOPSOIL TO ADHERE TO MNDOT STANDARD SPECIFICATION 3877 (LOAM TOPSOIL BORROW) / WISDOT STANDARD SPECIFICATION 625 (TOPSOIL AND SALVAGED TOPSOIL) AND TO BE EXISTING TOP SOIL FROM SITE FREE OF ROOTS, ROCKS LARGER THAN ONE INCH, SUBSOIL DEBRIS, AND LARGE WEEDS UNLESS SPECIFIED OTHERWISE. MINIMUM 4" DEPTH TOPSOIL FOR ALL LAWN GRASS AREAS AND 12" DEPTH TOPSOIL FOR TREE, SHRUBS, AND PERENNIALS.

- MULCH
19. MULCH TO BE AT ALL TREE, SHRUB, PERENNIAL, AND MAINTENANCE AREAS. TREE AND SHRUB PLANTING BEDS SHALL HAVE 4" DEPTH OF DOUBLE SHREDDED HARDWOOD MULCH. DOUBLE SHREDDED HARDWOOD MULCH TO BE USED AROUND ALL PLANTS WITHIN TURF AREAS. PERENNIAL AND ORNAMENTAL GRASS BEDS SHALL HAVE 2" DEPTH DOUBLE SHREDDED HARDWOOD MULCH. MULCH TO BE FREE OF DELETERIOUS MATERIAL AND NATURAL IN COLOR (DYE-FREE), OR APPROVED EQUAL. ROCK MULCH TO BE TRAP ROCK, BUFF LIMESTONE, RIVER ROCK, 1 1/2" DIAMETER, AT MINIMUM 3" DEPTH, OR APPROVED EQUAL. APPLY PRE-MIXED MULCH TO LANDSCAPE PER MANUFACTURER RECOMMENDATIONS. USE PREEN OR PRE-APPROVED EQUAL. ROCK MULCH TO BE ON COMMERCIAL GRADE FILTER FABRIC, BY TYPAR, OR APPROVED EQUAL WITH NO EXPOSURE. MULCH AND FABRIC TO BE APPROVED BY OWNER PRIOR TO INSTALLATION. MULCH TO MATCH EXISTING CONDITIONS (WHERE APPLICABLE).

- EDGER
20. EDGING TO BE COMMERCIAL GRADE VALLEY-VIEW BLACK DIAMOND (OR EQUAL) POLY EDGING OR SPADED EDGE, AS INDICATED. POLY EDGING SHALL BE PLACED WITH SMOOTH CURVES AND STAKED WITH METAL SPIKES NO GREATER THAN 4 FOOT ON CENTER WITH BASE OF TOP BEAD AT GRADE, FOR MOWERS TO CUT ABOVE WITHOUT DAMAGE. UTILIZE CURBS AND SIDEWALKS FOR EDGING WHERE POSSIBLE. WHERE EDGING TERMINATES AT A SIDEWALK, BEVEL OR RECESS ENDS TO PREVENT TRIP HAZARD. SPADED EDGE TO PROVIDE V-SHAPED DEPTH AND WIDTH TO CREATE SEPARATION BETWEEN MULCH AND GRASS. INDIVIDUAL TREE, SHRUB, OR RAIN-GARDEN BEDS TO BE SPADED EDGE, UNLESS NOTED OTHERWISE. EDGING TO MATCH EXISTING CONDITIONS (WHERE APPLICABLE).
 21. EDGING TO BE COMMERCIAL GRADE COL-MET (OR EQUAL) STEEL EDGING; 3/16" THICK x 5" TALL, COLOR BLACK, OR SPADED EDGE, AS INDICATED. STEEL EDGING SHALL BE PLACED WITH SMOOTH CURVES AND STAKED WITH METAL SPIKES NO GREATER THAN 4 FOOT ON CENTER WITH TOP OF EDGER AT GRADE, FOR MOWERS TO CUT ABOVE WITHOUT DAMAGE. UTILIZE CURBS AND SIDEWALKS FOR EDGING WHERE POSSIBLE. WHERE EDGING TERMINATES AT A SIDEWALK, BEVEL OR RECESS ENDS TO PREVENT TRIP HAZARD. SPADED EDGE TO PROVIDE V-SHAPED DEPTH AND WIDTH TO CREATE SEPARATION BETWEEN MULCH AND GRASS. INDIVIDUAL TREE, SHRUB, OR RAIN-GARDEN BEDS TO BE SPADED EDGE, UNLESS NOTED OTHERWISE. EDGING TO MATCH EXISTING CONDITIONS (WHERE APPLICABLE).

- SEED/SOD
22. ALL DISTURBED AREAS TO BE SODDED OR SEEDED, UNLESS OTHERWISE NOTED. SOD TO BE STANDARD MINNESOTA GROWN AND HARDY BLUEGRASS MIX, FREE OF LAWN WEEDS. ALL TOPSOIL AREAS TO BE RAKED TO REMOVE DEBRIS AND ENSURE DRAINAGE. SLOPES OF 3:1 OR GREATER SHALL BE STAKED. SEED AS SPECIFIED. PER MNDOT SPECIFICATIONS AND SUPPLIER/MANUFACTURER RECOMMENDATIONS. IF NOT INDICATED ON LANDSCAPE PLAN, SEE EROSION CONTROL PLAN.

- IRRIGATION
23. PROVIDE IRRIGATION / PROVIDE NEW SYSTEM, OR MODIFY EXISTING IRRIGATION PER OWNERS DIRECTION TO ALL PLANTED AREAS ON SITE. IRRIGATION SYSTEM TO BE DESIGN/BUILD BY LANDSCAPE CONTRACTOR. LANDSCAPE CONTRACTOR TO PROVIDE SHOP DRAWINGS TO LANDSCAPE ARCHITECT FOR APPROVAL PRIOR TO INSTALLATION OF IRRIGATION SYSTEM. CONTRACTOR TO PROVIDE OPERATION MANUALS, AS-BUILT PLANS, AND NORMAL PROGRAMMING. SYSTEM SHALL BE WINTERIZED AND HAVE SPRING STARTUP DURING FIRST YEAR OF OPERATION. SYSTEM SHALL HAVE ONE-YEAR WARRANTY ON ALL PARTS AND LABOR. ALL INFORMATION ABOUT INSTALLATION AND SCHEDULING CAN BE OBTAINED FROM THE GENERAL CONTRACTOR. SYSTEM SHALL INCLUDE A RAIN SENSOR AND APPROPRIATE TECHNOLOGY.

- ESTABLISHMENT
24. PROVIDE NECESSARY WATERING OF PLANT MATERIALS UNTIL THE PLANT IS FULLY ESTABLISHED OR IRRIGATION SYSTEM IS OPERATIONAL. OWNER WILL NOT PROVIDE WATER FOR CONTRACTOR.
 25. REPAIR, REPLACE, OR PROVIDE SOD/SEED AS REQUIRED FOR ANY ROADWAY BOULEVARD AREAS ADJACENT TO THE SITE DISTURBED DURING CONSTRUCTION.

- WARRANTY
26. REPAIR ALL DAMAGE TO PROPERTY FROM PLANTING OPERATIONS AT NO COST TO OWNER.
 27. RAIN GARDEN NOTE: PROVIDE AND INSTALL EROSION CONTROL BLANKET AT RAIN GARDEN AREA. SLOPES AFTER ALL PLANTING HAVE BEEN INSTALLED. BLANKET TO BE ONE SEASON GEOJUTE, MNDOT CATEGORY 2 (STRAW IS, WOOD FIBER IS), OR APPROVED EQUAL. BLANKET TO BE OVERLAPPED BY 4" AND ANCHORED BY SOD. STAPLES, PLACE BLANKET PERPENDICULAR TO THE SLOPE. TRENCH IN EDGES

PRELIMINARY - NOT FOR CONSTRUCTION

KHA PROJECT 160094046.1		KIMLEY-HORN & ASSOCIATES, INC. 2023 KIMLEY-HORN AND ASSOCIATES, INC. 767 EUSTIS STREET, SUITE 100, ST. PAUL, MN 55114 PHONE 651-445-4197 WWW.KIMLEY-HORN.COM		BY	
DATE XX/XX/XXXX		REVISIONS		DATE	
SCALE #####		No.			
DESIGNED BY MTL					
DRAWN BY BSK					
CHECKED BY TJS					
FIRST M. LAST 08/16/2023		MN LIC. NO. 12345			
CHASE BANK- WAUWATOSA PREPARED FOR THE ARCHITECTS PARTNERSHIP WAUWATOSA		LANDSCAPE DETAILS			
SHEET NUMBER L101					

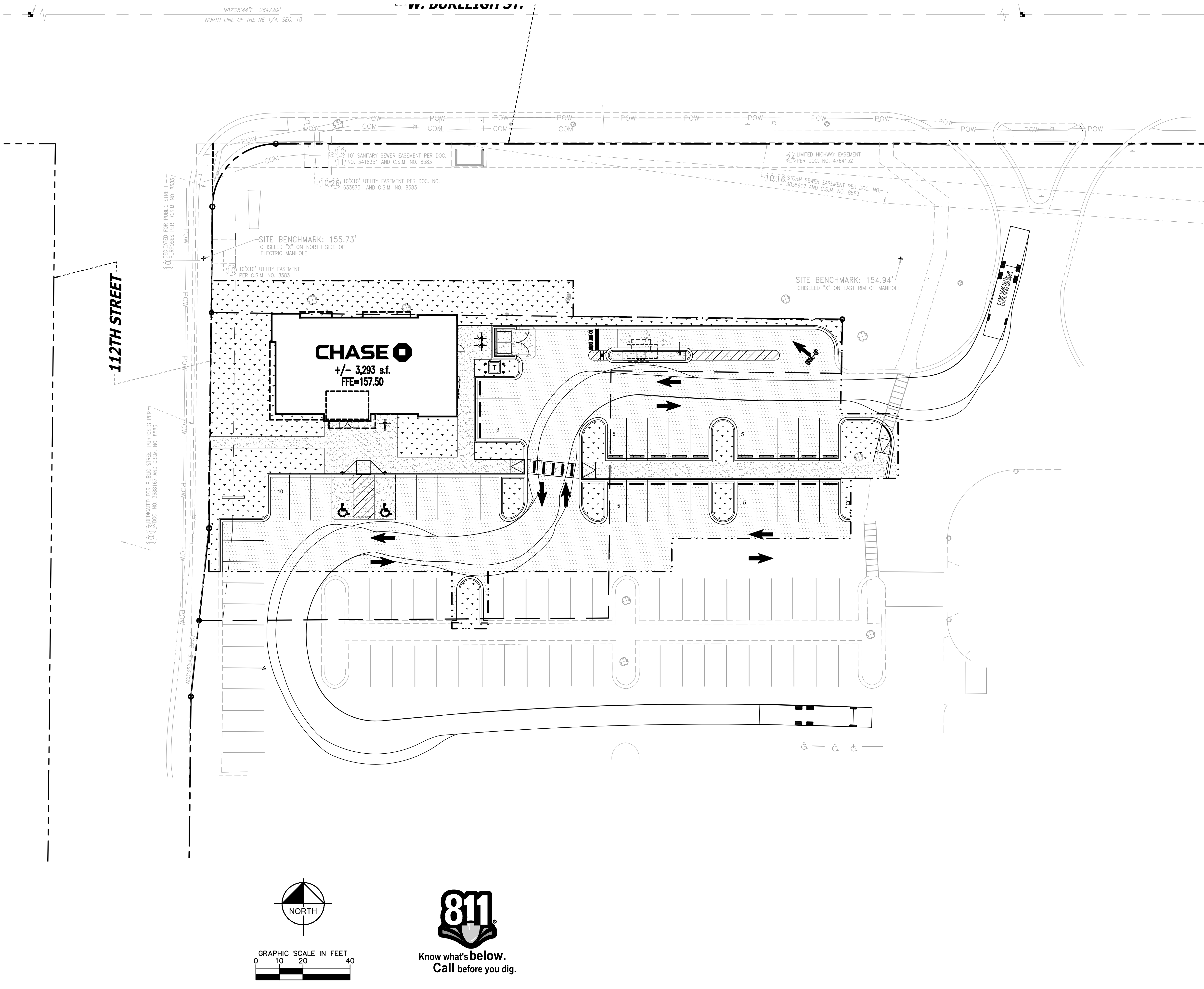

PRELIMINARY - NOT FOR CONSTRUCTION

CHASE BANK-
WAUWATOSA
PREPARED FOR
THE ARCHITECTS
PARTNERSHIP
WAUWATOSA

SHEET NUMBER
EX-1

FIRE TRUCK TURN

KHA PROJECT
160094046.1
DATE
XX/XX/XXXX
SCALE AS SHOWN
DESIGNED BY MTL
DRAWN BY BSK
CHECKED BY TJS

Kimley»Horn

© 2023 KIMLEY-HORN AND ASSOCIATES, INC.
787 EUSTIS STREET, SUITE 100, ST. PAUL, MN 55114
PHONE 651-445-4197
WWW.KIMLEY-HORN.COM

No. REVISIONS DATE BY