

CODE	QTY	BOTANICAL NAME	COMMON NAME	SIZE	ROOT	NOTES
<u>Deciduous Trees</u>						
Ace / Red	1	Acer x freemanii 'Ed Gartner'	Redhead Maple	2 1/2"-3"	BB	
Car / Fir	4	Carpinus caroliniana 'JN Upright'	Firespire Musclewood	1 1/2"-2"	BB	
Gle / Str	2	Gleditsia triacanthos 'Draves' PPAF	Street Keeper Honeylocust	2 1/2"-3"	BB	
Ost / vir	7	Ostrya virginiana	Ironwood	2 1/2"-3"	BB	
Que / Reg	2	Quercus robur x bicolor 'Long'	Regal Prince English Oak	2 1/2"-3"	BB	
<u>Evergreen Trees</u>						
Jun / low	32	Juniperus chinensis 'lowa'	Iowa Juniper	5' - 6' ht.	BB	
Thu / Tec	15	Thuja occidentalis 'Bail John' PP15,850	Technito Arborvitae	5' - 6' ht.	BB	
<u>Evergreen Shrubs</u>						
Jun / Kal	17	Juniperus chinensis 'Pfitzeriana Kallay'	Kallays Compact Juniper	18" - 24"	Cont.	
Tax / Den	10	Taxus x media 'Densiformus'	Densi Yew	24" - 30"	Cont.	
Thu / Eme	14	Thuja occidentalis 'Smaragd'	Emerald Arborvitae	4' - 5' ht.	Cont.	
<u>Evergreen Shrubs (broadleaf)</u>						
Bux / Gre	34	Buxus x 'Green Mound'	Green Mound Boxwood	3 gallon	Cont.	
<u>Deciduous Shrubs</u>						
Aro / mel	6	Aronia melanocarpa	Black Chokeberry	24" - 30"	Cont.	
Cor / Art	3	Cornus stolonifera 'Farrow' PP18,523	Artic Fire Dogwood	18" - 24"	Cont.	
Rha / Fin	3	Rhamnus frangula 'Fine Line Ron Williams'	Fine Line Buckthorn	4' ht.	Cont.	
Rhu / Gro	5	Rhus aromatica 'Gro-low'	Gro-low Sumac	2 gallon	Cont.	
Sam / Lem	8	Sambucus racemosa 'SMNSRD4'	Lemony Lace Elderberry	2 gallon	Cont.	
Ste / inc	13	Stephanandra incisa 'Crispa'	Cutleaf Stephanandra	18"	Cont.	
<u>Perennials</u>						
Hos / Sum	8	Hosta 'Sum and Substance'	Sum and Substance Hosta	1 gallon	Cont.	
<u>Ornamental Grasses</u>						
Cal / Kar	17	Calamagrostis acutiflora 'Karl Foerster'	Karl Foerster Feather Reed Grass	1 gallon	Cont.	
Pan / Nor	15	Panicum virgatum 'Northwind'	Northwind Switch Grass	1 gallon	Cont.	
<u>Vines</u>						
Cam / Ato	9	Campsis radicans 'Stromboli'	Atomic Red Trumpet Vine	1 gallon	Cont.	requires trellis

INTERIOR VUA LANDSCAPE REQUIREMENTS:
Vehicle Use Area (VUA) = On-site resident parking and additional public parking is located in underground parking garage. VUA in surface public parking lot is 12,653 S.F.

- Interior VUA Parking Lot Landscape Area Required (10% of area) = 1,265 S.F.
- Interior VUA Parking Lot Landscape Area Provided = **1,333 S.F.**
- Number of Shade Trees Required = 1,265 S.F. / 180 S.F. = 7 Shade Trees
- Number of Shade Trees Provided = **4 Shade Trees**
- Parking Lot Island Landscape Widths & Area Dimensions Shown on Plan

Perimeter Length of Vehicle Use Area (VUA) Adjacent to Street Public ROW = 40 L.F.
 Required Trees & Shrubs (2 deciduous trees and 8 shrubs per 50 L.F.)
 - Required Trees (0.8 X 2) = 2 Trees
 - Required Shrubs (0.8 X 8) = 7 Shrubs

- Number of Trees Provided Adjacent to Street Public ROW = **2 Trees**
- Number of Shrubs Provided Adjacent to Street Public ROW = **9 Shrubs**

PAVEMENT

AREA OF PARKING LOT INTERIOR GREEN SPACE

951 SF

LENGTH OF PARKING LOT PERIMETER ALONG R.O.W.

20'-0"

11'

WIDTH OF PARKING LOT ISLAND

SNOW STORAGE AREA

The site plan shows a rectangular parking lot layout. The top section is labeled 'PAVEMENT' and contains a hatched pattern. Below it is the 'AREA OF PARKING LOT INTERIOR GREEN SPACE'. To the right, a box indicates a total area of '951 SF'. The bottom-left corner is designated as the 'SNOW STORAGE AREA', shown with a triangular hatched pattern. The bottom-right corner is a triangular area with a circular pattern. The right boundary of the parking lot is marked with a red 'X' and labeled '20'-0"'. The bottom boundary is marked with a blue 'X' and labeled '11''. The text 'LENGTH OF PARKING LOT PERIMETER ALONG R.O.W.' is positioned along the bottom edge. A north arrow is located in the upper right corner of the plan.

STONE MULCH
OVER LANDSCAPE
FABRIC

A. LANDSCAPE IRRIGATION: AUTOMATED LANDSCAPE IRRIGATION SYSTEM TO BE INSTALLED. LANDSCAPE IRRIGATION SYSTEM TO BE DESIGNED AND INSTALLED BY LANDSCAPE CONTRACTOR OR IRRIGATION CONSULTANT.

B. SNOW REMOVAL ON SITE: PEDESTRIAN ROUTES SHALL BE KEPT CLEAR OF SNOW. SNOW TO BE PUSHED OR BLOWN TO THE SIDE OF THE ROUTE TO ALLOW PASSAGE. SEE PLAN FOR LOCATION OF SNOW STORAGE IN PARKING LOT.

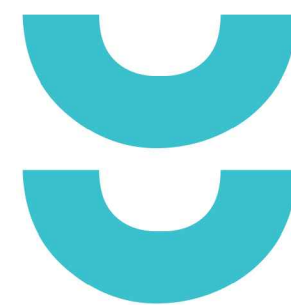
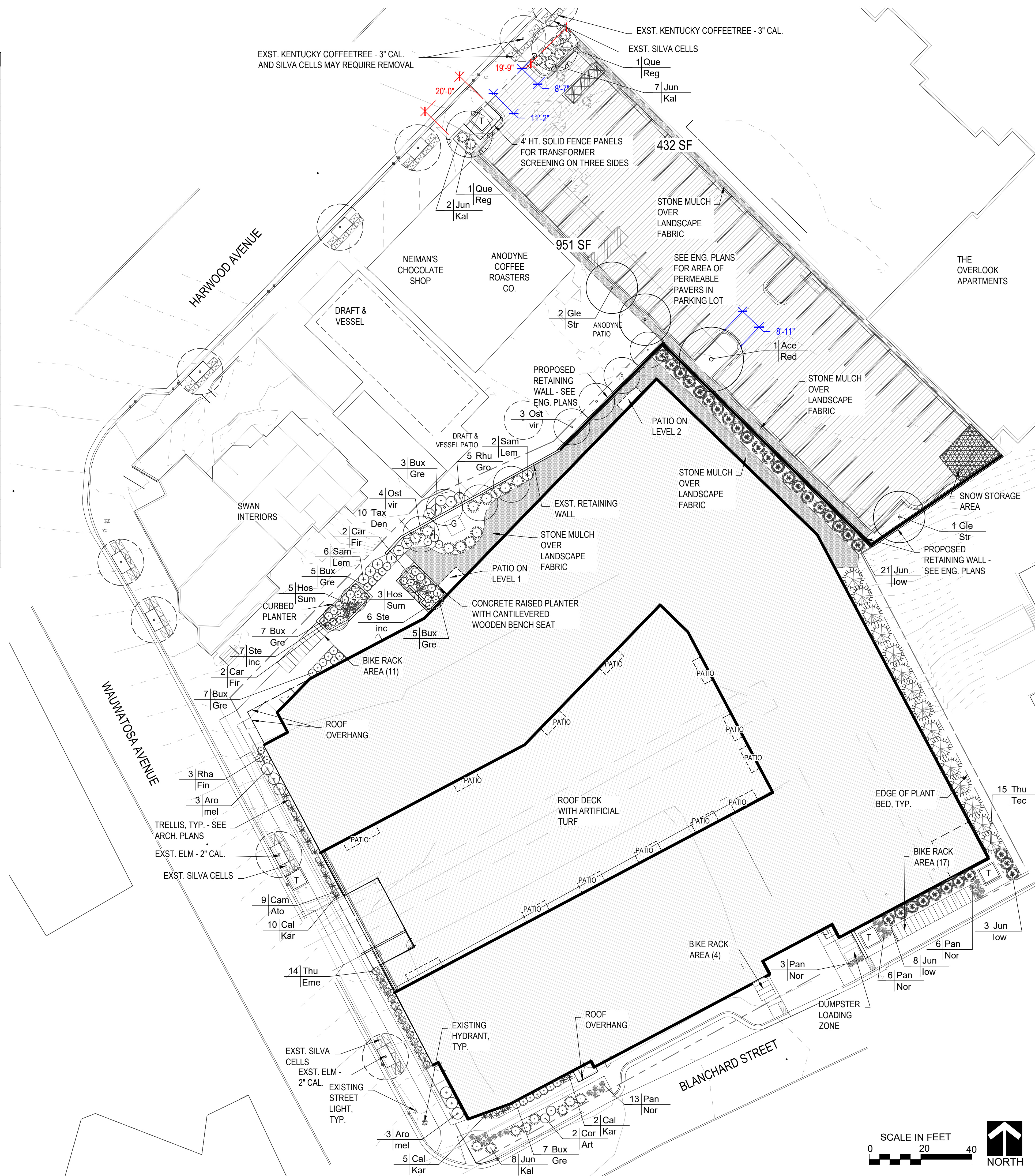

T 414.220.9640

751 N. Jefferson
Street, STE 200
Milwaukee, WI
53202

CONSULTANTS



131 W. Seeboth Street, Suite 240
Milwaukee, WI 53204
(414) 530-1080 www.newwonderlandscapes.com

NOT FOR CONSTRUCTION

THESE DRAWINGS ARE RELEASED FOR
DESIGN DEVELOPMENT PURPOSES
ONLY. THEY ARE NOT TO BE USED FOR
REGULATORY APPROVAL, PERMIT, OR
CONSTRUCTION PURPOSES.

HARLOW AND HEM

REVISIONS:

SCALE	VARIES
-------	--------

PROJECT NUMBER	201103
----------------	--------

SET TYPE	PUD PRELIMINARY SUBMITTAL
----------	---------------------------

DATE ISSUED	04/10/2024
----------------	------------

SHEET NUMBER **L00-1**

©COPYRIGHT 2019 CONTINUUM ARCHITECTS + PLANNERS S.C.

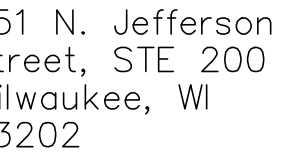

51 N. Jefferson
Street, STE 200
Milwaukee, WI
53202



new eden
LANDSCAPE ARCHITECTURE

131 W. Seeboth Street, Suite 240
Milwaukee, WI 53204

Tel: (414) 530-1080 www.newedenlandscape.com

THESE DRAWINGS ARE RELEASED FOR
DESIGN DEVELOPMENT PURPOSES
ONLY. THEY ARE NOT TO BE USED FOR
REGULATORY APPROVAL, PERMIT, OR
CONSTRUCTION PURPOSES.

EET
MBER

L00-2

