

SITE INFORMATION		
SITE AREA	89631	2.058 AC
SITE DISTURBED AREA	89631	2.058 AC
EXISTING IMPERVIOUS AREA	61224	1.406 AC 68.3 %
PROPOSED IMPERVIOUS AREA	73797	1.694 AC 82.3 %
TOTAL PARKING SPACES	124	
ADA PARKING SPACES	5	

THE SIGMA GROUP
Single Source. Sound Solutions.
 www.thesigmagroup.com
 1300 West Canal Street
 Milwaukee, WI 53233
 Phone: 414-643-4200
 Fax: 414-643-4210

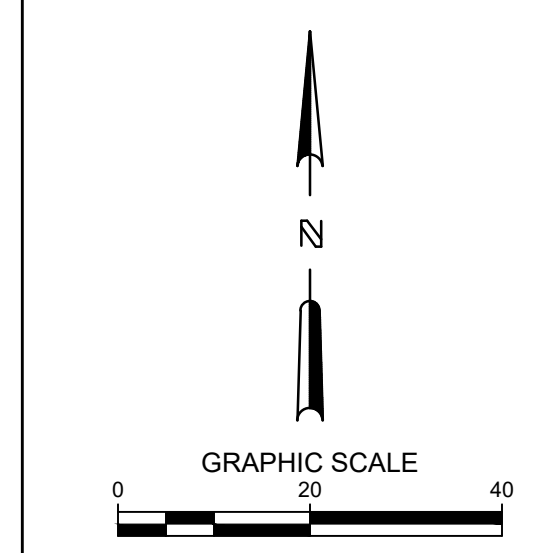

LEGEND:

	5" THICK CONCRETE WALK
	CONCRETE PAVEMENT
	ASPHALT SURFACE
	HEAVY-DUTY ASPHALT SURFACE
	CURB & GUTTER (ACCEPT)
	EXISTING CONTOUR

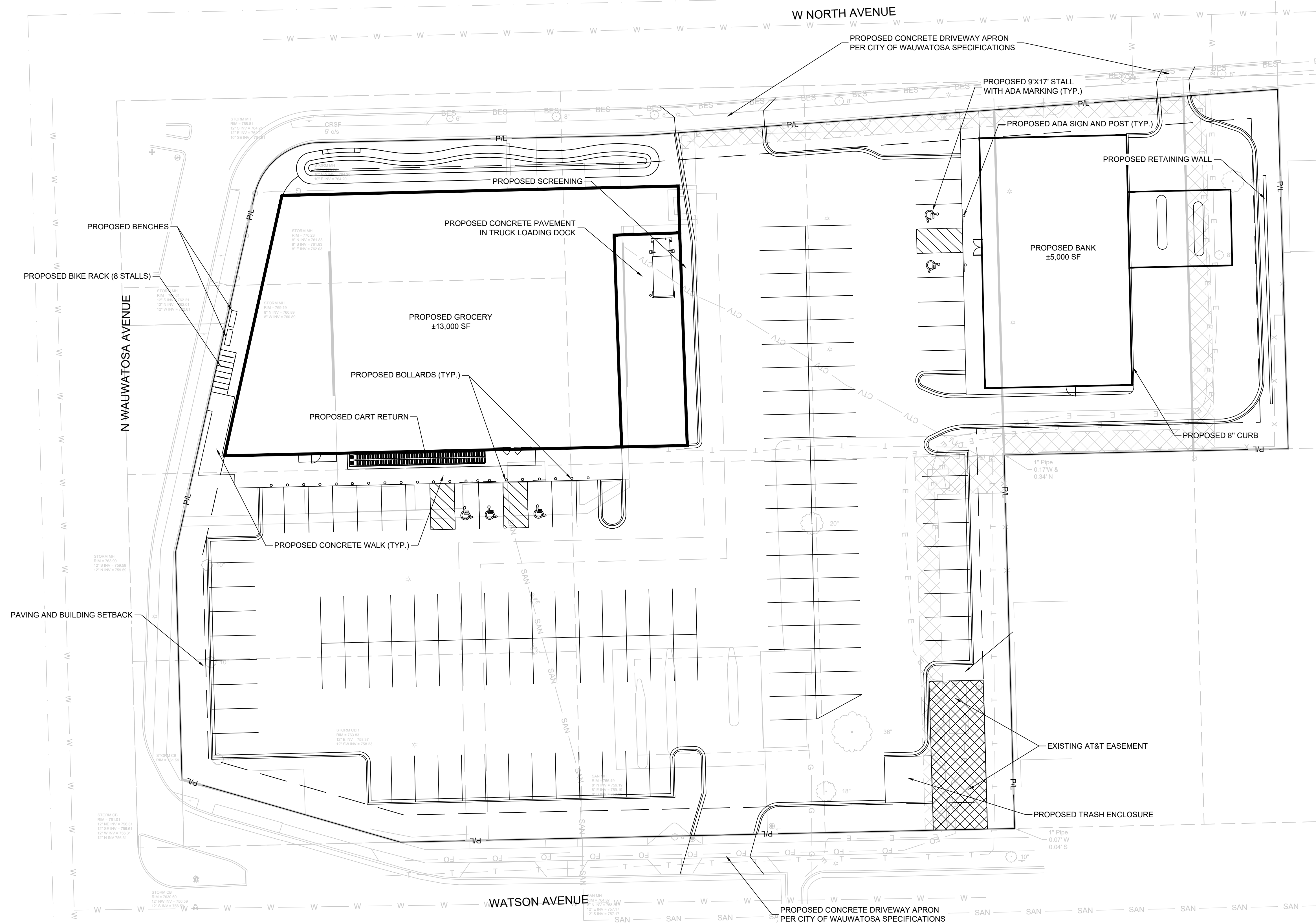

WAUWATOSA GROCERY
7501 W. NORTH AVENUE
WAUWATOSA, WI

SITE PLAN

PRELIMINARY
NOT FOR
CONSTRUCTION

ISSUANCE	DATE

NO. REVISION	DATE

PROJECT NO:	25057
DESIGN DATE:	----
PLOT DATE:	2026.05.13
DRAWN BY:	JMJ
CHECKED BY:	PJI
APPROVED BY:	----
SHEET NO:	C100

- GENERAL NOTES:**
1. THE UNDERGROUND UTILITY INFORMATION SHOWN ON THIS DRAWING IS BASED ON FIELD LOCATIONS AND/OR RECORDS FURNISHED BY MUNICIPALITIES AND UTILITY COMPANIES. THE LOCATION AND ACCURACY OF WHICH CANNOT BE GUARANTEED. THERE MAY BE ADDITIONAL UNDERGROUND UTILITY INSTALLATIONS WITHIN THE PROJECT AREA THAT ARE NOT SHOWN.
 2. VERIFY ACTUAL LOCATIONS AND INVERTS IN THE FIELD. ANY POTENTIAL ERRORS, OMISSIONS, OR DISCREPANCIES SHALL BE BROUGHT TO THE ATTENTION OF THE ENGINEER PRIOR TO PROCEEDING WITH CONSTRUCTION.
 3. WORK TO BE COMPLETED IS INDICATED IN BOLD TYPE LINES AND EXISTING CONDITIONS ARE INDICATED BY LIGHT TYPE LINES.
 4. ELECTRONIC CIVIL FILES ARE AVAILABLE UPON WRITTEN REQUEST. DO NOT USE ELECTRONIC CIVIL FILES TO LAYOUT FOUNDATIONS, COLUMN LINES, LIGHT POLES, OR OTHER NON CIVIL SITE WORK. REFER TO ARCHITECTURAL DRAWINGS FOR DIMENSIONS OF BUILDING AND ARCHITECTURAL FEATURES.
 5. DIMENSIONS ARE FROM FACE OF CURB OR EDGE OF PAVEMENT.
 6. WORK WITHIN THE PUBLIC RIGHT OF WAY, INCLUDING BUT NOT LIMITED TO DRIVEWAY OPENINGS, SIDEWALK AND RAMPS, PAVING, AND CURB AND GUTTER SHALL BE COMPLETED PER MUNICIPAL AND/OR COUNTY REQUIREMENTS AND STANDARDS.
 7. EARTHWORK SHALL BE IN ACCORDANCE WITH GEOTECHNICAL ENGINEER'S RECOMMENDATIONS.



CALL DIGGERS HOTLINE
 1-800-242-8511
 TOLL FREE
 WE STATUTE 182.07(2)(97A)
 REQUIRES MIN. 3 WORK DAYS
 NOTICE BEFORE YOU EXCAVATE
 MILW. AREA 259-1181

THE UNDERGROUND UTILITY INFORMATION SHOWN ON THIS MAP IS BASED ON FIELD MARKINGS AND INFORMATION FURNISHED BY UTILITY COMPANIES AND THE LOCAL MUNICIPALITY. WHILE THIS INFORMATION IS BELIEVED TO BE RELIABLE, ITS ACCURACY AND COMPLETENESS CANNOT BE GUARANTEED.