

7305 W Wells St.
J. Ross McIntyre

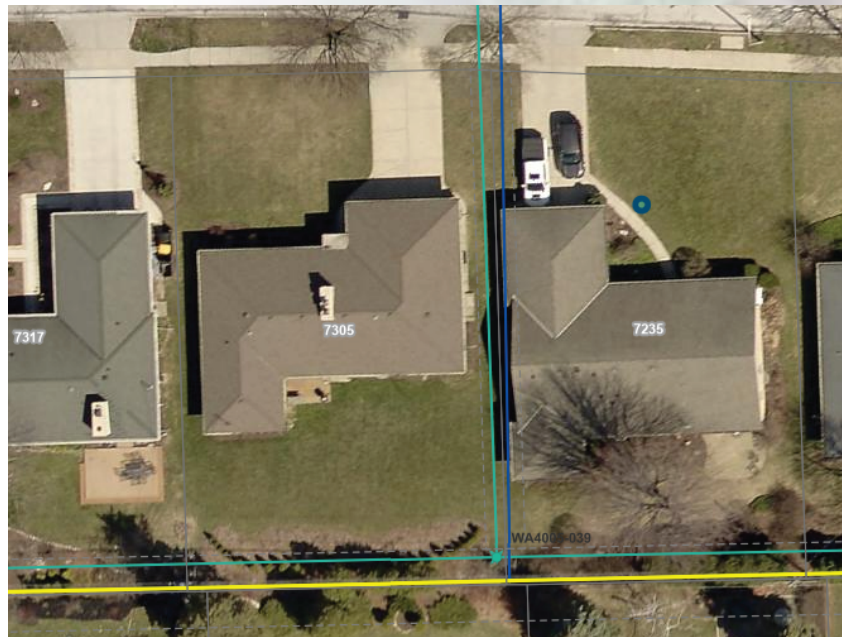

REFERENCE IMAGE FROM WAUWATOSA
ENGINEERING DEPARTMENT



Approximate property
lines based on
overhead maps and
discussion with USIC

Arborvitae hedge
planted in 2019 by
previous homeowner

Wisconsin native
plant bed, planted by
current homeowner in
May 2023

More shrubs, all
mature sized

Cedar trees,
very mature

UTILITY
POLE

PROPOSED
FENCE LINE

PROPOSED
FENCE LINE

7305

SEWER

WATER

GAS

~9.25 ft
deep

~6 ft
deep

SEWER ~11 ft
deep

WATER ~6-8 ft
deep