

7305 W Wells St.
J. Ross McIntyre

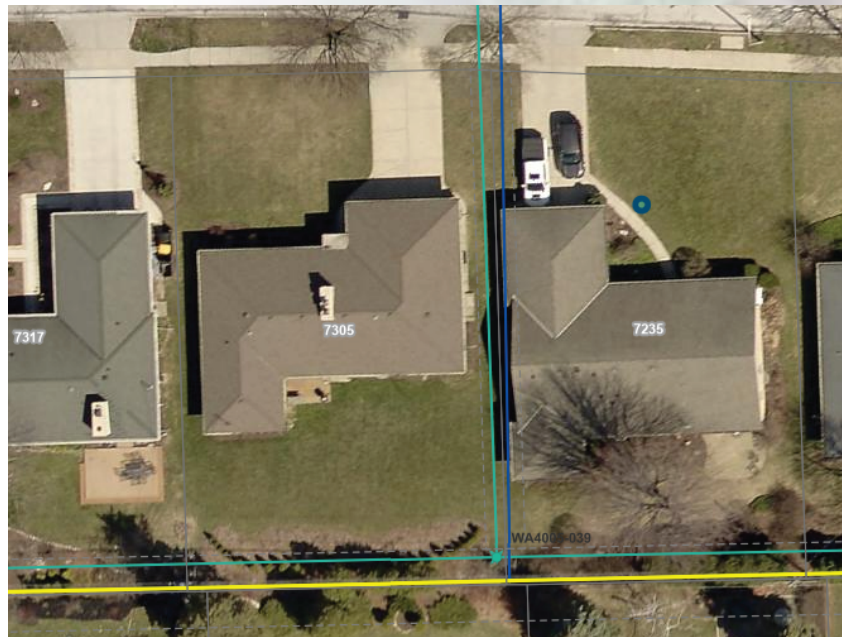

REFERENCE IMAGE FROM WAUWATOSA
ENGINEERING DEPARTMENT



Approximate property
lines based on
overhead maps and
discussion with USIC

GAS

PROPOSED
FENCE LINE

7305

SEWER

WATER

~9.25 ft
deep

~6 ft
deep

10 FT
WIDE

Arborvitae hedge
planted in 2019 by
previous homeowner

Wisconsin native
plant bed, planted by
current homeowner in
May 2023

UTILITY
POLE

More shrubs, all
mature sized

18 FT
WIDE

SEWER ~11 ft
deep

WATER ~6-8 ft
deep

EASEMENT ZONE

Cedar trees,
very mature