

**PLANT SCHEDULE**

SYMBOL	CODE	BOTANICAL / COMMON NAME	SIZE	CONTAINER	QTY
<b>DECIDUOUS TREES</b>					
	AA	Acer x freemanii 'Jeffersred' / Autumn Blaze® Freeman Maple	2.5" Cal.	B&B	3
	CW	Carpinus caroliniana 'Wisconsin Red' / Wisconsin Red Muscledwood	2.5" Cal.	B&B	6
	GA	Ginkgo biloba 'Autumn Gold' / Autumn Gold Maidenhair Tree	2.5" Cal.	B&B	2
	GD	Gymnocladus dioica 'Espresso' / Kentucky Coffeetree	2.5" Cal.	B&B	3
	TG	Tilia cordata 'Greenspire' / Greenspire Littleleaf Linden	2.5" Cal.	B&B	5
<b>EVERGREEN TREES</b>					
	JC	Juniperus chinensis 'Mountbatten' / Mountbatten Juniper	6' Ht.	B&B	15
	JV	Juniperus virginiana / Eastern Redcedar	6' Ht.	B&B	10
	TB	Thuja occidentalis 'Bail John' / Technit® Arborvitae	6' Ht.	B&B	5
	TN	Thuja occidentalis 'Nigra' / Black Arborvitae	6' Ht.	B&B	10
	TT	Thuja occidentalis 'Techny' / Techny Arborvitae	6' Ht.	B&B	4
<b>ORNAMENTAL TREES</b>					
	CC	Cercis canadensis / Eastern Redbud	8' Ht. (Multi-Stem)	B&B	2
	SR	Syringa reticulata 'Ivory Silk' / Ivory Silk Japanese Tree Lilac	2.5" Cal.	B&B	4
<b>BROADLEAF EVERGREEN SHRUBS</b>					
	BG	Buxus x 'Green Mountain' / Green Mountain Boxwood	3 gal.	Cont.	6
<b>DECIDUOUS SHRUBS</b>					
	AI	Aronia melanocarpa 'Morton' / Iroquois Beauty™ Black Chokeberry	3 gal.	Cont.	25
	DJ	Diervilla lonicera 'Jewel' / Jewel Bush Honeysuckle	3 gal.	Cont.	34
	FC	Forsythia x 'Cortasol' / Gold Tide® Forsythia	3 gal.	Cont.	5
	HA	Hydrangea arborescens 'Annabelle' / Annabelle Hydrangea	3 gal.	Cont.	5
	HB	Hydrangea macrophylla 'PIIHM-II' / BloomStruck® Hydrangea	3 gal.	Cont.	6
	RA	Rhus aromatica 'Gro-Low' / Gro-Low Fragrant Sumac	3 gal.	Cont.	28
	RL	Rosa rugosa 'Purple Pavement' / Purple Pavement Rose	3 gal.	Cont.	12
	SM	Syringa meyeri 'Palibin' / Dwarf Korean Lilac	3 gal.	Cont.	7
<b>EVERGREEN SHRUBS</b>					
	JP	Juniperus chinensis 'Kallays Compact' / Kallay Compact Pfitzer Juniper	3 gal.	Cont.	17
	PP	Pinus mugo 'Pumilio' / Dwarf Mugo Pine	3 gal.	Cont.	12
	TE	Taxus x media 'Everlow' / Everlow Anglo-Japanese Yew	3 gal.	Cont.	6
	TH	Taxus x media 'Hicksii' / Hicks Anglo-Japanese Yew	3 gal.	Cont.	2
<b>ORNAMENTAL GRASSES</b>					
	CO	Calamagrostis x acutiflora 'Overdam' / Overdam Feather Reed Grass	1 gal.	Cont.	23
	DG	Deschampsia cespitosa 'Goldtau' / Gold Dew Tufted Hair Grass	1 gal.	Cont.	26
	PN	Panicum virgatum 'Northwind' / Northwind Switch Grass	1 gal.	Cont.	14
	SS	Schizachyrium scoparium 'Standing Ovation' / Standing Ovation Little Bluestem	1 gal.	Cont.	31
	SH	Sporobolus heterolepis 'Tara' / Tara Prairie Dropseed	1 gal.	Cont.	19
<b>PERENNIALS</b>					
	NW	Nepeta x faassenii 'Walker's Low' / Walker's Low Catmint	1 gal.	Cont.	11
	SA	Sedum x 'Autumn Fire' / Autumn Fire Sedum	1 gal.	Cont.	13

**LEGEND:**

- TURFGRASS SEED
- HARDWOOD BARK MULCH PLANT BED
- RAINWATER RENEWAL NATIVE SEED MIX
- BIOINFILTRATION PLUGS
- DECORATIVE STONE MULCH
- PROPERTY LINE
- SHOVEL CUT PLANT EDGING
- METAL PLANT EDGING
- EXISTING TREE
- VEHICLE USE AREA (VUA)
- 5" THICK CONCRETE WALK (C401)
- CONCRETE PAVEMENT (C401)
- ASPHALT SURFACE (C401)
- HEAVY-DUTY ASPHALT SURFACE (C401)

**LANDSCAPE GENERAL NOTES:**

- VERIFY EXISTING AND PROPOSED CONDITIONS, UTILITIES, PIPES, AND STRUCTURES, ETC. PRIOR TO BIDDING AND CONSTRUCTION.
- INSPECT THE SITE PRIOR TO COMMENCING WORK. DOCUMENT IN WRITING AND PHOTOGRAPH EXISTING CONDITIONS WITHIN, AND IN AREAS ADJACENT TO THE LIMITS OF CONSTRUCTION. THE LANDSCAPE CONTRACTOR IS RESPONSIBLE FOR ANY DAMAGES NOT DOCUMENTED IN THE PHOTOGRAPHS PRIOR TO COMMENCEMENT OF DEMOLITION ACTIVITIES.
- COORDINATE THE INSTALLATION OF PLANT MATERIAL WITH INSTALLATION OF ADJACENT PAVEMENTS, DRAINAGE, CURB RELATED STRUCTURES WITH OTHER TRADES.
- RESTORE AREAS OF THE SITE, OR ADJACENT AREAS, WHERE DISTURBED. DAMAGE CAUSED DURING LANDSCAPE INSTALLATION TO EXISTING CONDITIONS AND IMPROVEMENTS IS THE RESPONSIBILITY OF THE LANDSCAPE CONTRACTOR.
- CONTRACTOR SHALL THOROUGHLY REVIEW ALL SPECIFICATIONS RELATED TO TREE PROTECTION, SOIL PREPARATION, TURF, GRASSES AND PLANTS. THESE SECTIONS PROVIDE ADDITIONAL INFORMATION ON MATERIALS AND SET STANDARDS FOR QUALITY AND INSTALLATION REQUIREMENTS.
- PROVIDE 3" DOUBLE SHREDDED BARK MULCH FOR ALL PLANTED TREES, SHRUBS AND LANDSCAPE BEDS.

Site Landscaping Requirements				
Zoning: General Commercial (C2)				
Category	Requirements			
	Requirement	Public VUA Frontage	Quantity Required	Quantity Provided
Perimeter Vehicle Use Area (VUA)	2 Deciduous Trees per 50 LF	444 LF	18 Trees	18 Trees
	8 Shrubs per 50 LF		72 Shrubs	72 Shrubs
Interior Vehicle Use Area (VUA)	10% of Interior VUA Landscaped	Interior VUA	Landscaping Required	Landscaping Provided
	1 Shade Tree per 180 SF of Interior Landscape Area	48,103 SF	4,810 SF	1,659 SF*
		Interior Landscape Area	Quantity Required	Quantity Provided
		4,810 SF	27 Trees	6 Trees*

\*NOTE: INTERIOR VUA LANDSCAPING PROVIDED TO GREATEST EXTENT POSSIBLE DUE TO SITE RESTRICTIONS



CALL DIGGERS HOTLINE  
1-800-242-8511  
TOLL FREE

TO OBTAIN LOCATIONS OF ADJACENT UTILITIES AND FACILITIES BEFORE YOU DIG OR EXCAVATE, REQUIRE MIN. 3 WORK DAYS NOTICE BEFORE YOU EXCAVATE. MILW. AREA 259-1181

THE UNDERGROUND UTILITY INFORMATION SHOWN ON THIS MAP IS BASED ON FIELD MARKINGS AND INFORMATION FURNISHED BY UTILITY COMPANIES AND THE LOCAL MUNICIPALITY. WHILE THIS INFORMATION IS BELIEVED TO BE RELIABLE, ITS ACCURACY AND COMPLETENESS CANNOT BE GUARANTEED.

**THE SIGMA GROUP**  
Single Source. Sound Solutions.  
www.thesigmagroup.com  
1300 West Canal Street  
Milwaukee, WI 53233  
Phone: 414-643-4200  
Fax: 414-643-4210

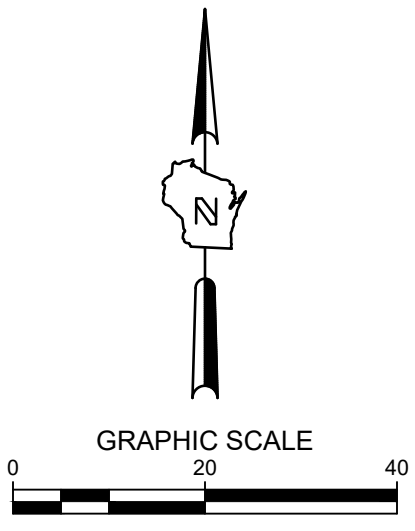

**WAUWATOSA GROCERY**  
**7501 W. NORTH AVENUE**  
**WAUWATOSA, WI**

LANDSCAPE PLAN

**PRELIMINARY**  
**NOT FOR**  
**CONSTRUCTION**

ISSUANCE	DATE
CONDITIONAL USE SUBMITTAL	05/20/2026
NO. REVISION	DATE

PROJECT NO:	25057
DESIGN DATE:	----
PLOT DATE:	2026.05.20
DRAWN BY:	AJR
CHECKED BY:	PJI
APPROVED BY:	----
SHEET NO:	L100

**PRELIMINARY  
 NOT FOR  
 CONSTRUCTION**

ISSUANCE DATE  
 CONDITIONAL USE SUBMITTAL 05/20/2026

NO. REVISION DATE

PROJECT NO: 25057  
 DESIGN DATE: ---  
 PLOT DATE: 2026.05.20  
 DRAWN BY: AJR  
 CHECKED BY: PJI  
 APPROVED BY: ---  
 SHEET NO:

**L200**

- NOTES:
1. PLANT EACH TREE SUCH THAT THE ROOT FLARE IS VISIBLE AT THE TOP OF THE ROOT BALL. DO NOT COVER THE TOP OF THE ROOT BALL WITH SOIL.
  2. DEPTH OF THE PLANTING HOLE SHOULD BE DETERMINED AND DUG AFTER THE ROOT FLARE IS LOCATED. PLANTING HOLE MUST BE NO DEEPER THAN THE HEIGHT OF THE ROOT BALL.
  3. IF PLANT IS SHIPPED WITH A WIRE BASKET AROUND THE ROOT BALL, CUT AND REMOVE THE WIRE BASKET ENTIRELY. REMOVE ALL TWINE, ROPE, AND BURLAP COMPLETELY FROM ALL ROOT BALLS.
  4. PLACE ROOT BALL ON UNEXCAVATED OR TAMPED SOIL.
  5. DO NOT PLACE MULCH IN CONTACT WITH STEMS.
  6. WATER ALL PLANTS WITHIN 2 HOURS OF INSTALLATION.
  7. PRUNE ONLY AS NECESSARY TO REMOVE UNHEALTHY BRANCHES. DO NOT REMOVE MORE THAN 1/3 OF THE ORIGINAL PLANT MASS.

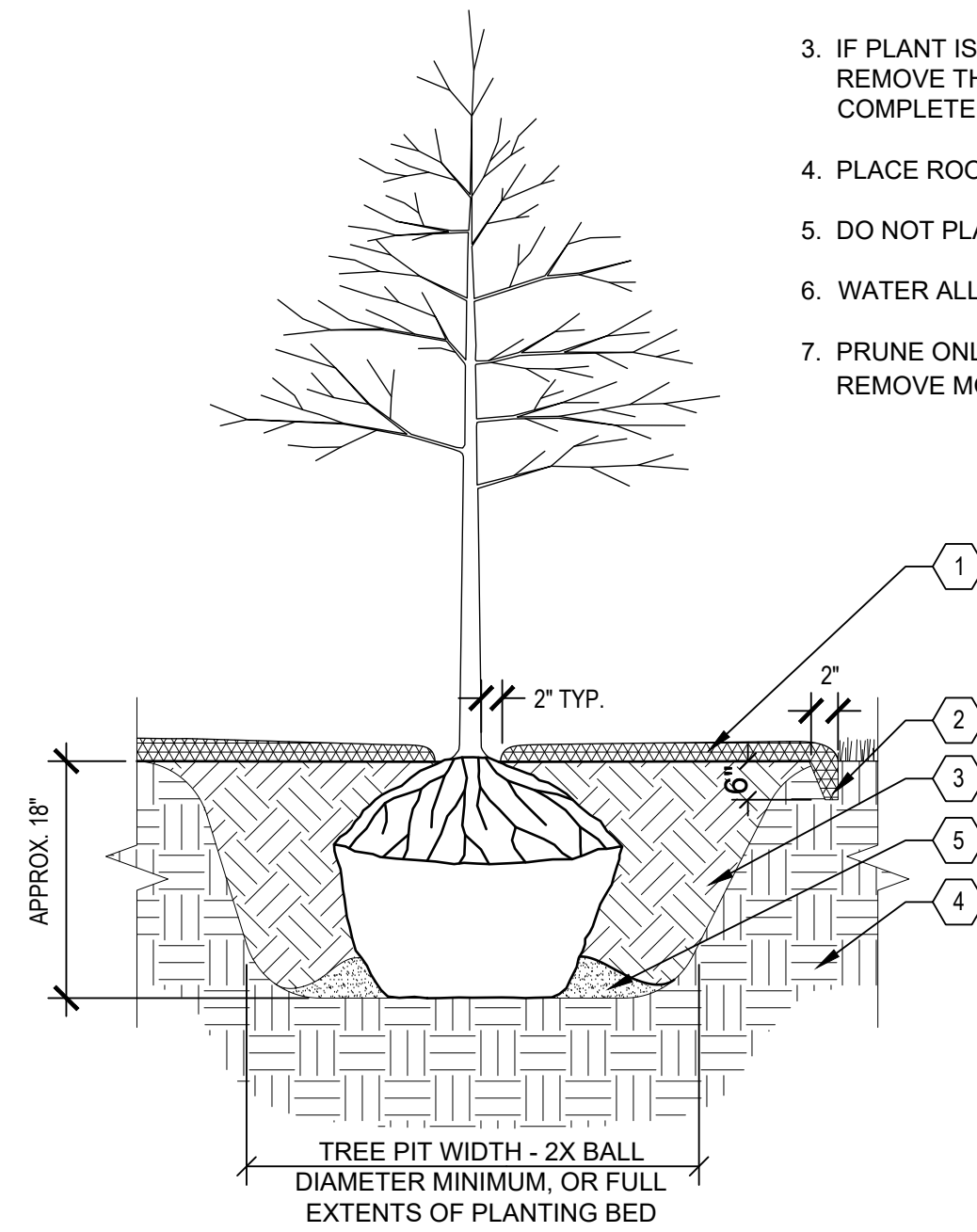

**KEYED LEGEND**

- 1 3" DEPTH SHREDDED HARDWOOD BARK MULCH. PROVIDE 4'-0" DIAMETER MULCH RINGS AT THE BASE OF ANY TREES PLANTED IN LAWN.
- 2 PROVIDE SPADED EDGE, 2" WIDE, 6" DEEP FOR ENTIRE PERIMETER OF BARK MULCH RINGS AT BASE OF TREES PLANTED IN LAWNS
- 3 PLANTING SOIL. PLANTING SOIL SHALL BE PLACED IN ONE CONTINUOUS VOLUME FOR THE ENTIRE AREA OF ANY GIVEN PLANT BED.
- 4 PREPARED SUBGRADE
- 5 TAMP SOIL AROUND BALL BASE FIRMLY WITH FOOT PRESSURE SO THAT BALL DOES NOT SHIFT

- NOTES:
1. MAKE 1" TO 2" DEEP VERTICAL CUTS EVERY 6" AROUND THE CIRCUMFERENCE OF THE ROOT BALL BEFORE PLANTING TO LOOSEN POT-BOUND ROOTS.
  2. PLANT EACH SHRUB SUCH THAT THE ROOT FLARE IS VISIBLE AT THE TOP OF THE ROOT BALL. DO NOT COVER THE TOP OF THE ROOT BALL WITH SOIL.
  3. PLANTING HOLE MUST NOT BE DEEPER THAN THE HEIGHT OF THE ROOT BALL.
  4. DO NOT PLACE MULCH IN CONTACT WITH STEMS.
  5. PLACE ROOT BALL ON UNEXCAVATED OR TAMPED SOIL.
  6. WATER ALL PLANTS WITHIN 2 HOURS OF INSTALLATION.
  7. PRUNE ONLY AS NECESSARY TO REMOVE UNHEALTHY BRANCHES. DO NOT REMOVE MORE THAN 1/3 OF THE ORIGINAL PLANT MASS.
  8. SEGREGATE ANY SOIL FROM BELOW WARNING LAYER EXCAVATED DURING PLANTING FOR OFF-SITE DISPOSAL. COORDINATE DISPOSAL WITH ENVIRONMENTAL CONSULTANT.
  9. FOR SHRUBS PLANTED WITHIN PLANTING BEDS, CONTRACTOR SHALL PROVIDE PLANTING SOIL CONTINUOUSLY FOR THE ENTIRE PLANTING BED AND INDIVIDUAL SHRUBS SHALL BE PLANTED INTO THE PREPARED PLANTING SOIL. MULCH SURFACE FOR PLANTING BEDS SHALL ALSO BE CONTINUOUS ACROSS THE ENTIRE SURFACE AND HELD 1/2" MIN. TO 1" MAX. BELOW ADJACENT PAVEMENTS.

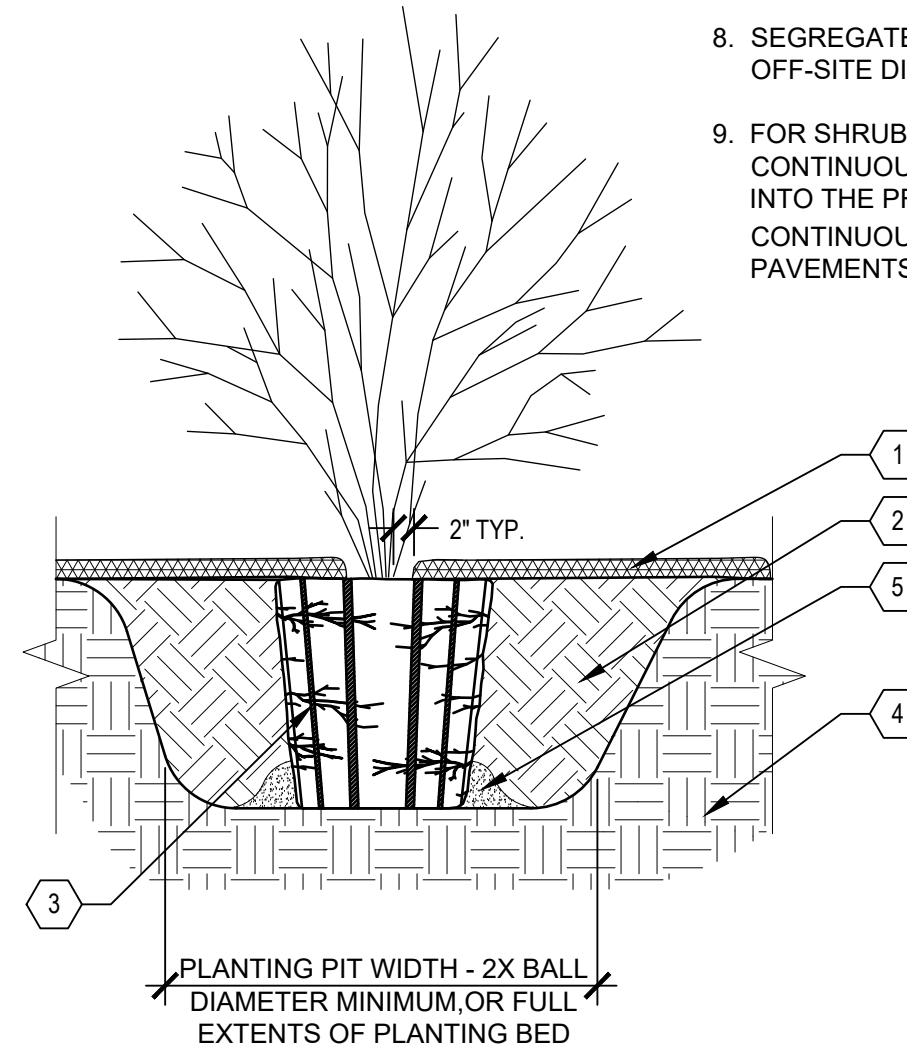

**KEYED LEGEND**

- 1 3" DEPTH TWICE-SHREDDED HARDWOOD BARK MULCH, UNLESS OTHERWISE INDICATED, KEEP 2" CLEAR OF STEMS
- 2 PLANTING SOIL AS SPECIFIED, PLANTING SOIL SHALL BE PLACED IN ONE CONTINUOUS VOLUME FOR THE ENTIRE AREA OF ANY GIVEN PLANT BED
- 3 1" TO 2" DEEP VERTICAL CUTS EVERY 6" AROUND PERIMETER
- 4 PREPARED SUBGRADE
- 5 TAMP SOIL AROUND BALL BASE FIRMLY WITH FOOT PRESSURE SO THAT BALL DOES NOT SHIFT

**A** TYPICAL TREE PLANTING  
 SCALE: N.T.S.

**B** TYPICAL SHRUB PLANTING  
 SCALE: N.T.S.

- NOTES:
1. DO NOT COVER THE TOP OF THE ROOT BALL WITH SOIL.
  2. PLANTING HOLE MUST NOT BE DEEPER THAN THE HEIGHT OF THE ROOT BALL.
  3. DO NOT PLACE MULCH IN CONTACT WITH STEMS.
  4. WATER ALL PLANTS THOROUGHLY WITHIN 2 HOURS OF INSTALLATION.
  5. PRUNE ONLY AS NECESSARY TO REMOVE UNHEALTHY OR DEAD PLANT PARTS. DO NOT REMOVE MORE THAN 1/3 OF THE ORIGINAL PLANT MASS.
  6. FOR PLANTS PLANTED WITHIN PLANTING BEDS, CONTRACTOR SHALL PROVIDE PLANTING SOIL CONTINUOUSLY FOR THE ENTIRE PLANTING BED AND INDIVIDUAL SHRUBS SHALL BE PLANTED INTO THE PREPARED PLANTING SOIL. MULCH SURFACE FOR PLANTING BEDS SHALL ALSO BE CONTINUOUS ACROSS THE ENTIRE SURFACE AND HELD 1/2" MIN. TO 1" MAX. BELOW ADJACENT PAVEMENTS.

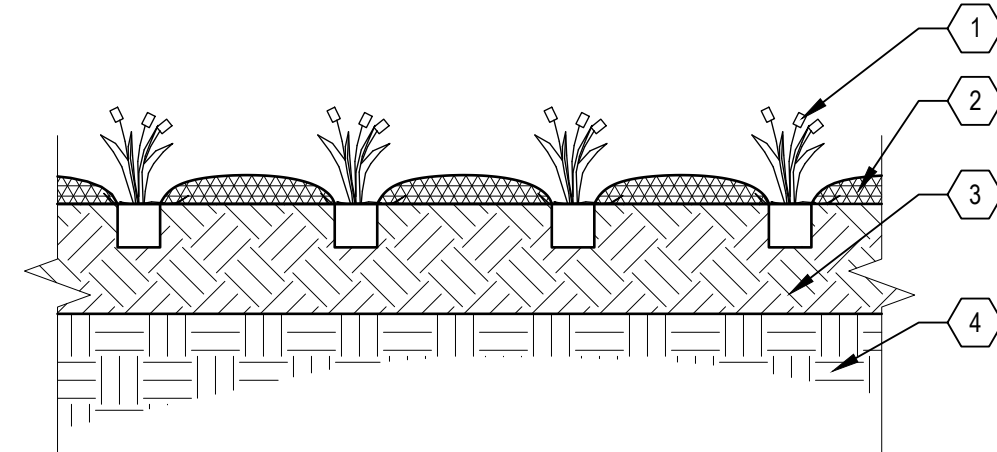

**KEYED LEGEND**

- 1 PERENNIAL, ORNAMENTAL GRASS, OR GROUND COVER PLUG. SEE LANDSCAPE PLAN SHEETS L100-L103
- 2 3" DEPTH TWICE-SHREDDED HARDWOOD BARK MULCH, UNLESS OTHERWISE INDICATED, KEEP 3" CLEAR OF STEMS
- 3 PLANTING SOIL. PLANTING SOIL SHALL BE PLACED IN ONE CONTINUOUS VOLUME FOR THE ENTIRE AREA OF ANY GIVEN PLANT BED
- 4 PREPARED SUBGRADE

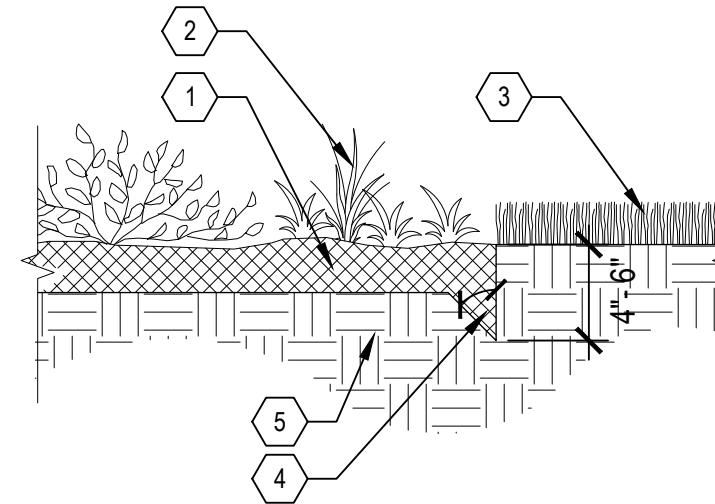

**KEYED LEGEND**

- 1 3" DEPTH OF MULCH LAYER
- 2 SHRUB PLANTING BED
- 3 LAWN ADJACENT TO PLANTING BED
- 4 45 DEGREE ANGLE SHOVEL CUT EDGE TOWARD PLANTING BED
- 5 COMPACTED SUBGRADE

**D** SHOVEL CUT PLANT EDGE  
 SCALE: N.T.S.

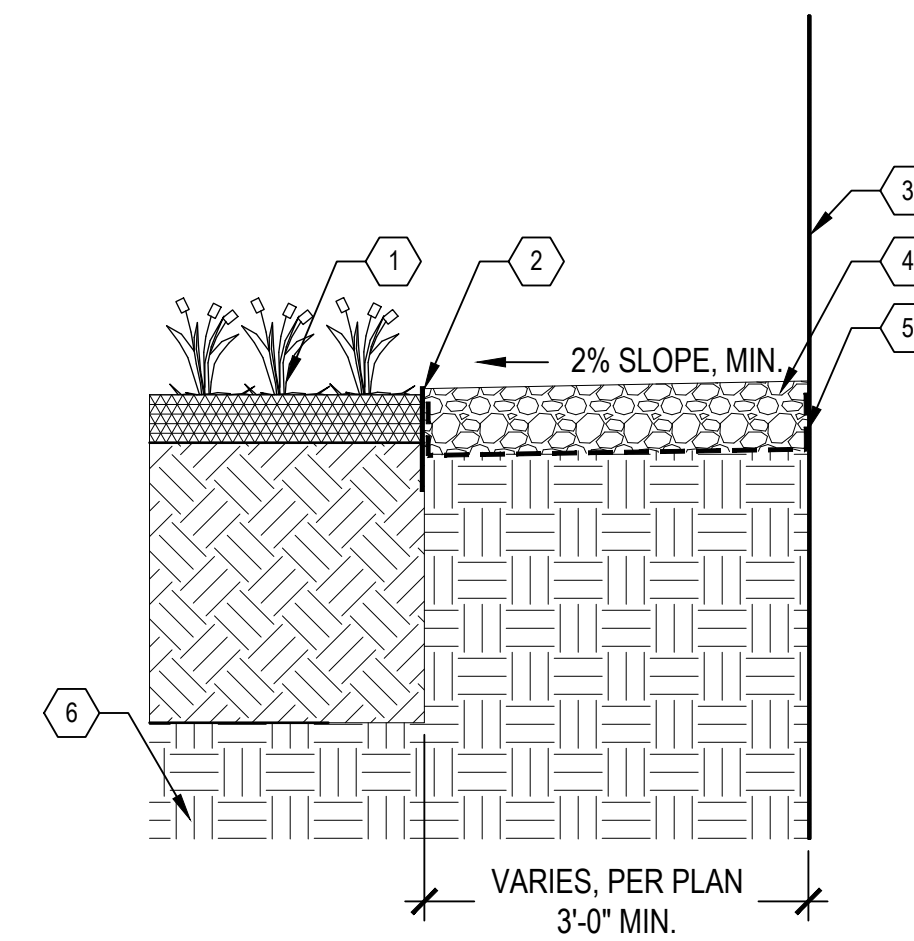

**KEYED LEGEND**

- 1 ADJACENT PLANTING BED
- 2 BLACK ANODIZED ALUMINUM EDGING
- 3 BUILDING FACE
- 4 3" DEPTH STONE MULCH
- 5 WOVEN GEOTEXTILE FILTER FABRIC, WRAP UP SIDES OF BUILDING AND EDGING
- 6 PREPARED SUBGRADE

**E** STONE MAINTENANCE EDGE  
 SCALE: N.T.S.

**C** TYPICAL PERENNIAL & ORNAMENTAL GRASS PLANTING  
 SCALE: N.T.S.

**KEYED LEGEND**

- 1 BIOFILTRATION BASIN PERENNIAL PLUGS (SEE PERENNIAL PLUGS PLANT LIST)
- 2 STRAW MULCH

PERENNIAL PLUG SPACING  
1 PLUG PER 2.25 SQUARE FEET  
(18" SPACING O.C.)  
PLANT IN CLUSTERS OF 5-12 PLANTS PER SPECIES

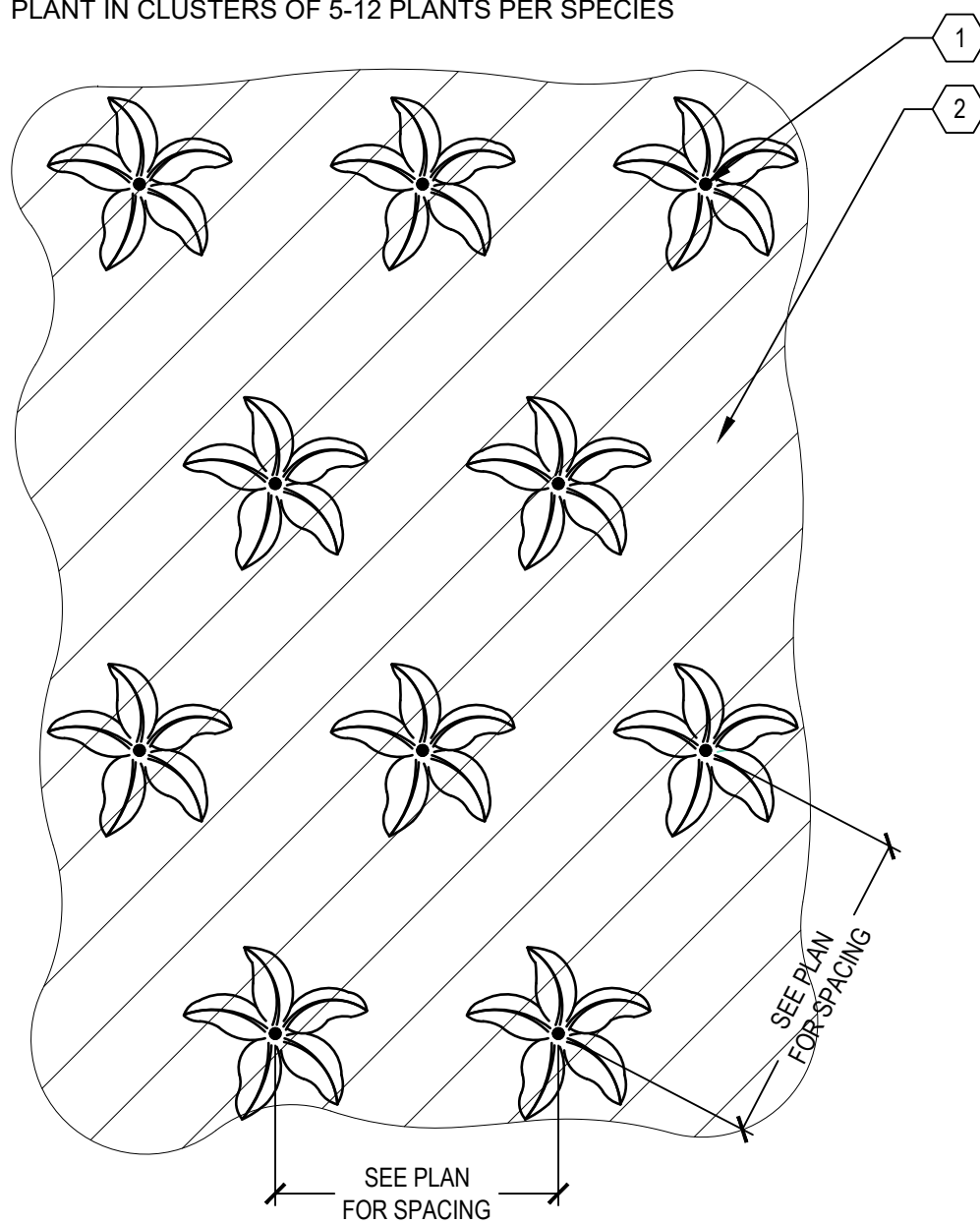

PLAN VIEW

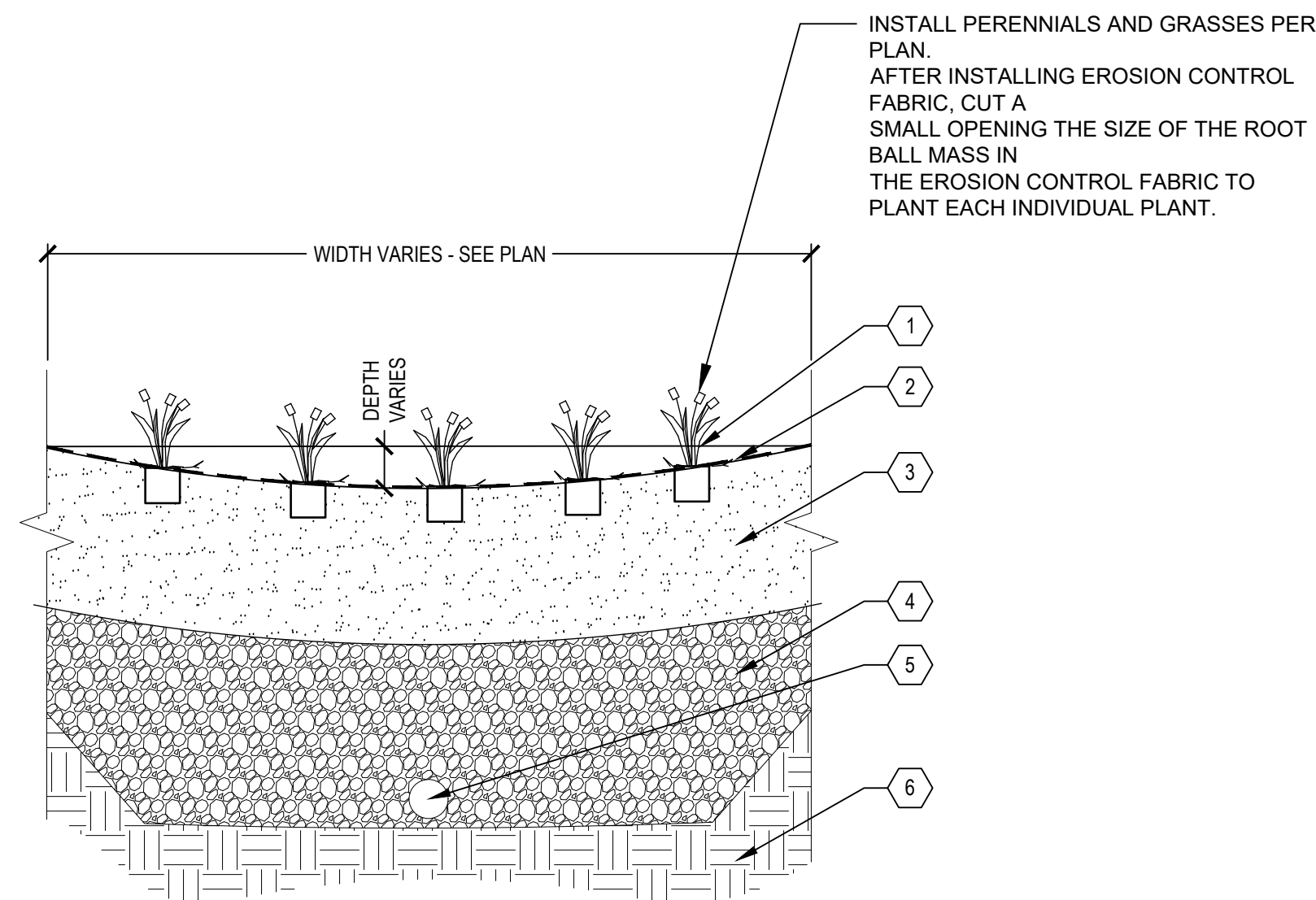

SECTION VIEW

**KEYED LEGEND**

- 1 BIOFILTRATION BASIN PLANTING (SEE PERENNIAL PLUGS PLANT LIST)
- 2 BIODEGRADABLE EROSION CONTROL MATTING ON BOTTOM AND SLOPES OF BASIN
- 3 ENGINEERED SOIL MIX - SEE CIVIL FOR DEPTH
- 4 STONE STORAGE LAYER - SEE CIVIL FOR DEPTH
- 5 PVC DRAIN TILE, SEE CIVIL PLAN.
- 6 PREPARED SUBGRADE

**A BIOFILTRATION PLUG PLANTING**  
SCALE: N.T.S.

Botanical Name	Common Name	Quantity	Size	Comments	%	Total Quantity	Total Trays	Total Plants
<i>Asclepias incarnata</i>	Marsh Milkweed	32.00	Round Tapered Plug	18" O.C. in clusters of 5-12 plants per species	4%	6	0.19	32.00
<i>Aster Novae-angliae</i>	New England Aster	32.00	Round Tapered Plug	18" O.C. in clusters of 5-12 plants per species	6%	9	0.28	32.00
<i>Carex stipitata</i>	Common Fox Sedge	32.00	Round Tapered Plug	18" O.C. in clusters of 5-12 plants per species	4%	6	0.19	32.00
<i>Carex vulpinoidea</i>	Brown Fox Sedge	32.00	Round Tapered Plug	18" O.C. in clusters of 5-12 plants per species	6%	9	0.28	32.00
<i>Eupatorium maculatum</i>	Spotted Joe Pye Weed	32.00	Round Tapered Plug	18" O.C. in clusters of 5-12 plants per species	6%	9	0.28	32.00
<i>Helenium autumnale</i>	Sneezeweed	32.00	Round Tapered Plug	18" O.C. in clusters of 5-12 plants per species	6%	9	0.28	32.00
<i>Liatris spicata</i>	Marsh Blazingstar	32.00	Round Tapered Plug	18" O.C. in clusters of 5-12 plants per species	6%	9	0.28	32.00
<i>Lobelia cardinalis</i>	Cardinal Flower	32.00	Round Tapered Plug	18" O.C. in clusters of 5-12 plants per species	6%	9	0.28	32.00
<i>Monarda fistulosa</i>	Wild Bergamot	32.00	Round Tapered Plug	18" O.C. in clusters of 5-12 plants per species	6%	9	0.28	32.00
<i>Panicum virgatum</i>	Switchgrass	32.00	Round Tapered Plug	18" O.C. in clusters of 5-12 plants per species	6%	9	0.28	32.00
<i>Ratibida pinnata</i>	Yellow Coneflower	32.00	Round Tapered Plug	18" O.C. in clusters of 5-12 plants per species	6%	9	0.28	32.00
<i>Rudbeckia hirta</i>	Black-Eyed Susan	32.00	Round Tapered Plug	18" O.C. in clusters of 5-12 plants per species	6%	9	0.28	32.00
<i>Scirpus atrovirens</i>	Dark-Green Bulrush	32.00	Round Tapered Plug	18" O.C. in clusters of 5-12 plants per species	6%	9	0.28	32.00
<i>Scirpus cyperinus</i>	Wool Grass	32.00	Round Tapered Plug	18" O.C. in clusters of 5-12 plants per species	6%	9	0.28	32.00
<i>Spartina pectinata</i>	Prairie Cordgrass	32.00	Round Tapered Plug	18" O.C. in clusters of 5-12 plants per species	6%	9	0.28	32.00
<i>Tradescantia ohioensis</i>	Ohio Spiderwort	32.00	Round Tapered Plug	18" O.C. in clusters of 5-12 plants per species	6%	9	0.28	32.00
<i>Verbena hastata</i>	Blue Vervain	32.00	Round Tapered Plug	18" O.C. in clusters of 5-12 plants per species	4%	6	0.19	32.00
<i>Vernonia fasciculata</i>	Ironweed	32.00	Round Tapered Plug	18" O.C. in clusters of 5-12 plants per species	4%	6	0.19	32.00
					100%	150		

**C BIOINFILTRATION PLANTING PLUGS LIST**  
SCALE: N.T.S.

Botanical Name	Common Name	PLS Ounces/Acre
<b>Wildflower Forbs:</b>		
<i>Asclepias incarnata</i>	Marsh (Red) Milkweed	3.00
<i>Aster ericoides</i>	Heath Aster	0.10
<i>Aster novae-angliae</i>	New England Aster	1.50
<i>Baptisia leucantha (alba)</i>	White Wild Indigo	4.00
<i>Eupatorium maculatum</i>	Spotted Joe Pye Weed	0.80
<i>Eupatorium perfoliatum</i>	Boneset	0.50
<i>Liatris pycnostachya</i>	Prairie Blazing Star	2.50
<i>Liatris spicata</i>	Marsh Blazing Star	5.00
<i>Lobelia cardinalis</i>	Cardinal Flower	0.25
<i>Lobelia siphilitica</i>	Great Blue Lobelia	0.50
<i>Monarda fistulosa</i>	Wild Bergamot	1.50
<i>Physostegia virginiana</i>	Obedient Plant	1.50
<i>Pycnanthemum virginianum</i>	Mountain Mint	0.30
<i>Ratibida pinnata</i>	Yellow Coneflower	2.25
<i>Rudbeckia hirta</i>	Black-Eyed Susan	2.00
<i>Rudbeckia subtomentosa</i>	Sweet Black-Eyed Susan	2.00
<i>Solidago ohioensis</i>	Ohio Goldenrod	0.50
<i>Tradescantia ohioensis</i>	Ohio Spiderwort	1.25
<i>Verbena hastata</i>	Blue Vervain	1.00
<i>Vernonia fasciculata</i>	Ironweed	1.00
	Totals =	31.45
<b>Perennial Grasses, Sedges &amp; Rushes:</b>		
<i>Bromus ciliatus</i>	Fringed Brome	20.00
<i>Calamagrostis canadensis</i>	Blue Joint Grass	1.00
<i>Carex bebbii</i>	Bebb's Oval Sedge	2.00
<i>Carex crawfordii</i>	Crawford's Sedge	1.00
<i>Carex crinita</i>	Fringed Sedge	0.75
<i>Carex stipitata</i>	Common Fox Sedge	1.50
<i>Carex vulpinoidea</i>	Brown Fox Sedge	1.00
<i>Elymus canadensis</i>	Canada Wild Rye	24.00
<i>Elymus virginicus</i>	Virginia Wild Rye	32.00
<i>Glyceria grandis</i>	Reed Manna Grass	1.00
<i>Panicum virgatum</i>	Switchgrass	3.50
<i>Scirpus atrovirens</i>	Dark-Green Bulrush	0.50
<i>Scirpus cyperinus</i>	Wool Grass	0.30
<i>Sorghastrum nutans</i>	Indian Grass	5.00
<i>Spartina pectinata</i>	Prairie Cordgrass	3.00
	Totals =	96.55

**B RAINWATER RENEWAL NATIVE SEED MIX**  
SCALE: N.T.S.

WAUWATOSA GROCERY  
7501 W. NORTH AVENUE  
WAUWATOSA, WI  
LANDSCAPE DETAILS

PRELIMINARY  
NOT FOR  
CONSTRUCTION

ISSUANCE DATE  
CONDITIONAL USE SUBMITTAL 05/20/2026

NO. REVISION DATE

PROJECT NO: 25057  
DESIGN DATE: ---  
PLOT DATE: 2026.05.20  
DRAWN BY: AJR  
CHECKED BY: PJI  
APPROVED BY: ---

SHEET NO:  
**L201**

PLANTING QUALITY ASSURANCE

- 1. PLANTS ARE TO BE INSPECTED UPON DELIVERY TO PROJECT SITE AND THE LANDSCAPE ARCHITECT OR OWNER'S PROJECT REPRESENTATIVE MAY REJECT ANY SPECIMENS NO LONGER MEETING THE SPECIFIED STANDARDS OR THAT HAVE BEEN DAMAGED IN TRANSIT.
2. ALL PLANT MATERIAL SHALL BE TRUE TO SPECIES AND VARIETY/HYBRID/CULTIVAR SPECIFIED, AND NURSERY GROWN IN ACCORDANCE WITH GOOD HORTICULTURAL PRACTICES.
3. TREES:
3.1. SHALL BE TRAINED IN DEVELOPMENT AND APPEARANCE AS TO BE SUPERIOR IN FORM, COMPACTNESS AND SYMMETRY.
3.2. WITH A DAMAGED, CUT OR CROOKED LEADER, ABRASION OF BARK, SUNSCALD, FROST CRACK, DISFIGURING KNOTS, INSECTS (INCLUDING EGGS AND LARVAE) OR INSECT DAMAGE.
3.3. SHALL HAVE HEALTHY, WELL-DEVELOPED ROOT SYSTEMS, AND BE FREE FROM PHYSICAL DAMAGE OR OTHER HINDRANCES TO HEALTHY GROWTH.
3.4. BALLED AND BURLAPPED PLANTS SHALL BE DUG WITH SOLID BALLS OF A DIAMETER NOT LESS THAN THAT RECOMMENDED BY THE AMERICAN STANDARDS FOR NURSERY STOCK.
4. PLANTS SHALL CONFORM TO THE MEASUREMENTS SPECIFIED WITHIN THE PLANT SCHEDULE.

PLANTING PROJECT CONDITIONS:

- 1. VERIFY SERVICE AND UTILITY LOCATIONS, AND DIMENSIONS OF CONSTRUCTION CONTIGUOUS WITH NEW PLANTINGS BY FIELD MEASUREMENTS BEFORE PROCEEDING WITH PLANTING WORK.
2. INTERRUPTION OF EXISTING SERVICES OR UTILITIES; DO NOT INTERRUPT SERVICES OR UTILITIES UNLESS PERMITTED UNDER THE FOLLOWING CONDITIONS AND THEN ONLY AFTER ARRANGING TO PROVIDE TEMPORARY SERVICES OR UTILITIES ACCORDING TO REQUIREMENTS INDICATED:
2.1. NOTIFY OWNER'S PROJECT REPRESENTATIVE NO FEWER THAN TWO DAYS IN ADVANCE OF PROPOSED INTERRUPTION OF EACH SERVICE OR UTILITY.
2.2. DO NOT PROCEED WITH INTERRUPTION OF SERVICES OR UTILITIES WITHOUT REPRESENTATIVE'S WRITTEN PERMISSION.
3. PLANTING RESTRICTIONS: PLANTING SHALL OCCUR DURING THE FOLLOWING ACCEPTABLE INSTALLATION PERIODS:
3.1. DECIDUOUS TREES AND SHRUBS - APRIL 15 TO OCTOBER 15.
3.2. NATIVE SEEDING AND TURFGRASS: APRIL 15 - OCTOBER 15
4. WEATHER LIMITATIONS: PROCEED WITH PLANTING ONLY WHEN EXISTING AND FORECASTED WEATHER CONDITIONS PERMIT PLANTING TO BE PERFORMED WHEN BENEFICIAL AND OPTIMUM RESULTS MAY BE OBTAINED.
5. CONTRACTOR SHALL PROTECT ALL EXISTING AND/OR NEWLY INSTALLED PLANTS, LAWNS, AND GRASS AREAS FROM DAMAGE AT ALL TIMES.
6. EXAMINE AREAS TO RECEIVE PLANTS FOR COMPLIANCE WITH REQUIREMENTS AND CONDITIONS AFFECTING INSTALLATION AND PERFORMANCE.
6.1. VERIFY THAT NO FOREIGN OR DELETERIOUS MATERIAL OR LIQUID SUCH AS PAINT, PAINT WASHOUT, CONCRETE DRYING, WIND BURN, SWEATING, WHIPPING, AND OTHER HANDLING AND TYING DAMAGE.
6.2. DO NOT MIX OR PLACE SOILS IN FROZEN, WET, OR MUDDY CONDITIONS.

PLANTING DELIVERY, STORAGE, & HANDLING:

- 1. BULK MATERIALS;
1.1. DO NOT DUMP OR STORE BULK MATERIALS NEAR STRUCTURES, UTILITIES, WALKWAYS AND PAVEMENTS, OR ON EXISTING TURF AREAS OR PLANTS.
2. DO NOT PRUNE TREES AND SHRUBS BEFORE DELIVERY. PROTECT BARK, BRANCHES, AND ROOT SYSTEMS FROM BURNING, WIND BURN, SWEATING, WHIPPING, AND OTHER HANDLING AND TYING DAMAGE.
3. HANDLE PLANTING STOCK BY ROOT BALL.
4. DELIVER PLANTS AFTER PREPARATIONS FOR PLANTING HAVE BEEN COMPLETED AND INSTALL IMMEDIATELY.
4.1. SET BALLED STOCK ON GROUND AND COVER BALL WITH SOIL, PEAT MOSS, SAWDUST, OR OTHER ACCEPTABLE MATERIAL.
4.2. WATER ROOT SYSTEMS OF PLANTS STORED ON-SITE DEEPLY AND THOROUGHLY WITH A FINE-MIST SPRAY.
5. EXCAVATION FOR TREES & SHRUBS
5.1. EXCAVATE CIRCULAR PLANTING PITS AS INDICATED IN DRAWINGS.
5.2. SUBSOIL AND TOPSOIL REMOVED FROM EXCAVATIONS MAY BE USED AS PLANTING SOIL IF THEY CONFORM TO THE REQUIREMENTS LISTED IN THESE SPECIFICATIONS.
5.3. NOTIFY OWNER'S PROJECT REPRESENTATIVE IF UNEXPECTED ROCK OR OBSTRUCTIONS DETRIMENTAL TO TREES OR SHRUBS ARE ENCOUNTERED IN EXCAVATIONS.
5.4. NOTIFY OWNER'S PROJECT REPRESENTATIVE IF SUBSOIL CONDITIONS EVIDENCE UNEXPECTED WATER SEEPAGE OR RETENTION IN TREE OR SHRUB PLANTING PITS.

EXCAVATION FOR TREES & SHRUBS

- 1. EXCAVATE CIRCULAR PLANTING PITS AS INDICATED IN DRAWINGS. TRIM PERIMETER OF BOTTOM LEAVING CENTER AREA OF BOTTOM RAISED SLIGHTLY TO SUPPORT ROOT BALL AND ASSIST IN DRAINAGE AWAY FROM CENTER.
1.1. EXCAVATE APPROXIMATELY THREE TIMES AS WIDE AS BALL DIAMETER FOR BALLED AND BURLAPPED STOCK.
1.2. DO NOT EXCAVATE DEEPER THAN DEPTH OF THE ROOT BALL, MEASURED FROM THE ROOT FLARE TO THE BOTTOM OF THE ROOT BALL.
1.3. IF AREA UNDER THE PLANT WAS INITIALLY DUG TOO DEEP, ADD SOIL TO RAISE IT TO CORRECT LEVEL AND THOROUGHLY TAMP THE ADDED SOIL TO PREVENT SETTLING.
1.4. MAINTAIN REQUIRED ANGLES OF REPOSE OF ADJACENT MATERIALS AS SHOWN IN DRAWINGS.
1.5. MAINTAIN SUPERVISION OF EXCAVATIONS DURING WORKING HOURS.
1.6. KEEP EXCAVATIONS COVERED OR OTHERWISE PROTECTED WHEN UNATTENDED BY INSTALLER'S PERSONNEL.
2. SUBSOIL AND TOPSOIL REMOVED FROM EXCAVATIONS MAY BE USED AS PLANTING SOIL IF THEY CONFORM TO THE REQUIREMENTS LISTED IN THESE SPECIFICATIONS.
3. NOTIFY OWNER'S PROJECT REPRESENTATIVE IF UNEXPECTED ROCK OR OBSTRUCTIONS DETRIMENTAL TO TREES OR SHRUBS ARE ENCOUNTERED IN EXCAVATIONS.
4. NOTIFY OWNER'S PROJECT REPRESENTATIVE IF SUBSOIL CONDITIONS EVIDENCE UNEXPECTED WATER SEEPAGE OR RETENTION IN TREE OR SHRUB PLANTING PITS.

TREE & SHRUB PLANTING

- 1. BEFORE PLANTING VERIFY THAT ROOT FLARE IS VISIBLE AT TOP OF ROOT BALL.
2. PLANTS FOUND TO HAVE STEM GIRDLING ROOTS AND/OR KINKED ROOTS AT THE TIME OF PLANTING WILL BE REJECTED AND REPLACEMENTS SHALL BE PROVIDED AT NO ADDITIONAL COST TO THE OWNER.
3. REMOVE ALL TWINE, STRING, WIRE, AND ALL OTHER NON-BIODEGRADABLE MATERIAL ENTIRELY FROM ROOT BALL AREA.
4. REMOVE ONLY DEAD, DYING, OR BROKEN BRANCHES. DO NOT PRUNE FOR SHAPE.
5. SET BALLED AND BURLAPPED STOCK PLUMB AND IN CENTER OF PLANTING PIT OR TRENCH WITH ROOT FLARE 2 INCHES ABOVE ADJACENT FINISH GRADES.
5.1. USE SOIL MATERIALS FROM EXCAVATION FOR BACKFILL.
5.2. CAREFULLY CUT AND REMOVE BURLAP, ROPE, AND WIRE BASKETS FROM THE ENTIRE ROOT BALL.
5.3. BACKFILL AROUND ROOT BALL IN LAYERS, TAMPING TO SETTLE SOIL AND ELIMINATE VOIDS AND AIR POCKETS.
5.4. CONTINUE BACKFILLING PROCESS.
6. FURNISH TREES WITH ROOT BALLS MEASURED FROM TOP OF ROOT BALL.
7. SELECT STOCK FOR UNIFORM HEIGHT AND SPREAD.

TREE & SHRUB MATERIAL:

- 1. GENERAL: FURNISH NURSERY-GROWN PLANTS TRUE TO GENUS, SPECIES, VARIETY, CULTIVAR, STEM FORM, SHEARING, AND OTHER FEATURES INDICATED IN PLANT SCHEDULE.
1.1. TREES WITH DAMAGED, CROOKED, OR MULTIPLE LEADERS; TIGHT VERTICAL BRANCHES WHERE BARK IS SQUEEZED BETWEEN TWO BRANCHES OR BETWEEN BRANCH AND TRUNK.
1.2. COLLECTED STOCK: DO NOT USE PLANTS HARVESTED FROM THE WILD.
1.3. PLANT MATERIAL SHALL BE PROVIDED IN THE CONTAINER TYPE INDICATED IN THE DRAWINGS.
2. FURNISH TREES WITH ROOT BALLS MEASURED FROM TOP OF ROOT BALL.
3. SELECT STOCK FOR UNIFORM HEIGHT AND SPREAD.

PLANTING SOIL:

- PLANTING SOIL SHALL BE PLACED IN ONE CONTINUOUS VOLUME FOR THE WIDTH OF LANDSCAPE AREAS, AND A MINIMUM OF 3X THE DIAMETER OF THE ROOT BALL LENGTHWISE
1. INSTALL PLANTING SOIL FOR PLANT BEDS IN 6" LIFTS, MINIMUM 8" DEPTH.
2. DO NOT APPLY PLANTING SOIL TO SATURATED OR FROZEN SUBGRADES.
3. PLANTING SOIL SHALL BE A MIX OF 6-PARTS TOPSOIL, 1-PART COMPOST.
3.1. THE PROJECT WILL ACCEPT ONLY CLEAN, SALVAGED OR IMPORTED TOPSOIL.
3.2. STRIPPED, SALVAGED, OR MINED TOPSOIL MUST BE TAKEN FROM THE TOP 6-INCHES OF THE A-HORIZON.
4. STANDARD PROFILE, COMMERCIAL-GRADE, EXTRUDED ALUMINUM EDGING.

METAL EDGING

- 1. STANDARD PROFILE, COMMERCIAL-GRADE, EXTRUDED ALUMINUM EDGING.
1.1. BASIS OF DESIGN: CLEANLINE BY PERMALOC OR APPROVED EQUAL.
1.2. EDGING SIZE: 3/16-INCH-WIDE BY 5.5 INCHES DEEP.
1.3. STAKES: ALUMINUM, ASTM 221, ALLOY 6061-T6, 18-INCHES LONG.
1.4. FINISH: BLACK DURAFLEX.
1.5. MANUFACTURERS: SUBJECT TO COMPLIANCE WITH REQUIREMENTS, AVAILABLE MANUFACTURERS OFFERING PRODUCTS THAT MAY BE INCORPORATED INTO THE WORK.
2. INSTALL METAL EDGE IN ACCORDANCE WITH MANUFACTURER'S WRITTEN INSTRUCTIONS.
3. ENSURE THAT METAL EDGING IS PROPERLY INSTALLED AND SECURED BEFORE INSTALLING STONE MULCH.

STONE MULCH MATERIAL & INSTALLATION:

- 1. SHALL BE HARD, DURABLE, STONE, WASHED FREE OF LOAM, SAND, CLAY, AND OTHER FOREIGN SUBSTANCES.
1.1. MATERIAL: ANGULAR WASHED STONE.
1.2. SIZE: 1-1/2" DIAMETER.
1.3. DEPTH: 3" MINIMUM DEPTH PLACED IN ONE LIFT.
1.4. COLOR RANGE: BLEND OF DARK GREY & BLUE TONES.
1.5. BASIS OF DESIGN: 1-1/2" 'AMERICAN HERITAGE' AGGREGATE BY COUNTY MATERIALS.
2. LIGHTLY COMPACT AREAS TO RECEIVE STONE MULCH.
3. INSTALL WEED BARRIER FABRIC IN ACCORDANCE WITH MANUFACTURER'S WRITTEN INSTRUCTIONS.
4. PLACE AND FINISH STONE MULCH AS INDICATED IN DRAWINGS.

BARK MULCH MATERIAL & INSTALLATION

- 1. TWICE-SHREDDED HARDWOOD BARK MULCH TO BE PROVIDED AS TOP-DRESSING FOR ALL AT-GRADE PLANTING BEDS.
1.1. SIZE RANGE: MAXIMUM 2.5" TO 3"
1.2. COLOR: NATURAL, UN-DYED
1.3. PROVIDE 3" DEPTH MULCH FOR ALL PLANTING BEDS.
2. KEEP BARK MULCH 2" CLEAR OF ALL STEMS OF PLANT MATERIAL.

TURF SEEDING:

- 1. DELIVERY:
1.1. DELIVER PACKAGED SEED MATERIALS IN ORIGINAL, UNOPENED CONTAINERS.
2. PROJECT CONDITIONS:
2.1. SEED DURING ONE OF THE FOLLOWING PERIODS.
2.1.1. SPRING SEEDING SEASON: APRIL 1 TO JUNE 15.
2.1.2. FALL SEEDING SEASON: AUGUST 15 TO OCTOBER 1.
3. PRODUCTS
3.0.1. PROVIDE THE FOLLOWING FOR TURFGRASS SEED BASIS OF DESIGN.
3.0.2. TURFGRASS SEED MIX TO BE FERTILIZED WITH 'SCOTT'S STARTER FERTILIZER'.
4. PROCEED WITH INSTALLATION ONLY AFTER SATISFACTORY CONDITIONS HAVE BEEN MET.
5. DO NOT APPLY SEED UNTIL FIVE TO SEVEN DAYS AFTER LAST HERBICIDE TREATMENT.
6. FINISH GRADING: GRADE AREAS TO A SMOOTH, UNIFORM SURFACE PLANE WITH LOOSE, UNIFORMLY FINE TEXTURE.
7. MOISTEN PREPARED AREA BEFORE SEEDING IF SOIL IS DRY.
8. NO SEEDING SHALL OCCUR ON FROZEN GROUND OR AT TEMPERATURES LOWER THAN 32 DEGREES FARENHEIT.
9. SEEDING RATES TO BE PERFORMED IN ACCORDANCE WITH SEED SUPPLIER RECOMMENDATIONS.

NATIVE SEEDING:

- 1. PROVIDE THE FOLLOWING SEED TYPES FROM: AGRECOL LLC 10101 N. CASEY ROAD EVANSVILLE, WISCONSIN 53536:
1.1. AGRECOL'S 'RAINWATER RENEWAL SEED MIX' FOR AREAS SHOWN AS 'RAINWATER RENEWAL NATIVE SEED MIX'
1.2. REFER TO DETAIL B ON SHEET L201, FOR SEED MIX COMPOSITION.
2. REFER TO CIVIL PLANS FOR LOCATIONS AND EXTENTS OF EROSION CONTROL MAT.
3. WITHIN 4 WEEKS FOLLOWING THE ISSUANCE OF THE NOTICE TO PROCEED, SUBMIT NAME AND LOCATION OF SEED SUPPLIER(S) AND A COMPLETE LIST OF EACH SEED MIX BY WEIGHT AND PROPORTION THAT IS BEING SUPPLIED BEFORE THE SEED MIX IS ORDERED.
4. ALL SEED MATERIAL SHALL ORIGINATE FROM LOCAL SOURCES.
5. ALL SEEDING ZONE BOUNDARIES SHALL BE SURVEYED AND STAKED ON THE PROJECT SITE.
6. THE LANDSCAPE ARCHITECT RESERVES THE RIGHT TO ADJUST SEED LIMITS WITHOUT ADJUSTING TOTAL SEEDED AREAS.
7. COORDINATION IS REQUIRED TO ENSURE RAINFALL/GROUNDWATER SEEPAGE DOES NOT RESULT IN SOIL MOISTURE CONDITIONS THAT WILL CAUSE EXCESSIVE RUTTING DURING SEEDING.
8. WHERE SEEDING OCCURS IN CLOSE PROXIMITY TO OTHER SITE IMPROVEMENTS OR AREAS TO REMAIN UNDISTURBED.
9. FOLLOWING NATIVE SEED MIX INSTALLATION, THE LANDSCAPE ARCHITECT AND CONTRACTOR SHALL CONDUCT A SUBSTANTIAL COMPLETION INSPECTION.
10. GENERAL INSTALLATION:
10.1. SEEDING OF NATIVE SEED MIXES SHALL OCCUR IN THE EARLY SPRING.
10.1.1. APRIL 15 THROUGH MAY 31.
10.2. DO NOT SOW SEED DURING ADVERSE WEATHER.
10.3. DO NOT SOW SEED IN AREAS WHERE STANDING WATER IS PRESENT.
11. GRADE PREPARATION:
11.1. SUBGRADE AND FINISH GRADE PREPARATION SHALL BE IN ACCORDANCE WITH SITE EARTHWORK REQUIREMENTS.
11.2. PRIOR TO SEEDING, REPAIR ANY RUTS, RILLS, OR GULLIES GREATER THAN 2 INCHES IN DEPTH.
11.3. IF THE PREPARED GRADE IS ERODED OR COMPACTED BY RAINFALL OR OTHER REASONS.
11.4. IMMEDIATELY BEFORE SEEDING, SCARIFY, LOOSEN, FLOAT, AND DRAG TOPSOIL AS NECESSARY.
11.5. NO FURTHER GRADE PREPARATION IS REQUIRED.
12. IF REQUIRED DUE TO CONSTRUCTION SEQUENCING, SEED THE SITE WITH A TEMPORARY COVER CROP TO HOLD IT FOR SPRING SEEDING AS FOLLOWS:
12.1. IF SEEDED MAY 15 THROUGH SEPTEMBER 1: MIX OF 32 POUNDS PER ACRE OF SEED OATS.
12.2. IF SEEDED SEPTEMBER 1 THROUGH OCTOBER 15: 20 POUNDS PER ACRE WINTER WHEAT.
13. BROADCASTING:
13.1. FOR SPRING SEEDING OF NATIVE SEED, SOW SEED DIRECTLY ONTO BARE GROUND.
13.2. INCREASE THE VOLUME OF THE BROADCASTED SEED MIX BY MIXING IT WITH AN APPROVED CARRIER.
13.2.1. USE HALF OF THE TOTAL SEED QUANTITY AND CROSS THE ENTIRE AREA TO BE SEEDED.
13.2.2. LIGHT SEEDS, AWNED SEEDS, OR BEARDED SEEDS TEND TO RISE TO THE TOP OF THE SPREADER.
13.2.3. RAKE OR DRAG THE SEED INTO THE SOIL.
14. DRILL SEEDER OR DROP SEEDER/SPREADER:
14.1. FOR SPRING DRILL SEEDING, SOW SEED DIRECTLY ONTO BARE GROUND.
14.2. CHECK THE EQUIPMENT FREQUENTLY TO ENSURE THE SEED IS DISPERSING EVENLY.
14.3. IF THE EQUIPMENT IS NOT EQUIPPED WITH A ROLLER, PASS OVER THE SEEDED AREA WITH A ROLLER TO FIRM THE SEED INTO THE SOIL.

- 14.3.1. DO NOT MIX THE NATIVE SEED WITH ANY CARRIER MATERIAL.
14.3.2. EVENLY DISTRIBUTE THE SEED ACROSS THE ENTIRE SITE TO BE SEEDED.
14.4. KEEP THE TOPSOIL MOIST.
15. ALL AREAS OVER WHICH HAULING OPERATIONS HAVE BEEN CONDUCTED SHALL BE KEPT CLEAN ON A DAILY BASIS.
16. UPON COMPLETION OF SEED INSTALLATION, REMOVE FROM THE SITE AND LEGALLY DISPOSE OF ALL TRASH AND DEBRIS.
17. RESTORE ANY EXISTING AREAS DAMAGED BY OPERATIONS UNDER THE CONTRACT.
18. ANY DAMAGE BY THE CONTRACTOR TO ESTABLISHED OR NEWLY SEEDED AREAS NOT WITHIN THE PROJECT SCOPE OF WORK SHALL BE REPAIRED AND RESEEDED AT NO COST TO THE OWNER.

CLEAN-UP AND PROTECTION

- 1. DURING PLANTING, KEEP ADJACENT PAVING AND CONSTRUCTION CLEAN.
2. PROTECT PLANTS FROM DAMAGE DUE TO LANDSCAPE OPERATIONS.
3. AFTER INSTALLATION REMOVE ALL NURSERY TAGS, NURSERY STAKES, TIE TAPE, LABELS, WIRE, STRING, AND OTHER DEBRIS FROM PLANT MATERIAL.

VEGETATION MONITORING AND MANAGEMENT

MANAGEMENT AND MONITORING: THE MANAGEMENT AND MONITORING OF NATIVE PLANTINGS (INCLUDING SEED MIXES, FORBS AND PLUGS) SHOULD BE DIRECTED TOWARD THE GOAL OF CREATING A STABLE, NATIVE PLANT COMMUNITY.
UNDERSIRABLE PLANT CONTROL: OVERALL MANAGEMENT OF VEGETATED AREAS MAY INCLUDE, BUT ARE NOT LIMITED TO: RESEEDING OR REPLANTING DAMAGED OR NON-ACTIVE GROWING AREAS.
SHORT-TERM VEGETATION MANAGEMENT: SHORT-TERM VEGETATION MANAGEMENT (MAINTENANCE PERIOD AFTER SEEDING/PLUG INSTALLATION) OCCURS WHILE THE LANDSCAPE CONTRACTOR OR SPECIALTY SEEDING/RESTORATION CONTRACTOR IS RESPONSIBLE TO THE PROJECT OWNER.

INSPECTIONS SHOULD BE MADE FREQUENTLY DURING THE GROWING SEASON TO PROPERLY DOCUMENT ANY INVASIVE SPECIES, WEEDS, DEHYDRATION, DAMAGE, EROSION, DISEASES, BARE AREAS, AND PESTS. THE NECESSARY REPAIRS, TREATMENTS, SEEDING AND PLANTING SHOULD BE DONE AS SOON AS WEATHER CONDITIONS ARE APPROPRIATE.
LONG TERM VEGETATION MANAGEMENT: LONG-TERM MANAGEMENT (AFTER MAINTENANCE AGREEMENT ENDS) WILL BE THE RESPONSIBILITY OF THE PROJECT OWNER/MANAGEMENT ASSOCIATION.

MOWING FREQUENCIES: MOWING FREQUENCIES WILL DEPEND ON FIELD CONDITIONS. THE NATIVE SEEDLING/GRASS AREAS SHOULD NEVER BE MOWED SHORTER THAN SIX (6) INCHES.
MOWING SHOULD BE DONE THREE (3) TIMES DURING THE ESTABLISHMENT PERIOD:

Table with 4 columns: ACTIVITY, TIMING, SUGGESTED MOWING HEIGHTS, REASON. Rows include First Mowing, Second Mowing, and Third Mowing.

MOWING SHOULD BE DONE THREE (3) TIMES DURING THE ESTABLISHMENT PERIOD:
ACTUAL MOWING TIMES SHOULD BE BASED ON THE GROWTH OF NATURAL GRASSES AND UNDESIRABLE WEEDS.

MOWING SHOULD BE DONE THREE (3) TIMES DURING THE ESTABLISHMENT PERIOD:

Table with 4 columns: ACTIVITY, TIMING, SUGGESTED MOWING HEIGHTS, REASON. Rows include First Mowing, Second Mowing, and Third Mowing.

AFTER THE DESIRED VEGETATION HAS BECOME ESTABLISHED THE FIRST AND SECOND MOWINGS (MAY, AUGUST) MAY NOT BE NECESSARY.

BURNING (IF APPROPRIATE FOR SITE): PRIOR TO BURNING, CONTACT WITH THE LOCAL MUNICIPALITY / FIRE DEPARTMENT IS REQUIRED. SOME MUNICIPALITIES MAY HAVE RESTRICTIONS ON OPEN BURNING.

IF ALLOWED BY LOCAL CODE AND ORDINANCES, ONLY BURN WHEN THE DEAD VEGETATION MATTER CAN SUSTAIN FIRE.



WAWATOSA GROCERY
7501 W. NORTH AVENUE
WAUWATOSA, WI
LANDSCAPE SPECIFICATIONS



Table with 2 columns: ISSUANCE DATE, DATE. Row 1: CONDITIONAL USE SUBMITTAL, 05/20/2026.

Table with 2 columns: NO. REVISION, DATE. Row 1: ---, ---.

Table with 2 columns: PROJECT NO., DESIGN DATE, PLOT DATE, DRAWN BY, CHECKED BY, APPROVED BY, SHEET NO. Values include 25057, 05/20/2026, AJR, PJI, ---, L300.

L300